

PERMIT NO.  
23061



CITY OF NEW BEDFORD

DATE 4/13/01

SEWER AND/OR STORM DRAIN PERMIT

This certifies that permission is granted to

Property Owner Dale M. & Joanne M. Sapel Address 117 Rowe St. New Bedford MA 02740 Tel. 997-2041

to connect a sewer and/or storm drain located at Rowe St. #117 (U.S.) S. SAWYER ST.  
Assessor's Plot 81, Lot 119 to the sewer and/or storm drain in Rowe Street

to be laid in accordance with the conditions in this application and the City of New Bedford ordinances.

TYPE OF USE: ☒ RESIDENTIAL ☐ COMMERCIAL ☐ INDUSTRIAL ☐ OTHER

If applicant other than actual property owner, attach Letter of Authorization from Property Owner.

Name N/A Tel. 330 6PD RECEIVED

Mailing Address DEPT. OF PUBLIC WORKS NEW BEDFORD, MASS

The Bonded Contractor/Drain Layer authorized to perform this work is: Stub at prop. line.

Name KRIBORAK BBS. Address 117 Tel. 1978 09

Type of Pipe Required: PVC SDR 35

PERMIT EXPIRES ONE YEAR AFTER DATE OF ISSUE

- \* Requires separate connections for sewage and storm drain where applicable. Storm water cannot be discharged to a sanitary sewer.
- \* All work must be inspected and approved by a D.P.W. inspector before backfilling.
- \* If this connection is to be part of a private service shared jointly with other building owners, attach copy of Recorded Joint Maintenance Agreement.
- \* Permits can be issued to Industrial and/or Commercial Applicants only upon receipt and approval by the Commissioner of Public Works of required plans and supplemental information.
- \* In addition, a City-issued Industrial User Discharge Permit and/or a Sewer Extension/Connection Permit issued by the Commonwealth of Massachusetts D.E.P. shall be required by the City for Industrial Discharge into the sewer system.

Industrial User Discharge Permit No. --- Date ---

Comm. Mass. Sewer Conn./Ext. Permit No. --- Date ---

A Filing and Inspection Fee of \$ 150.00 plus an Entrance Fee of \$ 294.00 where applicable, must accompany this application.

Bank # Compass Bank Check # 1437 Date: 4/13/01 Receipt # 3957

Other requirements: Inspection Only - Rowe St. Sewer Proj. - Stub at PR. Cost:

30' x 14.70' ft. = \$294.00 plus sewer permit fee of \$150.00 = \$444.00 Total

Contractor must file Health Dept. regarding abandonment of septic system.

Connection made to ☒ Sewer Part of jointly-shared private line ☐ Yes ☒ No  
☐ Storm Drain

Applicant agrees to abide by the above terms, as well as all pertinent ordinances of the City of New Bedford, and such other special rules as the Commissioner of Public Works may deem necessary

Commissioner of Public Works Lawrence D. Worden Signature of Property Owner or Representative Joanne M. Sapel

INSPECTED BY: Perin Scieszka  
DATE: 4/19/01  
COMMENTS: [Inspected by CDM from main to prop. line - Rowe St. sewer project.]

☒ APPROVED ☐ DISAPPROVED

SIGNATURE [Signature]

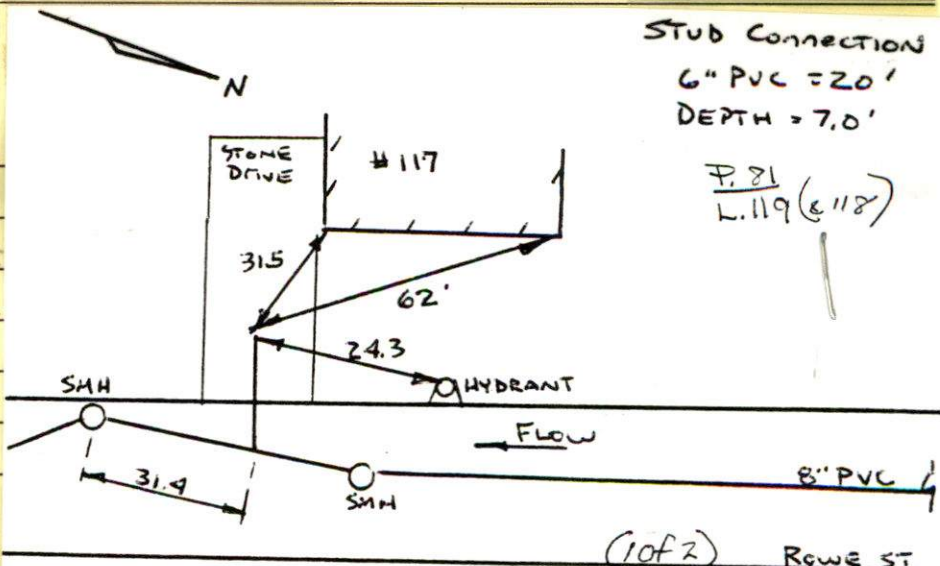

SKETCH PLAN

ROWE ST. (20 of 2)



PERMIT NO.  
23061



CITY OF NEW BEDFORD  
SEWER AND/OR STORM DRAIN PERMIT

DATE 4/3/01

This certifies that permission is granted to  
Dale M. & Joanne M. Sapel 117 Rowe St. New Bedford MA 02740  
Property Owner Address Tel. 997-2041

to connect a sewer and/or storm drain located at Rowe St. #117  
Assessor's Plot 81, Lot 119 (2/118) to the sewer and/or storm drain in Rowe Street

to be laid in accordance with the conditions in this application and the City of New Bedford ordinances.  
TYPE OF USE: ☒ RESIDENTIAL ☐ COMMERCIAL ☐ INDUSTRIAL ☐ OTHER 330 GPD

If applicant other than actual property owner, attach Letter of Authorization from Property Owner.

Name N/A Tel.

Mailing Address

The Bonded Contractor/Drain Layer authorized to perform this work is: Stub at prop. line.

Laborer Bros.  
Name Address Tel.

Type of Pipe Required: PVC SDR 35

PERMIT EXPIRES ONE YEAR AFTER DATE OF ISSUE

- \* Requires separate connections for sewage and storm drain where applicable. Storm water cannot be discharged to a sanitary sewer.
- \* All work must be inspected and approved by a D.P.W. inspector before backfilling.
- \* If this connection is to be part of a private service shared jointly with other building owners, attach copy of Recorded Joint Maintenance Agreement.
- \* Permits can be issued to Industrial and/or Commercial Applicants only upon receipt and approval by the Commissioner of Public Works of required plans and supplemental information.
- \* In addition, a City-issued Industrial User Discharge Permit and/or a Sewer Extension/Connection Permit issued by the Commonwealth of Massachusetts D.E.P. shall be required by the City for Industrial Discharge into the sewer system.

Industrial User Discharge Permit No. Date

Comm. Mass. Sewer Conn./Ext. Permit No. Date

A Filing and Inspection Fee of \$150.00 plus an Entrance Fee of \$294.00 where applicable, must accompany this application.

Bank # Compass Bank Check # 1437 Date: 4/3/01 Receipt # 3957

Other requirements: Inspection Only - Rowe St. Sewer Proj. - Stub at PR. Cost:  
20' x 14.70/ft = \$294.00 plus sewer permit fee of \$150.00 = \$444.00 Total  
Contractor must call Health Dept. regarding abandonment of septic system.

Connection made to ☒ Sewer ☐ Storm Drain Part of jointly-shared private line ☐ Yes ☒ No

Applicant agrees to abide by the above terms, as well as all pertinent ordinances of the City of New Bedford, and such other special rules as the Commissioner of Public Works may deem necessary

Lawrence D. Worden  
Commissioner of Public Works

Joanne M. Sapel  
Signature of Property Owner or Representative

INSPECTOR'S REPORT

INSPECTED BY:

DATE:

COMMENTS:

☐ APPROVED ☐ DISAPPROVED

SIGNATURE

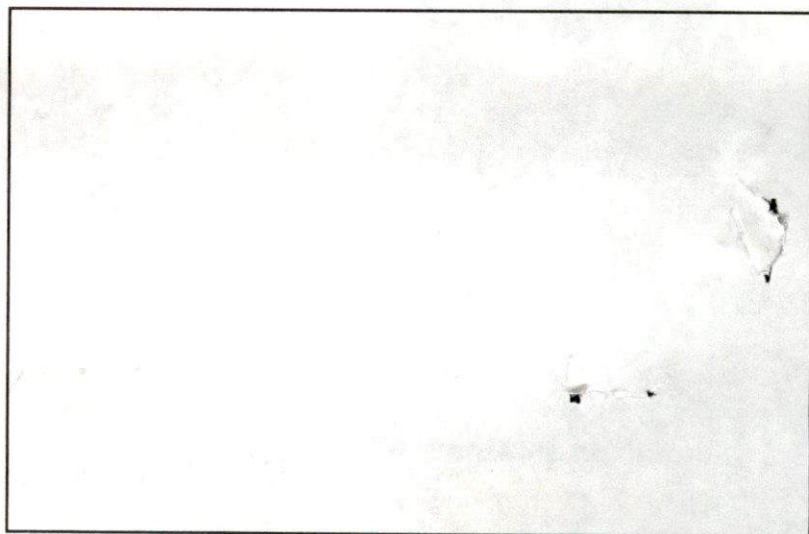

SKETCH PLAN



LAWRENCE D. WORDEN  
COMMISSIONER

**MASSACHUSETTS**  
DEPARTMENT OF PUBLIC WORKS  
ENGINEERING DIVISION  
133 WILLIAM STREET, ROOM 303  
NEW BEDFORD, MA 02740  
Tel: (508) 979-1527  
Fax: (508) 961-3043

*TREASURER'S  
OFFICE*

January 25, 2001

Attn: Dale M. & Joane M. Sopel  
117 Rowe St.  
New Bedford, MA 02740

Re: Rowe Street Sewer Project Area--Properties Located Within Isolated Portions of the Sewer System Which Have Been Approved and Are Presently Operational

This letter serves as notification to you that the following property may now connect to the sewer system:

Owner(s):	Sopel, Dale M. & Joane M.
Location:	117 Rowe St.
Plot/Lot:	81/119
Service Pipe Length Installed:	20
Total Cost of Service Line:	\$294.00

In addition to the cost of the service line provided for the property, which the property owner must reimburse the City for when ready to connect to the sewer system, there is also a "Sewer Permit" fee of \$150.00. Once ready to connect to the sewer system, the property owner must come to City Hall, D.P.W. Engineering office, Room 303, to obtain said permit, at which time both of these amounts are due to the City. If someone other than the property owner is going to obtain the permit, this person must have a signed permission slip from the property owner allowing the entity to sign on behalf of the property owner. Also, if the property owner is abandoning a septic system, they must make arrangements with the Health Department at (508) 991-6273.

The City has brought the sewer service pipe to your property line. The property owner is responsible for making the provisions for any work required and costs incurred on their property. Property owners should make sure that the contractor they hire knows that, although they are working on private property, the D.P.W. Waste Water Division, and possibly other City officials, must inspect all work done before the sewer trench is backfilled.

Should you have any questions or need additional information, please feel free to contact Ana Rosa or Mario Gomes in the Engineering Department at (508) 979-1527.

Sincerely,

*Robert J. Carey*  
Robert J. Carey, P.E.  
City Engineer

*CONSTRUCTION FINALIZED*

RJC/asr

# DRAIN

Permit

No.

Enters Rowe St

Drain Plot No.

From Property of

Rowe St #117 WEST SIDE

