

PERMIT NO.

23054

CITY OF NEW BEDFORD

DATE: 3/14/2001



SEWER AND/OR STORM DRAIN PERMIT

This certifies that permission is granted to

Majora Beasette 1338 Rockdale Ave. N.B., MA 01903-7331
 Property Owner Address 1338 Tel.

to connect a sewer and/or storm drain located at 1338 Rockdale Ave. Street
 Assessor's Plot 87, Lot 14, to the sewer and/or storm drain in Rockdale Ave. Street

TYPE OF USE: ☒ RESIDENTIAL ☐ COMMERCIAL ☐ INDUSTRIAL ☐ OTHER

If applicant other than actual property owner, attach Letter of Authorization from Property Owner.

200 GPD
RECEIVED

Name..... Tel.....

Mailing Address..... AUG - 7 2001

The Bonded Contractor/Drain Layer authorized to perform this work is:

DEPT. OF PUBLIC WORKS
NEW BEDFORD, MASS

Joe Augusta Backhoe Service 324 Bridge St. Fairhaven, MA 01934-3599
 Name Address Tel.

Type of Pipe Required: PVC SDR-35
 PERMIT EXPIRES ONE YEAR AFTER DATE OF ISSUE

- * Requires separate connections for sewage and storm drain where applicable. Storm water cannot be discharged to a sanitary sewer.
- * All work must be inspected and approved by a D.P.W. inspector before backfilling.
- * If this connection is to be part of a private service shared jointly with other building owners, attach copy of Recorded Joint Maintenance Agreement.
- * Permits can be issued to Industrial and/or Commercial Applicants only upon receipt and approval by the Commissioner of Public Works of required plans and supplemental information.
- * In addition, a City-issued Industrial User Discharge Permit and/or a Sewer Extension/Connection Permit issued by the Commonwealth of Massachusetts D.E.P. shall be required by the City for Industrial Discharge into the sewer system.

Industrial User Discharge Permit No..... Date.....

Comm. Mass. Sewer Conn./Ext. Permit No..... Date.....

A Filing and Inspection Fee of \$.150.00, plus an Entrance Fee of \$.382.20 where applicable, must accompany this application.

Bank # COMPASS BANK Check # 1154 Date: 3/14/2001 Receipt # 3944
 Other requirements: TOSP. Only - Sub at Prop. Line - Range S1. Proj. - Sub. Cost
 26' x 14' 7.0' / 1.4' = 380.20 + \$150.00 Inspection Fee. Total \$530.20

☒ Sewer

Connection made to

Part of jointly-shared private line ☐ Yes ☒ No

FOR INSPECTION ONLY, A 24 HOUR
 NOTICE IS REQUIRED AND THE
 CONTRACTOR/APPLICANT IS
 REQUIRED TO NOTIFY THE
 WASTEWATER DIVISION AT 991-615

Applicant agrees to abide by the above terms, as well as all pertinent ordinances of the City of New Bedford, and such other special rules as the Commissioner of Public Works may deem necessary

Signature: D. Warden (M) Commissioner of Public Works
 Signature of Property Owner or Representative

INSPECTED BY: JOSEPH MARTIN

DATE: 5/4/01

COMMENTS: ECDM installed from

main in street to prop. line -

House St. sewer project. 7

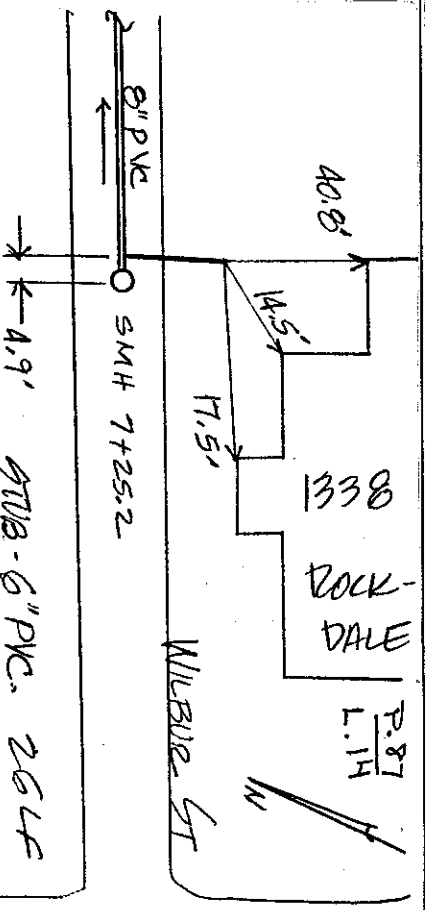
APPROVED ☐ DISAPPROVED

SIGNATURE: [Signature]

ROCKDALE AVE. (cont)
 SKETCH PLAN

DRAIN
Permit No. _____
Enters WILBUR ST
Drain Plot No. _____

From Property of _____

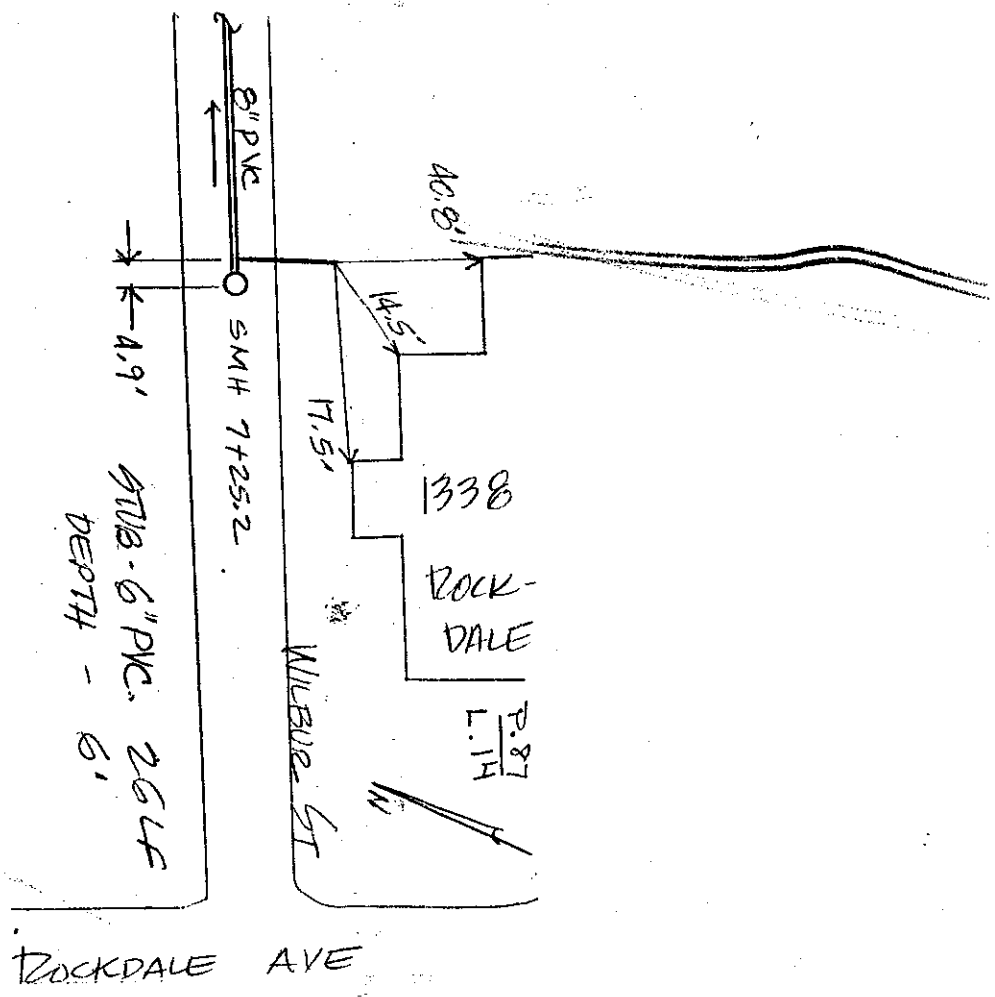

PERMIT NO.

23054

CITY OF NEW BEDFORD

DATE 3/14/2001



SEWER AND/OR STORM DRAIN PERMIT

This certifies that permission is granted to

Marjorie Bessette 1333 Rockdale Ave. N.B. MA 992-7331
 Property Owner Address 1333 Tel.

to connect a Sewer and/or storm drain located at 1333 Rockdale Ave. Street
 Assessor's Plot 87, Lot 14, to the Sewer and/or storm drain in Rockdale Ave. Street

TYPE OF USE: ☒ RESIDENTIAL ☐ COMMERCIAL ☐ INDUSTRIAL ☐ OTHER

220 GPD

If applicant other than actual property owner, attach Letter of Authorization from Property Owner.

Name..... Tel.....

Mailing Address.....

The Bonded Contractor/Drain Layer authorized to perform this work is:

Joe August Bachee Service 324 Bridge St. Fairhaven, MA 946-3599
 Name Address Tel.

Type of Pipe Required: PVC SDR-35

PERMIT EXPIRES ONE YEAR AFTER DATE OF ISSUE

* Requires separate connections for sewage and storm drain where applicable. Storm water cannot be discharged to a sanitary sewer.

* All work must be inspected and approved by a D.P.W. inspector before backfilling.

* If this connection is to be part of a private service shared jointly with other building owners, attach copy of Recorded Joint Maintenance Agreement.

* Permits can be issued to Industrial and/or Commercial Applicants only upon receipt and approval by the Commissioner of Public Works of required plans and supplemental information.

* In addition, a City-issued Industrial User Discharge Permit and/or a Sewer Extension/Connection Permit issued by the Commonwealth of Massachusetts D.E.P. shall be required by the City for Industrial Discharge into the sewer system.

Industrial User Discharge Permit No..... Date.....

Comm. Mass. Sewer Conn./Ext. Permit No..... Date.....

A Filing and Inspection Fee of \$.150.00, plus an Entrance Fee of \$.352.20 where applicable, must accompany this application.

Bank # COMPASS BANK Check # 1154 Date: 3/14/2001 Receipt # 3944

Other requirements: TOSSE Only - Sub at Prop. Line - Rowe St. Proj. - Sub Cost
 26' x 14-70/1.4 = \$382.20 + \$150.00 Inspection Fee Total \$532.20

☒ Sewer

FOR INSPECTION ONLY, A 24 HOUR

Connection made to

Part of jointly-shared private line ☐ Yes ☒ No

NOTICE IS REQUIRED AND THE CONTRACTOR/APPLICANT IS

REQUIRED TO NOTIFY THE

WASTEWATER DIVISION AT 991-6158

Applicant agrees to abide by the above terms, as well as all pertinent ordinances and any other special rules as the Commissioner of Public Works may deem necessary

Lawrence D. Warden (Signature)
 Commissioner of Public Works
 Marjorie Bessette (Signature)
 Signature of Property Owner or Representative

INSPECTOR'S REPORT

INSPECTED BY: _____

DATE: _____

COMMENTS: _____

☐ APPROVED ☐ DISAPPROVED

SIGNATURE

SKETCH PLAN