



CITY OF NEW BEDFORD

APPLICATION FOR CONNECTION TO
PUBLIC SANITARY SEWER AND/OR STORM DRAIN

Application No. 22238

Date 7/15/93

(#8)

The undersigned hereby requests permission to connect a building sanitary and/or storm sewer from the premises located at Foley Dr., NEC Michelle Lane, Assessors' Plot 132I Lot 97, to the public sanitary/storm sewer(s) in Foley Drive; the same to be installed in accordance with the terms and conditions set forth herein, and the ordinances of the City of New Bedford.

Name of Property Owner: Long Realty, Inc. Tel. 999-7067
Please Print

Owner's Mailing Address: 658 Rockdale Ave., N.B.

If application is being submitted by other than actual property owner, indicate that person's Name: Tel.

Mailing Address:

and attach Letter of Authorization from Property Owner hereto.

BONDED CONTRACTOR OR DRAIN LAYER MAKING INSTALLATION

Name: Dalonte Construction Tel. 824-4852

Address: 287 Tremont St. Taunton, MA

JOINT MAINTENANCE AGREEMENT REQUIRED

If this connection is to be part of a private service shared jointly with other building owners, attach copy of Recorded Joint Maintenance Agreement.

P. 132I
L. 97

PERMITS TO INDUSTRIAL DISCHARGE

Permits can be issued to Industrial Discharge by the Commissioner of Public Works of the City of New Bedford, and quantity data, and other pertinent information.

In addition, a valid Industrial User Discharge Permit System Extension or Connection issued by the City of New Bedford, shall be required for application to the City of New Bedford.

Industrial User Discharge Permit No.

Comm. Mass. Sewer Conn./Ext. Permit

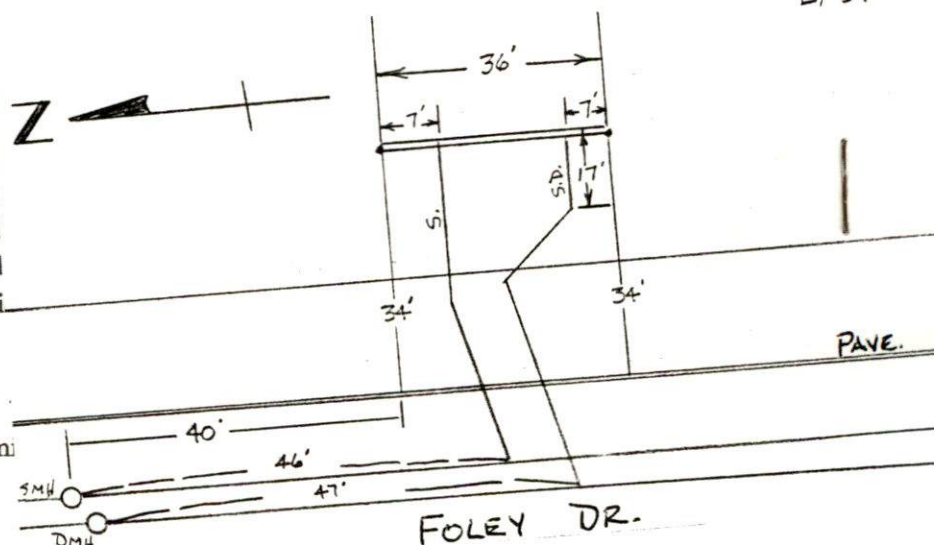

a) Type of Pipe Required: PVC

b) Separate Sanitary and Storm connections are required where a 2 - pipe system exists in the street.

c) All work must be inspected and approved by a D.P.W. Inspector, both in the street and on private property, before backfilling.

d) A Filing and Inspection Fee of \$ 150.00, plus an Entrance Fee of \$ where applicable, must accompany this application.

e) Other requirements: Insp. only connect to stub at prop. line 330 GPD

Applicant agrees to abide by the above terms, as well as all pertinent ordinances of the City of New Bedford, and such other special rules as the Commissioner of Public Works may deem necessary.

Lawrence D. Worden
Commissioner of Public Works

Long Realty, Inc.
Signature of Property Owner

By: Hyman A. Day

By: Long Realty, Inc.
Signature of Owner's Representative