



CITY OF NEW BEDFORD

APPLICATION FOR CONNECTION TO
PUBLIC SANITARY SEWER AND/OR STORM DRAIN

Application No. 22195

Date 5-4-93

The undersigned hereby requests permission to connect a building ~~sanitary~~ and/or storm sewer from the premises located at County St (WS) 150' N. of Hawthorn St Assessors' Plot 41 Lot 13, to the public sanitary/storm sewer(s) in County St Street; the same to be installed in accordance with the terms and conditions set forth herein, and the ordinances of the City of New Bedford.

Name of Property Owner: Rep Blay House Richard Minton Tel. 763-3158
Please Print

Owner's Mailing Address: 397 County St

If application is being submitted by other than actual property owner, indicate that person's Name: Joseph Mello Tel. 763-3158
Mailing Address: Box 676 E. Freetown
and attach Letter of Authorization from Property Owner hereto.

BONDED CONTRACTOR OR DRAIN LAYER MAKING INSTALLATION

Name: Mello Tel. 763-3158
Address: Box 676 E. Freetown

JOINT MAINTENANCE AGREEMENT REQUIRED

If this connection is to be part of a private service shared jointly with other building owners, attach copy of Recorded Joint Maintenance Agreement hereto.

PERMITS TO INDUSTRIAL AND/OR COMMERCIAL APPLICANTS

Permits can be issued to Industrial and/or Commercial Applicants only upon receipt and approval by the Commissioner of Public Works of such supplemental information, including drawings, composition and quantity data, and other pertinent information as he may require.

In addition, a valid Industrial User Discharge Permit issued by the City, and a valid Permit for Sewer System Extension or Connection issued by the Commonwealth of Massachusetts, Division of Water Pollution Control, shall be required for applicants wishing to discharge industrial wastes to the City's sewer system.

Industrial User Discharge Permit No. Date

Comm. Mass. Sewer Conn./Ext. Permit No. Date

TERMS

- a) Type of Pipe Required: PVC SDR-35
- b) Separate ~~Sanitary~~ and Storm connections are required where a 2 - pipe system exists in the street.
- c) All work must be inspected and approved by a D.P.W. Inspector, both in the street and on private property, before backfilling.
- d) A Filing and Inspection Fee of \$ 150.00, plus an Entrance Fee of \$ where applicable, must accompany this application.
- e) Other requirements: chase only - Mello to do all work to be connected (drain only) to CB on street

Applicant agrees to abide by the above terms, as well as all pertinent ordinances of the City of New Bedford, and such other special rules as the Commissioner of Public Works may deem necessary.

Lawrence D. Wardenak Blaise Hues J. Leem
Commissioner of Public Works Signature of Property Owner

By: SK By: Joseph G Mello Inc.
Signature of Owner's Representative

To Whom It May Concern:

I, John Feeney, 491 Maple St, Danvers, being owner Rep.
(Name & Mailing Address)
of property located at 397 Conny St,
(Address if Available)
plot 41, lot 13, hereby agree to allow Steve Pacheco,
(Name)
J. Mello Inc
10 Herbert Road Acushnet MA 02743 to act in my behalf,
(Mailing Address)
including affixing my signature, in securing permits for:

- ☒ Sewer/Drain Service Permits
- ☒ Water Service Permits
- ☒ Driveway Installation Permits
- ☒ Sidewalk Installation Permits

I further agree to conform to, and abide by, all City rules and regulations applicable to the permit(s) being applied for.

Name John Feeney
Print
John Feeney
Signature
5-3-93
Date

To Whom It May Concern:

I, RICHARD S. MINTURN, being owner's REPRESENTATIVE
(Name & Mailing Address)
of property located at 397 COUNTY ST,
(Address if Available)
plot 41, lot 13, hereby agree to allow JOHN FEENEY,
(Name)
491 MAPLE ST, DANVERS, MA 01923 to act in my behalf,
(Mailing Address)
including affixing my signature, in securing permits for:

- ☐ Sewer/Drain Service Permits
- ☐ Water Service Permits
- ☒ Driveway Installation Permits
- ☒ Sidewalk Installation Permits

I further agree to conform to, and abide by, all City rules and regulations applicable to the permit(s) being applied for.

Name RICHARD S. MINTURN
Print

R. S. Minturn
Signature

3-25-93
Date

Two existing driveways on County St. to be relocated/
opening not to increase in size. One dw brow to be
closed.

NOTE: CONTRACTOR
EXACT LOCATION
LINES PRIOR TO
WORK

CO
DF

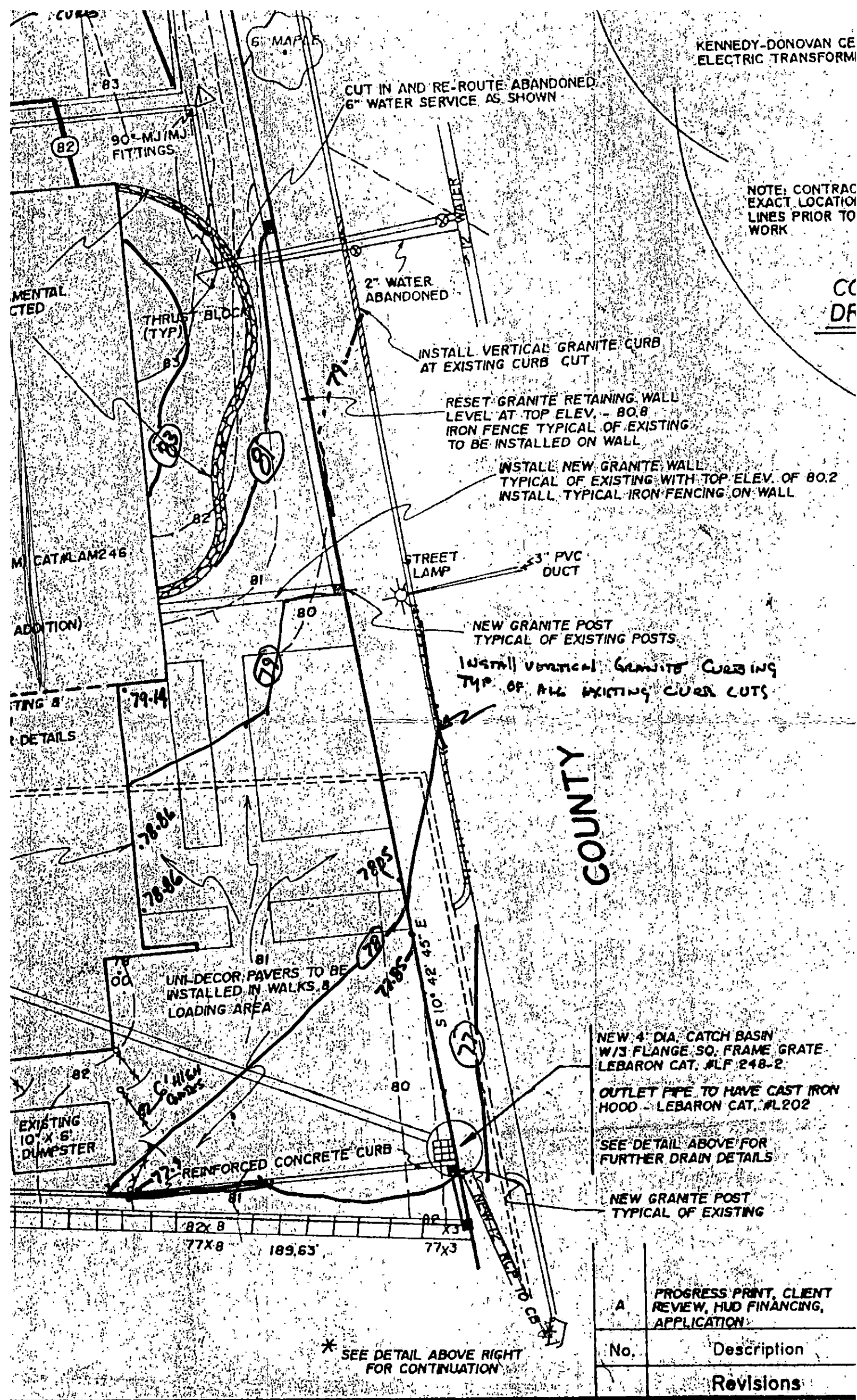

COUNTY

NEW 4' DIA. CATCH BASIN
W/3 FLANGE SO. FRAME GRATE
LEBARON CAT. #LF 248-2

OUTLET PIPE TO HAVE CAST IRON
HOOD - LEBARON CAT. #L202

SEE DETAIL ABOVE FOR
FURTHER DRAIN DETAILS

NEW GRANITE POST
TYPICAL OF EXISTING

* SEE DETAIL ABOVE RIGHT
FOR CONTINUATION

A	PROGRESS PRINT, CLIENT REVIEW, HUD FINANCING, APPLICATION	
	No.	Description
		Revisions

INSTALL 12" x 12" FLOOR DRAIN
NEENAH R4937 C SERIES
CAT. # R4937-C3
TOP OF GRATE - 84.10

DRAINS TO ENTER
AND DROP TO ENTER
BASIN AT INV. ELEV. 75.76

NEW 4' DIA. CATCH BASIN W/3' SUMP
LEBARON ROUND FRAME & GRATE (TYPE AM CAT. # AM246)
T.O.F. - 78.50
10" C.I. PIPE OUT - INV. 75.66
6" C.I. PIPE IN - INV. 75.76
8" C.I. PIPE IN - INV. 75.76
8" C.I. PIPE IN (ROOF DRAINS LOCATED IN ADDITION)
INV. IN - 76.66

DRAINAGE TIE IN FOR EXISTING &
PROPOSED DRAINS WITHIN
ADDITION AREAS
SEE PLUMBING PLANS FOR DETAILS

EXISTING ROOF DRAIN
TO BE REMOVED

NEW 3 STORY
ADDITION

UNDECOR. PAVERS
BE INSTALLED
PATIO AREA
SEE LANDSCAPE PLAN
FOR DETAILS

6" C.I. PIPE
SEE PATIO DRAIN DETAILS

TOP OF R.C.
RETAINING WALL
ELEV. 83.0

NEW KEYSTONE OR FIELDSTONE
ORNAMENTAL WALL
T.O.W. - 86.08

HIGH
GRADE GATE

NEW 6" PRESSURE TREATED
LATTICE SCREEN FENCE

TOP OF STAIRS
ELEV. - 84.16

BOT. OF STAIRS
ELEV. - 78.33

9 1/2' X 5'
DIESEL TANK
PAD

EXISTING
10' X 6'
DUMPSTER

UNDECOR. PAVERS TO BE
INSTALLED IN WALKS &
LOADING AREA

6" HIGH
CURBS

REINFORCED CONCRETE CURB

STREET
LAMP
3" PVC
DUCT
NEW GRANITE P
TYPICAL OF EXI
INSTALL VENTILATION
TYP OF ALL

TOP OF NEW KEYSTONE
RETAINING WALL ELEV. - 84.75

* SEE DETAIL ABOVE RIGHT
FOR CONTINUATION