



CITY OF NEW BEDFORD

APPLICATION FOR CONNECTION TO  
PUBLIC SANITARY SEWER AND/OR STORM DRAIN

Application No. 22150

Date 6-22-92

The undersigned hereby requests permission to connect a building sanitary and/or storm sewer from the premises located at Tradewind St. (W.S.) 190' ± S. of Gardner St., Assessors' Plot 120 Lot 34, to the public sanitary/storm sewer(s) in Tradewind St.; the same to be installed in accordance with the terms and conditions set forth herein, and the ordinances of the City of New Bedford.

Name of Property Owner: Stuart A. Lawrence Tel. 993-3109  
Please Print

Owner's Mailing Address: 911 Tradewind St. N.B. 02740

If application is being submitted by other than actual property owner, indicate that person's

Name: Tel.

Mailing Address:

and attach Letter of Authorization from Property Owner hereto.

BONDED CONTRACTOR OR DRAIN LAYER MAKING INSTALLATION

Name: W.C. Smith Tel. 995-1449

Address: 58 Ridgewood Rd N.B. MA 02745

JOINT MAINTENANCE AGREEMENT REQUIRED

If this connection is to be part of a private service shared jointly with other building owners, attach copy of Recorded Joint Maintenance Agreement hereto.

PERMITS TO INDUSTRIAL AND/OR COMMERCIAL APPLICANTS

Permits can be issued to Industrial and/or Commercial Applicants only upon receipt and approval by the Commissioner of Public Works of such supplemental information, including drawings, composition and quantity data, and other pertinent information as he may require.

In addition, a valid Industrial User Discharge Permit issued by the City, and a valid Permit for Sewer System Extension or Connection issued by the Commonwealth of Massachusetts, Division of Water Pollution Control, shall be required for applicants wishing to discharge industrial wastes to the City's sewer system.

Industrial User Discharge Permit No. Date

Comm. Mass. Sewer Conn./Ext. Permit No. Date

TERMS

- a) Type of Pipe Required: PVC SDR-35
- b) Separate Sanitary and Storm connections are required where a 2 - pipe system exists in the street.
- c) All work must be inspected and approved by a D.P.W. Inspector, both in the street and on private property, before backfilling.
- d) A Filing and Inspection Fee of \$ 540.00, plus an Entrance Fee of \$ where applicable, must accompany this application.
- e) Other requirements: class only - W.C. Smith to do all work - to be connected to S. M.H. on street 330 G.P.D.

Applicant agrees to abide by the above terms, as well as all pertinent ordinances of the City of New Bedford, and such other special rules as the Commissioner of Public Works may deem necessary.

Lawrence D. Wodensh  
Commissioner of Public Works

Signature of Property Owner

By: Susan Davis

By:

Signature of Owner's Representative

HOUSE NO. 911AVENUE  
STREETTRADEWIND ST.9

DEPTH FROM TOP OF CELLAR WALL TO CELLAR FLOOR.

6'9"

Permit SEWER  
# 22150  
6/22/92  
ms.

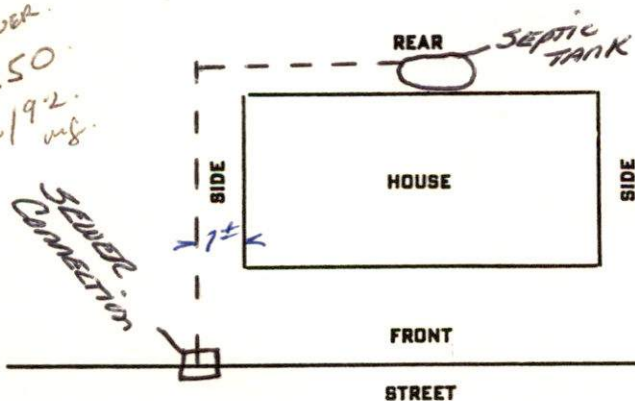

SIGNED BY.

Handwritten Signature

DATE

4-20-79