

CITY OF NEW BEDFORD

APPLICATION FOR LAYING BUILDING SEWER AND/OR DRAIN SERVICE

Application **Nº 20804**

5-1-84
Date

To the Mayor and City Council:

I hereby request that a building sewer and/or drain be laid for the premises at

S.E. COR. ACUSHNET AVE. & OSCAR ST.

to connect with the sewer/drain in ACUSH AVE. (ENTER M.H. @ INTERSECTION) street,
the same to be laid in the street and the surface repaired as directed by the Commissioner of
Public Works.

I hereby agree to pay at the office of the City Treasurer all cost of performing the above
work in the manner specified, in excess of the deposit made herewith, within 10 days after the
completion of the work.

It is understood and agreed that the deposit made with this application shall be applied
to the payment of the cost of performing the work done, and that any excess of deposit over the
cost shall be returned to me by the City Treasurer.

Witness Bill Bamber Thomas Lading

Signature of Property Owner

54 JOHN ST. ACUSHNET, 02743
Address Telephone No.

W.C. SMITH & SON,
Plumber's Name

Requires separate entrance
for roof water

Address

Permits to Industrial and/or Commercial Applicants:

Permits can be issued to industrial and/or commercial applicants only upon receipt by
the Commissioner of Public Works of such supplemental information as may be required by
him concerning the quality and quantity of the proposed wastewater discharge.

This information was submitted by.....

Signature of Applicant (owner)

and approved by the Commissioner of Public Works on

Date

Commissioner of Public Works

Estimate and Deposit Requirement

Office of Commissioner of Public Works, 5-1-84

My estimate of the cost of laying the building sewer and/or drain described in the above
application is 50.00

Assessed
Entrance charges Total deposit required 50.00

Robert J. Carter
Commissioner of Public Works

Certificate of Issue

Office of City Clerk, 5-1-84

The above application, accompanied by City Treasurer's receipt presented this day;
whereupon Permit No. 20804 was issued, and the Commissioner of Public Works
notified of the same.

Janice Davis
City Clerk

Laid from main in street to property line.
Owner agrees to supply all necessary mater-
ials and P.V.C. 500-35 pipe.

1. 1. 1.

— — — — —

Permit No. 20804

BILL BOUCHEIL

999-2931

EXT 253
333

CITY OF NEW BEDFORD

DEPARTMENT OF PUBLIC WORKS

Supplementary Information Required from Commercial or
Industrial Firms in Addition to Issuance of Sewer Entrance Permit

O.K.
5-1-84
JB

A. Architect's floor plan showing proposed connections to building drain (inside building):

B. Architect's detail drawings of any pretreatment or equalization equipment:

C. Site plan showing:

- ☒ (1) Building and location of building sewer
- ☒ (2) Proposed connection to public sewer
- ☒ (3) Profile of building sewer
- ☒ (4) Plan and profile of storm drain
- ☒ (5) Location of control manhole
(Standard type — preferably between property line and public sewer.)

D. Wastewater Information:

Date: 4/23/84

☒ (1) Name of firm: Clean Machine

☒ (2) Address: 2712 Amherst Ave.

☒ (3) Name and title of person completing form. (company representative):

Steven Ladio owner
(LADINO)

☒ (4) Industry type (SIC Number):

☒ (5) Number of Employees: 2

☒ (6) Principal products manufactured, produced, processed or sold:

HOT DOG STAND & CAR WASH COMPS.

(7) Sources of water supply: Municipal ☒ Well ☐

☒ (8) Estimated volume of water to be used per day: 1400 gallons.

(9) Flow gauges in plant ☐ influent ☐ effluent.

☒ (10) Water consumed in processes: NONE %.

☒ (11) Recycled water: NONE %.

☒ (12) Cooling water: NONE %.

☒ (13) Number of operating days per week: 6

☒ (14) Number of shifts per day: 1

☒ (15) Type of discharge: ☐ continuous ☒ batch.

☒ (16) If batch 1400 per shift.

☒ (17) Estimated volume of wastewater discharged daily 1400 gallons.

(18) Wastewater abatement practices to be used:

(a) Process changes: ☐

(b) Changes in raw materials: ☐

(c) Recycling methods: ☐

(d) Wastewater treatment equipment: ☐

(e) Monitoring devices: ☐

(f) Sampling and testing procedures: ☐

(19) Expected constituents of final wastewater discharge:

(a) pH ☐ (d) Cl Req'm't. ☐ mg/l

(b) Grease/Oil ☐ mg/l (e) S. S. ☐ mg/l

(c) C O D ☐ mg/l (f) Color ☐ mg/l

(20) Steven Ladio

Signature of Property Owner

Date 4/23/84

OSGOOD ST.

2712 ACUSHNET AVE.

SCALE AS SHOWN

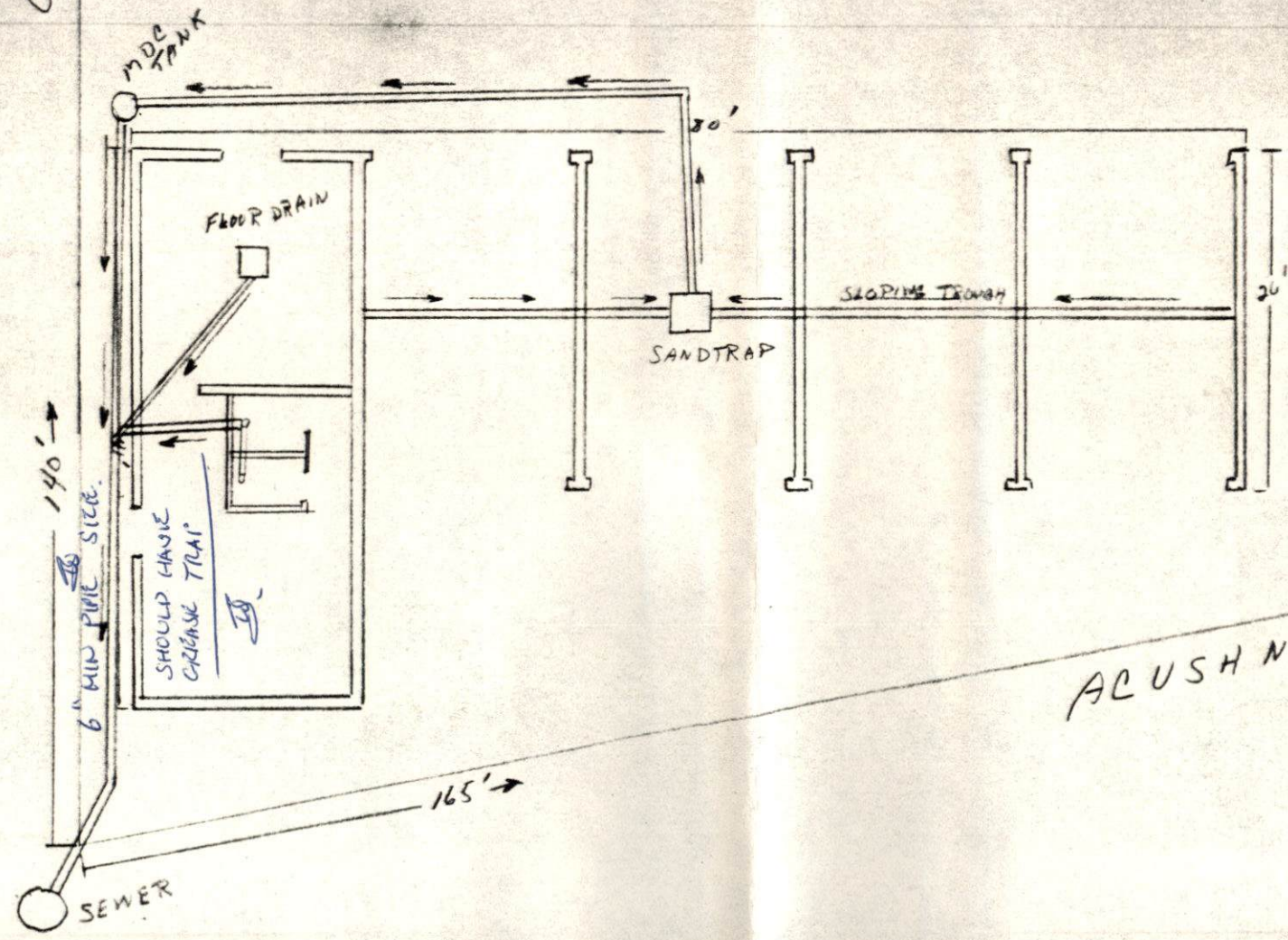

OK,
5-1-84
B.

ACUSHNET AVE.

