

CITY OF NEW BEDFORD

APPLICATION FOR LAYING BUILDING SEWER AND/OR DRAIN SERVICE

J Application No 20295

June 2, 1978

Date

To the Mayor and City Council:

I hereby request that a building sewer and/or drain be laid for the premises at

South side Wright Street 250'± east of MacArthur Drive

to connect with the sewer/drain in Wright street,
the same to be laid in the street and the surface repaired as directed by the Commissioner of
Public Works.

I hereby agree to pay at the office of the City Treasurer all cost of performing the above
work in the manner specified, in excess of the deposit made herewith, within 10 days after the
completion of the work.

It is understood and agreed that the deposit made with this application shall be applied
to the payment of the cost of performing the work done, and that any excess of deposit over the
cost shall be returned to me by the City Treasurer.

Witness

Signature of Property Owner

Address

Telephone No.

Plumber's Name

Address

Requires separate entrance
for roof water

Permits to Industrial and/or Commercial Applicants:

Permits can be issued to industrial and/or commercial applicants only upon receipt by
the Commissioner of Public Works of such supplemental information as may be required by
him concerning the quality and quantity of the proposed wastewater discharge.

This information was submitted by

Signature of Applicant (owner)

and approved by the Commissioner of Public Works on

Date

Commissioner of Public Works

Estimate and Deposit Requirement

Office of Commissioner of Public Works,

My estimate of the cost of laying the building sewer and/or drain described in the above
application is

Assessed

Entrance charges

Total deposit required

15.00

Commissioner of Public Works

Certificate of Issue

Office of City Clerk, June 2, 1978

The above application, accompanied by City Treasurer's receipt presented this day;
whereupon Permit No. 20295 was issued, and the Commissioner of Public Works
notified of the same.

City Clerk

Laid from main in street to property line.
Owner agrees to supply all necessary mater-
ials and transite pipe.

Drain installed prior to permit. No Insp. possible
D. & W. Contractor installed drain, Control M.H. may
be installed later if required (per Jack Turner).

00.24

Jan. 2, 1978

Permit No. 20295

CITY OF NEW BEDFORD
DEPARTMENT OF PUBLIC WORKS

Supplementary Information Required from Commercial or Industrial Firms in Addition to Issuance of Sewer Entrance Permit

- A. Architect's floor plan showing proposed connections to building drain (inside building):
B. Architect's detail drawings of any pretreatment or equalization equipment:
C. Site plan showing:

- (1) Building and location of building sewer
(2) Proposed connection to public sewer
(3) Profile of building sewer
(4) Plan and profile of storm drain
(5) Location of control manhole
(Standard type — preferably between property line and public sewer.)

D. Wastewater Information:

Date: 5/8/78

- (1) Name of firm: ROY ENOKSEN (DOCKSIDE REPAIR)
(2) Address: WRIGHT ST. 50 Terminal
(3) Name and title of person completing form. (company representative):

758-4596 John W Folino Jr. Pres. CAPE BUILDING SYSTEMS

- (4) Industry type (SIC Number):
(5) Number of Employees: 5
(6) Principal products manufactured, produced, processed or sold: office, electronic gear sales + service + storage + repair of fishing gear
(7) Sources of water supply: Municipal ☒ Well
(8) Estimated volume of water to be used per day: 500-7000 gallons.
(9) Flow gauges in plant NONE influent effluent.
(10) Water consumed in processes: NONE %.
(11) Recycled water: 0 %.
(12) Cooling water: 0 %.
(13) Number of operating days per week: 6
(14) Number of shifts per day: 1
(15) Type of discharge: ☒ continuous batch.
(16) If batch per shift.
(17) Estimated volume of wastewater discharged daily 500-1000 gallons.
(18) Wastewater abatement practices to be used: NONE

(a) Process changes:

(b) Changes in raw materials:

(c) Recycling methods:

(d) Wastewater treatment equipment:

(e) Monitoring devices:

(f) Sampling and testing procedures:

(19) Expected constituents of final wastewater discharge: PH is unaffected by operations

- (a) pH no change (d) Cl Req'm't. none mg/l
(b) Grease/Oil trace mg/l (e) S. S. mg/l
(c) COD mg/l (f) Color no change mg/l

(20) Ray Enoksen 5/10/78
Signature of Property Owner Date

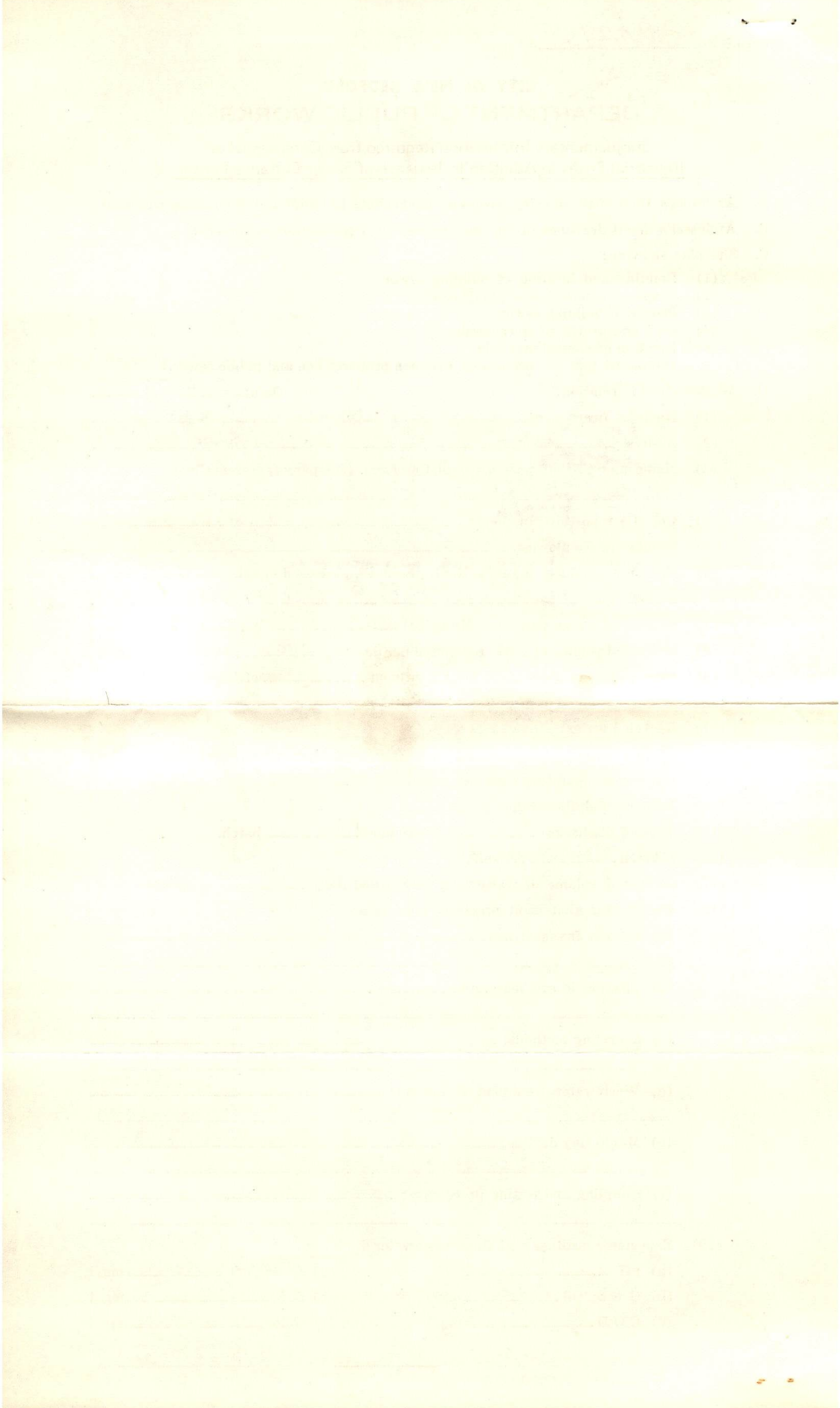

ROY ENOKSEN

PERMIT ISSUED

6-2-78 *JB*

O.K. TO ISSUE PERMIT - JOB HAS BEEN COMPLETED WITHOUT INSPECTION. G.H.B. SAYS HE WILL NOT FORCE WHITIE TO DIG IT UP FOR INSP. - HAVE DOT TRIPP MAKE CARD FOR THIS: "NO INSP. POSS. TRENCH BACKFILLED. CITY NOT RESPONSIBLE FOR DRAIN". PUT NOTE ON PERMIT APP. UNDER REMARKS: "CONTROL M.H. MAY BE REQUIRED AT LATER DATE (SIGNED) JACK TURNER".



May 31, 1978

I, Roy Enoksen, give my permission to Cape
Building Systems to obtain the necessary
permit for sewer lines.

Roy Enoksen

(SIGNATURE BY MRS. ENOKSEN, ACCORDING
TO JOHN FELINO.)

May 31, 1978

I, Roy Brooks, give my permission to Cape
Building Systems to obtain the necessary
permit for sewer lines.

(Signature of Roy Brooks)
Roy Brooks

ROY ENOKSEN

SOUTH TERMINAL
PARCEL # 1

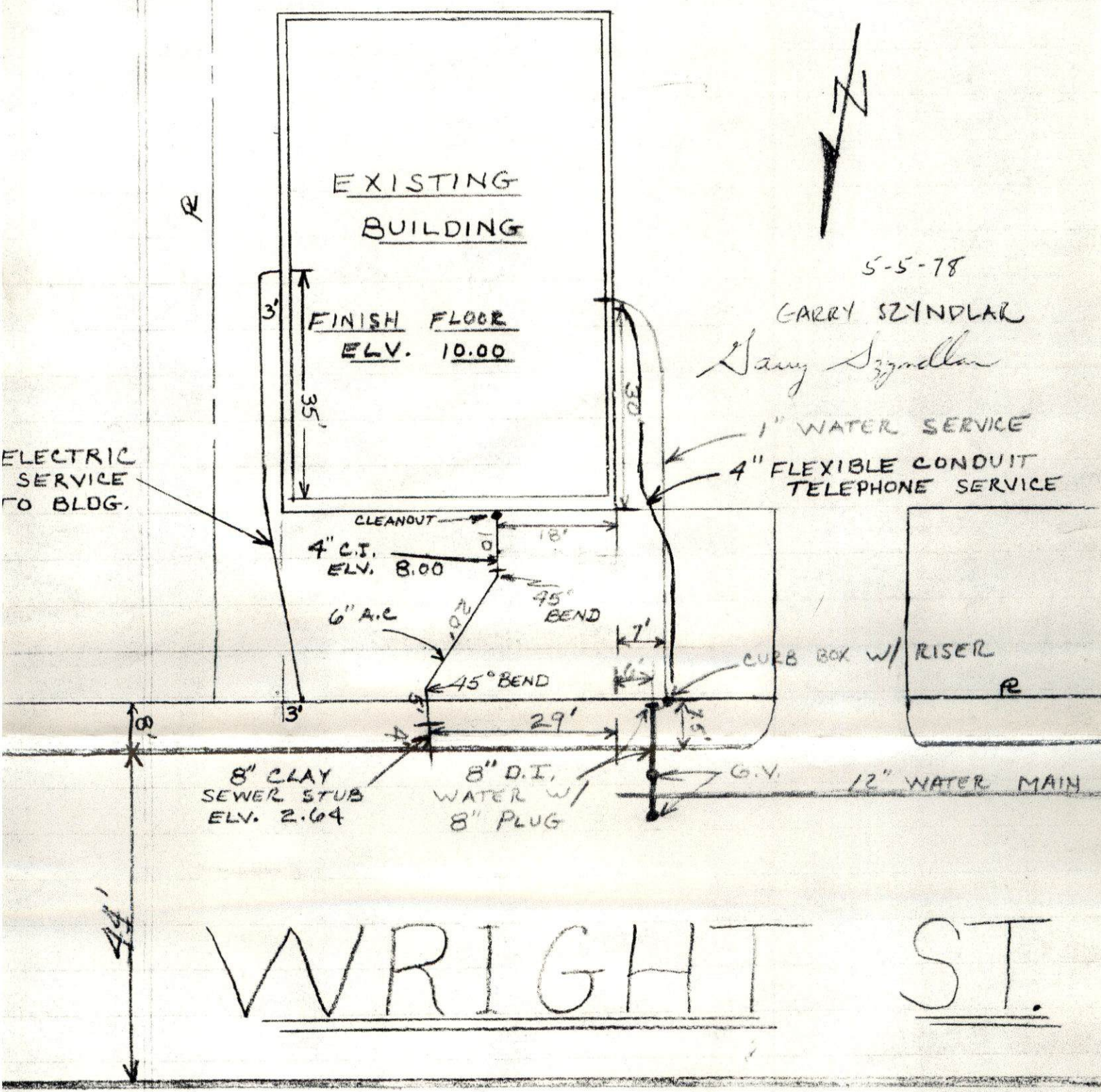

5-5-78

GARRY SZYNOLAR

Garry Szynolar

1" WATER SERVICE

4" FLEXIBLE CONDUIT
TELEPHONE SERVICE

CURB BOX W/ RISER

8" CLAY
SEWER STUB
ELEV. 2.64

8" D.I.
WATER W/
8" PLUG

12" WATER MAIN

WRIGHT ST.

SCALE 1" = 20'

