

EVERSOURCE ENERGY

HATHAWAY ROAD RAILROAD CROSSING
INSTALLATION OF 70' OF 6" PRITEC COATED STEEL CASING
AND 70' OF 8" PRITEC COATED STEEL CASING
HATHAWAY ROAD
NEW BEDFORD, MASSACHUSETTS
ENE PROJECT #: 2008903.00
EVERSOURCE PROJECT #: 4310094

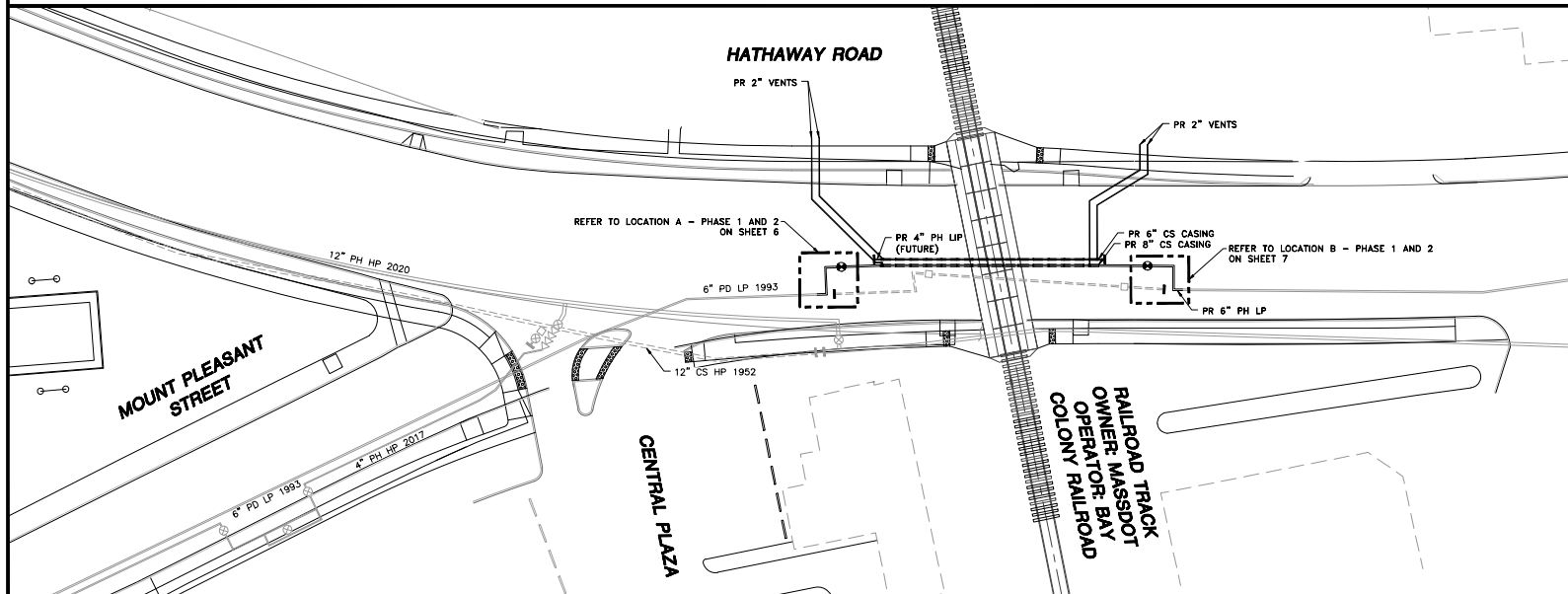
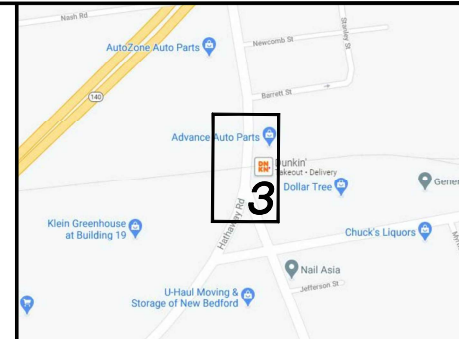
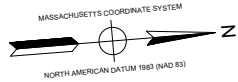

SITE PLAN
NEW BEDFORD, MASSACHUSETTS
(SCALE: 1"=20')
(DO NOT SCALE FROM DRAWINGS)

SHEET INDEX	
SHEET NUMBER	DESCRIPTION
1	SITE PLAN, LOCUS PLAN AND SHEET INDEX
2	GENERAL NOTES AND CROSSING DATA SHEETS
3	INSTALLATION PLAN
4	6" CASING INSTALLATION PLAN, PROFILE AND DETAIL
5	8" CASING INSTALLATION PLAN, PROFILE AND DETAIL
6	LOCATION A - PHASE 1, 2 AND SCHEDULE OF MATERIALS
7	LOCATION B - PHASE 1, 2 AND SCHEDULE OF MATERIALS
8	STANDARD CORROSION DETAILS

NO.	DESCRIPTION	DATE	REV. NO.
0	ISSUED FOR CONSTRUCTION	03/16/2021	LR/AB/EK

REVISION STATUS

EVERSOURCE
ENERGY

HATHAWAY ROAD RAILROAD CROSSING
NEW BEDFORD, MASSACHUSETTS

SITE PLAN, LOCUS PLAN AND SHEET INDEX

SCALE: AS NOTED	DRAWN BY / DATE	CHECKED BY / DATE	SHEET NUMBER	REV. NO.
	LR 01/04/2021	AB 03/16/2021	MA-NEB-21-RRX-600-01	0

ISSUED FOR
CONSTRUCTION
03/16/2021

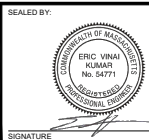

SEALED BY:
03/17/2021
LICENSURE EXPIRATION:
06/30/2022

DESIGNED IN ACCORDANCE WITH TITLE 46 PART 1B OF MASSACHUSETTS REGULAR SAFETY STANDARDS AND OPTIC GUIDE FOR GAS TRANSMISSION AND DISTRIBUTION PIPING SYSTEMS, LATEST EDITION.
ENEngineering
26 BARTLETT STREET
MADEBOROUGH, MA 01926
TEL: (508) 393-4000
FAX: (508) 393-7777
WWW.ENENGINEERING.COM

FIELD VERIFY DIMENSIONS
PRIOR TO PIPE FABRICATION

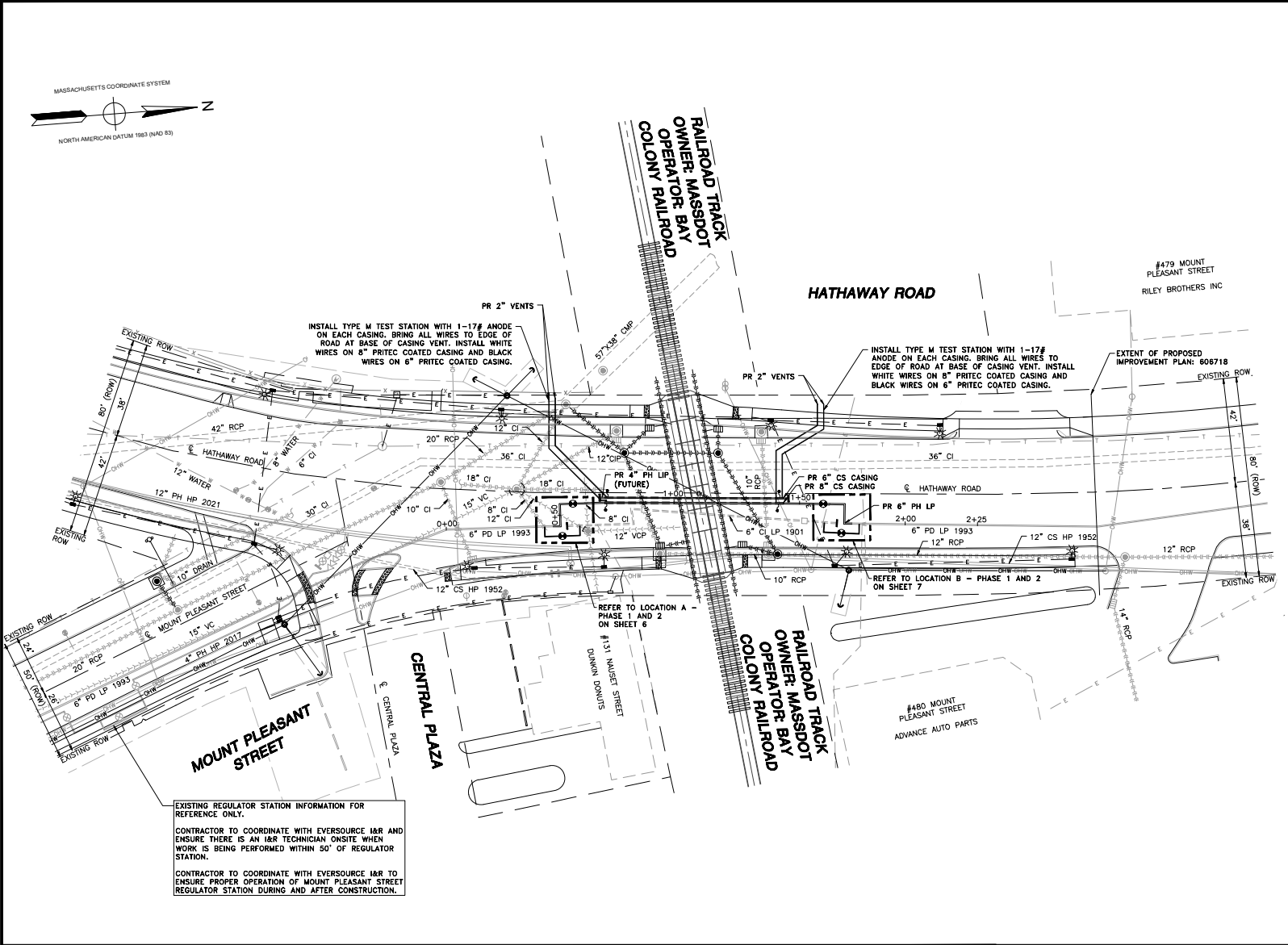

NOTES

1. REFER TO GENERAL NOTES ON SHEET #2.

2. CONTRACTOR TO POTHOLE EXISTING UTILITIES AT CROSSING LOCATIONS PRIOR TO CONSTRUCTION.

3. HDPE 4710, SDR 11 ELBOWS TO BE INSTALLED AS REQUIRED TO FACILITATE OFFSETS BASED ON FIELD CONDITIONS.

LENGTH	SIZE	MATERIAL	DESCRIPTION
70'	6"	BS	INSTALL
70'	8"	BS	INSTALL

ISSUED FOR CONSTRUCTION
03/16/2021

SEALED BY:
ERIC VINAI
No. 54771
Professional Engineer
Signature: [Signature]

SEALED ON:
03/17/2021
LICENSE EXPIRATION:
06/30/2022

DESIGNED IN ACCORDANCE WITH TITLE 46 PART 1B OF MASSACHUSETTS REGULAR SAFETY STANDARDS AND OPTIC GUIDE FOR GAS TRANSMISSION AND DISTRIBUTION PIPING SYSTEMS LATEST EDITION.
ENEngineering
28 BARKLETT STREET
MADEIRA HILLS, MA 01902
TEL: 978-393-4999
WWW.ENENGINEERING.COM

FIELD VERIFY DIMENSIONS PRIOR TO PIPE FABRICATION

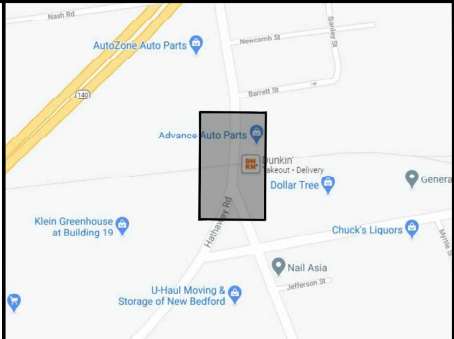

LOCUS PLAN
NOT TO SCALE

DRAWING LEGEND		
	UTILITY POLE	EXISTING GAS MAIN
	LIGHT POLE	RETIRED GAS MAIN
	CATCH BASIN	PROPOSED GAS MAIN
	FIRE HYDRANT	PROPOSED CASING
	UTILITY MANHOLE	RIGHT OF WAY
	ELECTRIC MANHOLE	ELECTRIC
	TELEPHONE MANHOLE	TELEPHONE
	WATER MANHOLE	WATER
	SANITARY MANHOLE	SANITARY SEWER
	STORM MANHOLE	STORM SEWER
	EXISTING REDUCER	PROPOSED REDUCER
	EXISTING CAP	PROPOSED CAP
	EXISTING VALVE	PROPOSED VALVE
	EXISTING COUPLING	PROPOSED ANODE

REVISION STATUS		
EVERSOURCE ENERGY		
HATHAWAY ROAD RAILROAD CROSSING NEW BEDFORD, MASSACHUSETTS		
INSTALLATION PLAN		
SCALE: 1"=20' (DO NOT SCALE FROM DRAWINGS)		
DRAWN BY / DATE LR 01/04/2021	CHECKED BY / DATE AB 03/16/2021	SHEET NUMBER MA-NEB-21-RRX-600-03
APPROVED BY / DATE EK 03/16/2021	MANEB21RRX600R0	REV. NO. 0