

APPLICATION/AGREEMENT
For Trench/Disturbance Permit within the City of New Bedford

Permit # 54 2023
Dig Safe# 20222205896
Date: 06/01/2022

TO THE MAYOR AND CITY COUNCIL: DISTURBANCE PERMIT/TRENCH SAFETY PERMIT

Permission is hereby requested to excavate the surface of: X City Property and/or X Private Property
Provide Sketch

Location of Work: 29 Clark St
Corner property with State St. Working in the street and street to house on State St side.
Emergency Gas Line Maintenance

Work will begin (weather permitting) on: June 1, 2022

Applicant Name: Steven Botelho (gk) Excavator(s) Name: _____

Company Name: Eversource Hoisting Equipment License Number: _____

Grade: _____ Expiration Date: _____

Contact Number: 339-987-8010 Name & Contact Number of Insurer: _____

Competent Person on Work Site: ON FILE APPROVED BY: Amanda Dupon DATE: July 14, 2023

TITLE: program director - permit eng

This permit shall be posted at the work site, and shall remain until the work is completed. It is subject to inspection at all times.

Permit only valid for three months
from date of approval

Trenches must be maintained
weekly until final paving is
completed

Work completed prior to D.P.I. approval under
emergency work order for Class II Leak

*Trench repair: buried trench patch must
be central line to curb for width of trench*

For any work done on City Property the following additional regulations apply:

The applicant hereby specifically acknowledges and agrees to this permit, if granted, becomes a legally binding AGREEMENT, between said applicant and the City of New Bedford for permission to disturb/excavate the surface of City sidewalks and roadways, and as such is subject to all of the terms and conditions, including current bonding and surety deposit requirements, of the various sections of Chapter 22 of the Code of Ordinances of the City of New Bedford, all of which are incorporated herein and made a part of this APPLICATION/AGREEMENT, No permit shall be granted until said terms and conditions have been met.

In the event that this permit is granted, the following requirements shall also be met:

- a. That sufficient barriers, lights, and warning signs shall be erected and maintained by the Permittee in such a manner as to notify pedestrian and/or operators of motor vehicles properly approaching the work site of the hazard(s) occasioned by said work. One or more signs conveying the following message or its equivalent: "STREET CLOSED: PASS AT OWN RISK" OR "ROAD UNDER CONSTRUCTION, PASS AT OWN RISK" must be prominently displayed as directed by the Commissioner of the Department of Public Infrastructure.
- b. That the roadways and sidewalks shall not be unnecessarily obstructed and, so far as possible, safe and convenient ways for the use of foot travelers and vehicles shall be maintained.
- c. That the trenches or excavations shall be backfilled as directed by the Commissioner of the Department of Public Infrastructure, whose orders shall be final and conclusive.
- d. All pavement surfaces of roadways and sidewalks disturbed shall be restored by the permittee in accordance with approved City specifications of the Department of Public Infrastructure, and within such time limits set by the Commissioner.
- e. The applicant assumes full responsibility for maintenance of the pavement restoration for a period of three (3) years from the date the City considers the restoration to be completed.

The applicant shall hold the City of New Bedford harmless and indemnify it for any and all injury to loss, cost, damage, expense, (including reasonable attorney fees) and liability on account of the disturbance of said street surface and any work done in connection therewith. Any permit for disturbance/excavation within the surface of the public right-of ways, as herein provided, may be revoked by the Mayor and City Council under the provision of law.

Permits for disturbing/excavating the surface of public right-of-ways shall be issued by the City Clerk, subject to ratification by the Mayor and City Council; said permits to be provisional until ratified as aforesaid. Any owner who has been refused a provisional permit shall have the right to a hearing before the Mayor and City Council.

Persons engaging in any trenching operation shall familiarize themselves with the federal safety standards promulgated by the Occupational Safety and Health Administration (OSHA) on excavations: 29 CFR 1926.650 et.seq., entitled Subpart P Excavations."

By applying for, accepting and signing this permit, the applicant attests to the following:

- a. that he has read and understood 520 CMR 14.00 promulgated by the Department of Public Safety with regard to trench safety;
- b. that he has read and understood the federal safety standards promulgated by the Occupational Safety and Health Administration on excavations: 29 CFR 1926.650 et.seq., entitled Subpart P "Excavations".

DigSafe/
CBVD
NumberADDRESS:
29 CLARK ST
TOWN:PERMIT #
NEW BEDFORD
DATE:PROJECT #
GAS-EMGGAS2Y
Unique ID : 9275328-10-[FJ16]WORK
ORDER-
TASK:
TYPE OF
WORK:GASMAINTENANCE
9275328-10
WAMCTE # 921029Contractor:
REPORT #WAMFWO:
LEAK
CLASS

WAMCTE #

PIPE RETIREMENT

FACILITY_TYPE	MATERIAL	SIZE	LENGTH	PRESSURE	VIN YR
	Bare Steel	1	35	LP	1901

PIPE INSPECTION

FACILITY TYPE	MATERIAL	SIZE	EXT PIPE COND	INT PIPE COND	INT CORR COND	COATING	DEPTH OF COVER
Main	Cast Iron	3	Poor	NA	Poor	NA	Poor

PIPE INSTALL

FACILITY TYPE	MATERIAL	SIZE	LENGTH	PRESSURE	METHOD	OVERALL PIPE LENGTH	INSTALLED/REPLACED DEPTH	CONNECTION AT MAIN	EFV INSTALLED	EFV SUBTYPE	EFV COMMENTS
Service	Plastic	1"	33'	LP	Direct Bury	60' or Less	Full Service	3' 0"	Mechanical Saddle	No	

PRESSURE TEST

MEDIUM	TYPE	START TIME	START PRESSURE(PSIG)	FINISH TIME	FINISH PRESSURE(PSIG)	TEST DURATION	PERFORMED BY	SOAP TESTED	NOTES
Air	Service below 200 ft	2022-06-01 15:20:00	100	2022-06-01 15:35:00	100	15min	Tyrone Edwards	Yes	From service tee to riser

RESTORATION

CONSTRUCTION MATERIAL	LOCATION	EXISTING SURFACE FINISH	EXISTING DEPTH	LENGTH	WIDTH	REQUIRED DEPTH	TEMPORARY REPAIR ACTION	COMPACTION METHOD	% COMPACTED
Hot Asphalt	Sidewalk	Asphalt	4	6' 0"	3' 0"	4"	DCP		95
Dirt	Private Property	Grass		8' 0"	5' 0"				
Hot Asphalt	Street	Asphalt	4	8' 0"	6' 0"	4"	DCP		96
Hot Asphalt	Street	Asphalt	4	10' 0"	3' 0"	4"	DCP		95

MATERIALS

No

DESCRIPTION OF WORK COMPLETED

Crew relayed service from riser to main

PERSONNEL

FOREMAN / WORKING LEADER / INSPECTOR

SIGNATURE:

DigSafe/ CBYD Number	PROJECT# GAS-EMGASZY	Unique ID :	9275328-10-[F]16]
ADDRESS: 29 CLARK ST	TOWN: NEW BEDFORD	DATE: 06/01/22	ORDER- WORK TASK: 9275328-10
URL: http://CWV-CLKSOPRDI/Repository/Files/cdv photo 001 090651(ZOXDNDIK).jpg	LEAK REPORT #	LEAK CLASS	WAMFWO: 30353428
SHEET 2 of 3	Contractor:		# WAMCTE 921029

6:27 PM Wed Jun 1



4 LTE 38%

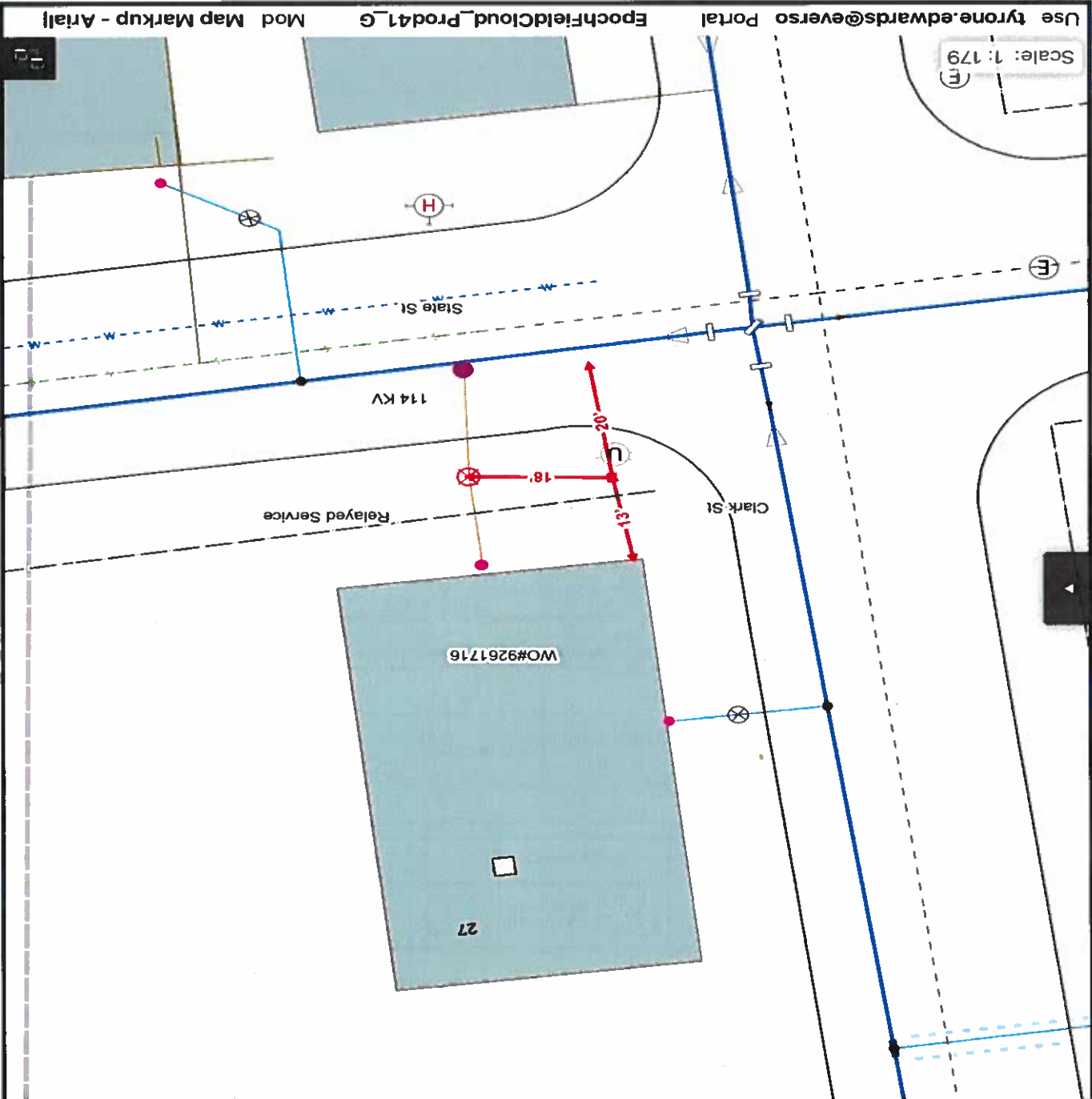

EVERSOURCE		CTE UNIT LINES	
No Data Available		PERMITS	
No Data Available		OTHER ATTACHMENTS	
No Data Available			

