

APPLICATION/AGREEMENT  
For Trench/Disturbance Permit within the City of New Bedford

Permit # 206-2023  
Dig Safe# 20231509124  
Date: 4/12/23

TO THE MAYOR AND CITY COUNCIL: DISTURBANCE PERMIT/TRENCH SAFETY PERMIT

Permission is hereby requested to excavate the surface of : X City Property and/or X Private Property  
Provide Sketch

Location of Work: 32 Charlotte St.

Hathaway Rd. - Jay Road

Gas Service Retirement

Work will begin (weather permitting) on: April 26, 2023

Applicant Name: Steven Botelho (ra) Excavator(s) Name: \_\_\_\_\_

Company Name: Eversource Hoisting Equipment License Number: \_\_\_\_\_

Grade: \_\_\_\_\_ Expiration Date: \_\_\_\_\_

Contact Number: 508-441-5817 Name & Contact Number of Insurer: \_\_\_\_\_

Competent Person on Work Site: ON FILE APPROVED BY: Amanda Lujan DATE: April 21, 2023

TITLE: program director - permit eng

**This permit shall be posted at the work site, and shall remain until the work is completed. It is subject to inspection at all times.**

Final Trench Restoration: Trench must be laid and maintained in accordance with the current City of New Bedford standards and specifications

Trenches must be maintained weekly until final paving is completed

ROADWAY CLOSURES WILL REQUIRE AUTHORIZATION FROM THE COMMISSIONER OF PUBLIC INFRASTRUCTURE. TRAFFIC MANAGEMENT PLANS MAY BE REQUIRED.

Permit only valid for three months from date of approval

B	37' 0.5" PY 2007
A	6' 0.5" PY 2007

B 41' 0.5"  
A 20' 0.5"

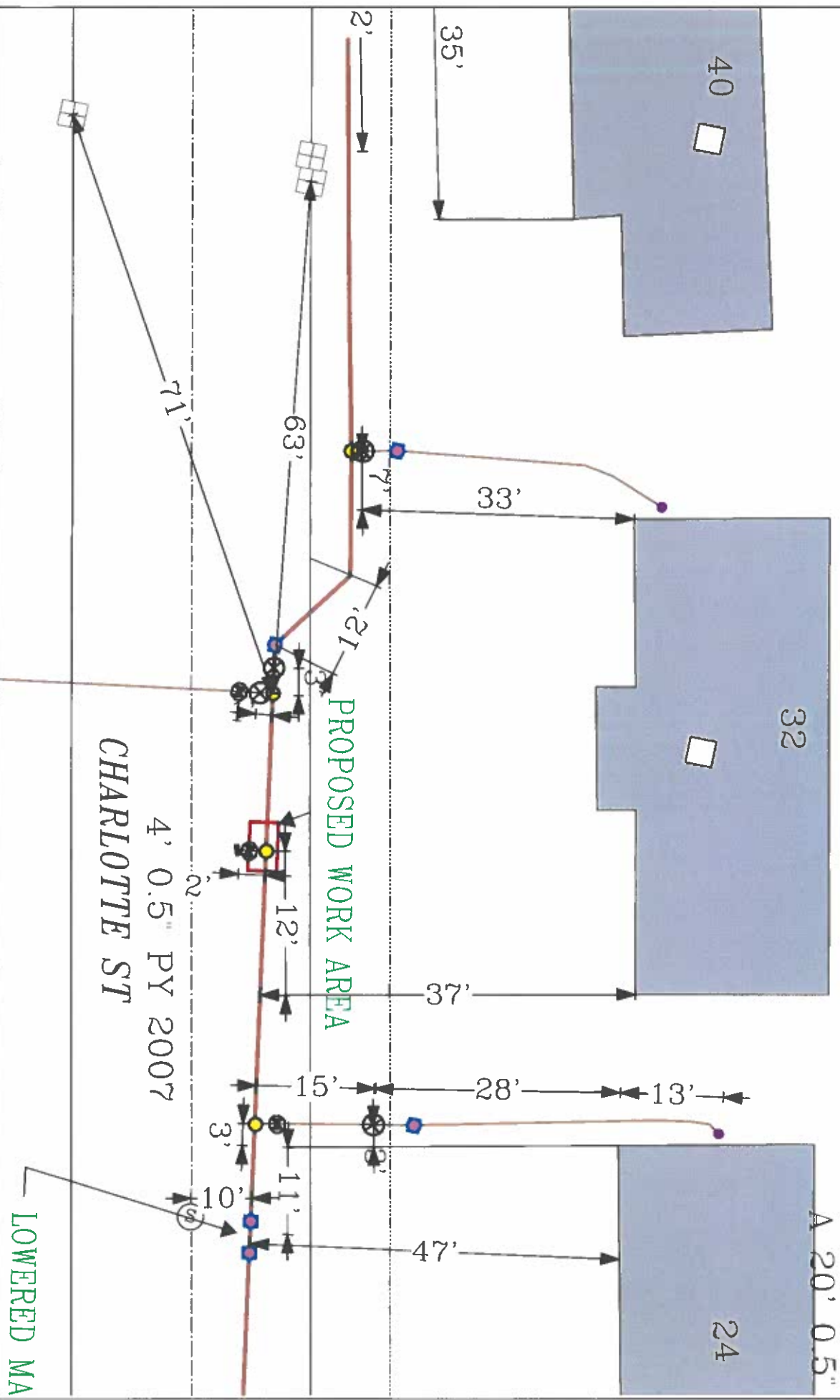

**EVERSOURCE**

**EVERSOURCE NA GAS**  
One NSTAR Way  
Westwood, MA 02090  
Phone 1-800-592-2000



MASS LAW

Call Dig-Safe: 811

**IMPORTANT - DO NOT SCALE**

This drawing provides approximate locations only and all facility information may not be shown. Contact EPI@SOURDIS.MA.GOV to have specific field information identified. EPI@SOURDIS.MA.GOV disclaims any liability resulting from the reliance by any person on the location shown on this map. Massachusetts law requires that any person performing excavation work contact Dig-Date so that the location of any underground may be marked.

**Address:** 32 Charlotte St

City/Town: New Bedford

Date Plotted: 03/24/2023