

APPLICATION/AGREEMENT
For Trench/Disturbance Permit within the City of New Bedford

Permit # 224-2023
Dig Safe# 20231605065
Date: 4/18/23

TO THE MAYOR AND CITY COUNCIL: DISTURBANCE PERMIT/TRENCH SAFETY PERMIT

Permission is hereby requested to excavate the surface of: X City Property and/or X Private Property
Provide Sketch

Location of Work: 251 Whimman St.

Ashley Blvd. - Brook St.

Relay Gas Service

Work will begin (weather permitting) on: May 2, 2023

Applicant Name: Steven Botelho (ra) Excavator(s) Name: _____

Company Name: Eversource Hoisting Equipment License Number: _____

Grade: _____ Expiration Date: _____

Contact Number: 508-441-5817 Name & Contact Number of Insurer: _____

Competent Person on Work Site: ON FILE APPROVED BY: Shonda J. Fox DATE: Apr 18, 2023

TITLE: excavation - front lug

This permit shall be posted at the work site, and shall remain until the work is completed. It is subject to inspection at all times.

ROADWAY CLOSURES WILL REQUIRE
AUTHORIZATION FROM THE
COMMISSIONER OF PUBLIC
INFRASTRUCTURE. TRAFFIC MANAGEMENT
PLANS MAY BE REQUIRED.

Permit only valid for three months
from date of approval

**Trenches must be maintained
weekly until final paving is
completed**

Final Trench Restoration: Trench must be laid and
maintained in accordance with the current City of
New Bedford standards and specifications

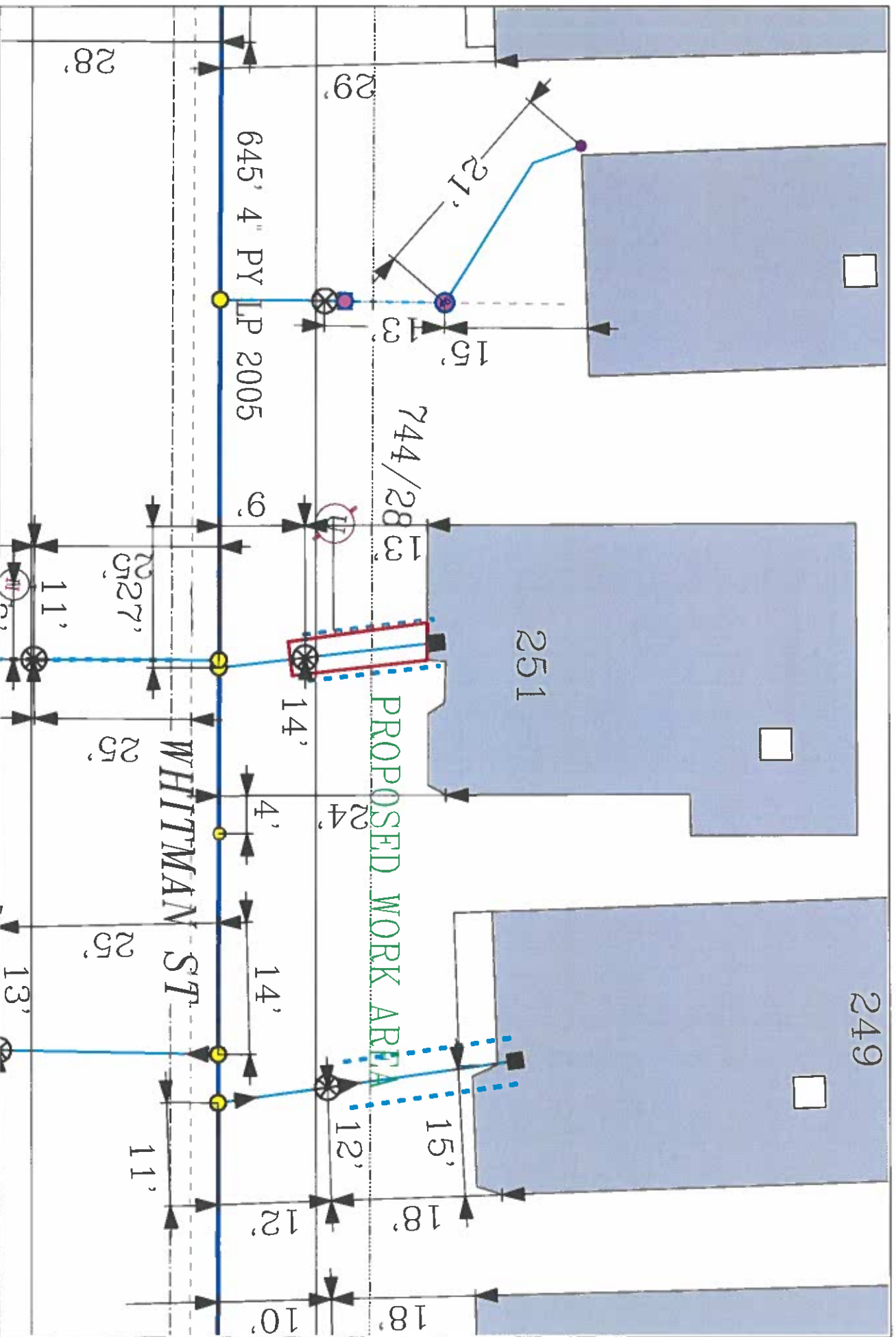

EVERSOURCE
 EVERSOURCE MA GAS
 678 STATE ST
 BEDFORD, MA 01730
 Phone 1-800-692-2000



MASS LAW
 No liability for injury or damage
 unless the utility operator
 is negligent or reckless
 Call Dig-Safe: 811

IMPORTANT - DO NOT SCALE
 This drawing provides approximate locations only and all facility information
 must be verified by field inspection. Eversource MA Gas does not warrant the
 information be identified. Eversource MA Gas disclaims liability from
 the reliance by any person on the location shown on this map. Massachusetts
 law requires that any person performing excavation work contact Dig-Safe so
 that the location of any underground may be marked.

Address: 261 Whitman St
 City/Town: New Bedford