

APPLICATION/AGREEMENT
For Trench/Disturbance Permit within the City of New Bedford

Permit # 190-2023
Dig Safe# 20231408886
Date: 4/5/23

TO THE MAYOR AND CITY COUNCIL: DISTURBANCE PERMIT/TRENCH SAFETY PERMIT

Permission is hereby requested to excavate the surface of: X City Property and/or X Private Property
Provide Sketch

Location of Work: 1089 Chaffee St.
Oswald St. - Ashley Blvd.
Relay Gas Service

Work will begin (weather permitting) on: April 19, 2023

Applicant Name: Steven Botelho (ra) Excavator(s) Name: _____

Company Name: Eversource Hoisting Equipment License Number: _____

Grade: _____ Expiration Date: _____

Contact Number: 508-441-5817 Name & Contact Number of Insurer: _____

Competent Person on Work Site: ON FILE

APPROVED BY: Shirley J. J. J. J. DATE: April 11, 2023
TITLE: program director - permit org

This permit shall be posted at the work site, and shall remain until the work is completed. It is subject to inspection at all times.

ROADWAY CLOSURES WILL REQUIRE
AUTHORIZATION FROM THE
COMMISSIONER OF PUBLIC
INFRASTRUCTURE. TRAFFIC MANAGEMEN
PLANS MAY BE REQUIRED.

Permit only valid for three months
from date of approval

**Trenches must be maintained
weekly until final paving is
completed**

Final Trench Restoration: Trench must be laid and
maintained in accordance with the current City of
New Bedford standards and specifications

38' 1.5" ST 1995

43' 1.0" PL 1996

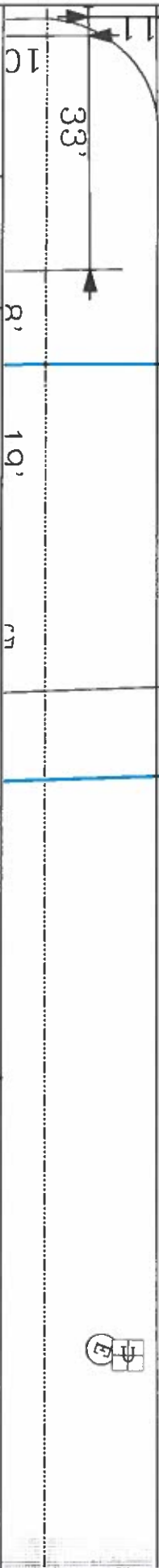
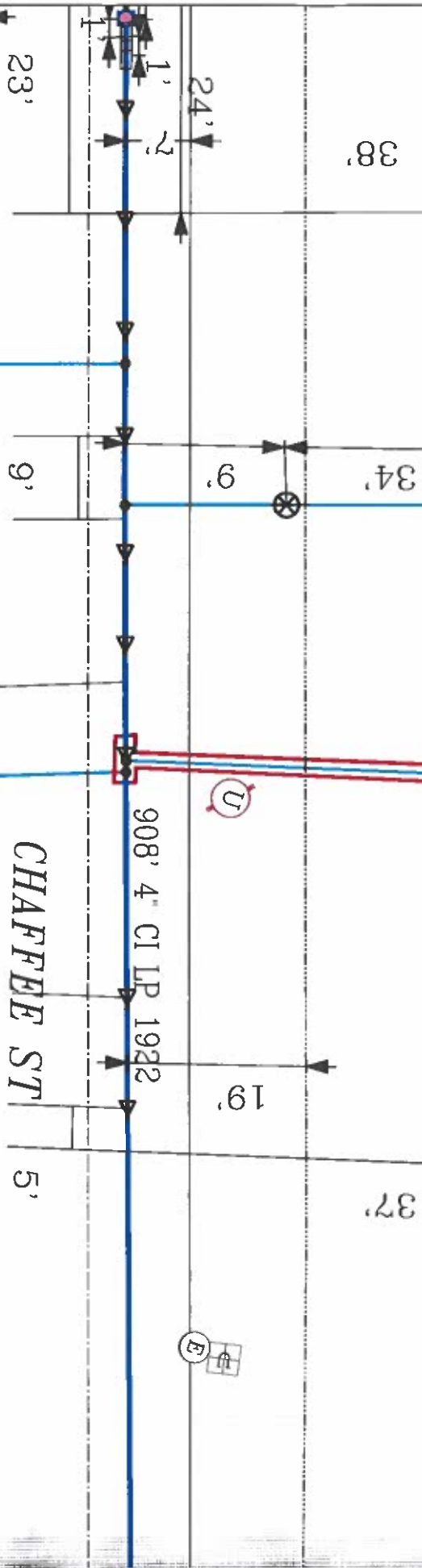
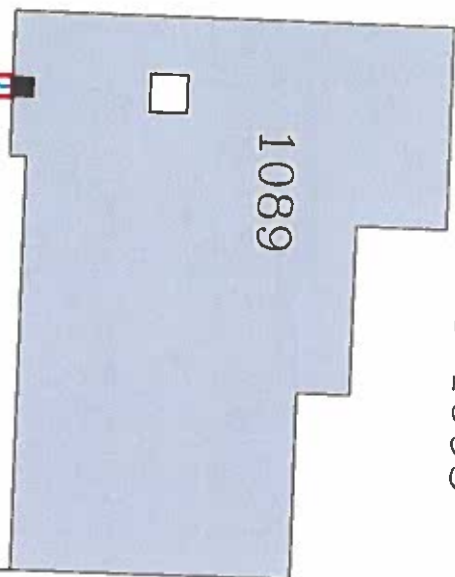
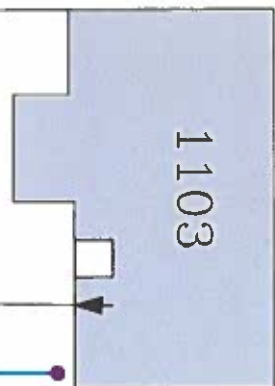

EVERSOURCE

EVERSOURCE MA GAS
One NSTAR Way
Bedford, MA 02090
Phone 1-800-382-2000

MASB LAW

Subject to the provisions
of the Massachusetts
Public Utilities Code,
as amended by Chapter
127A, § 10.

Call Dig-Safe: 811

IMPORTANT - DO NOT SCALE

This drawing provides approximate locations only and all facility information may not be shown. Contact EVERSOURCE MA GAS to have specific field information identified. EVERSOURCE MA GAS disclaims any liability resulting from the reliance by any person on the location shown on this map. EVERSOURCE MA GAS is not responsible for any damage or injury resulting from the use of this map. EVERSOURCE MA GAS is not responsible for any damage or injury resulting from the use of this map. EVERSOURCE MA GAS is not responsible for any damage or injury resulting from the use of this map.

Address: 1089 Chaffee St

City/Town: New Bedford

Date Plotted: 04/04/2023