

APPLICATION/AGREEMENT

For Trench/Disturbance Permit within the City of New Bedford

Permit # 179 2023

Dig Safe# 20231403868

Date: 4/4/23

TO THE MAYOR AND CITY COUNCIL:

DISTURBANCE PERMIT/TRENCH SAFETY PERMIT

Permission is hereby requested to excavate the surface of: X City Property and/or X Private Property

Provide Sketch

Location of Work: 9 Mount Pleasant Ln.

Mount Pleasant St. - Vine St.

Relay Gas Service

Work will begin (weather permitting) on: April 18, 2023

Applicant Name: Steven Botelho (ra)

Excavator(s) Name: _____

Company Name: Eversource

Hoisting Equipment License Number: _____

Grade: _____ Expiration Date: _____

Contact Number: 508-441-5817

Name & Contact Number of Insurer: _____

Competent Person on Work Site: ON FILE

APPROVED BY: Marcinda J. Garcia DATE: April 6, 2023

TITLE: Regan Driver - Permit org

This permit shall be posted at the work site, and shall remain until the work is completed. It is subject to inspection at all times.

Permit only valid for three months
from date of approval

ROADWAY CLOSURES WILL REQUIRE
AUTHORIZATION FROM THE
COMMISSIONER OF PUBLIC
INFRASTRUCTURE. TRAFFIC MANAGEMENT
PLANS MAY BE REQUIRED.

**Trenches must be maintained
weekly until final paving is
completed**

Final Trench Restoration. Trench must be laid and
maintained in accordance with the current City of
New Bedford standards and specifications

13' 1.0" PL 1995

32' 1.0" PL 1995

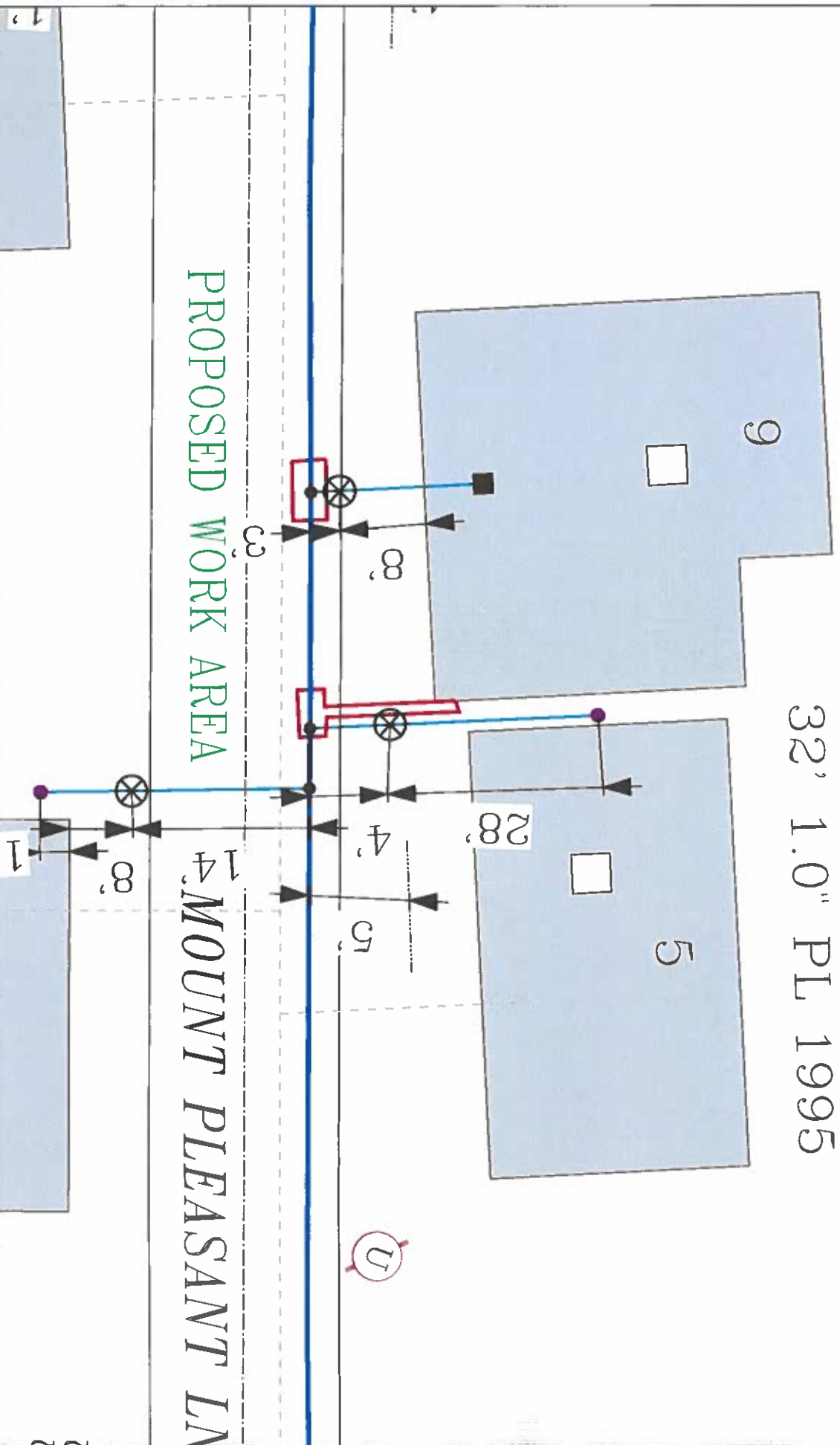

EVERSOURCE

EVERSOURCE MA GAS
One NSTAR Way
Bedford, MA 02090
Phone 1-800-582-2000

MASS LAW

Regulating the manner and
location of utility construction
before digging by anyone

Call Dig-Safe: 811

IMPORTANT - DO NOT SCALE

This drawing provides approximate locations only and all facility information
may not be shown. Contact EVERSOURCE MA GAS to have specific field
information identified. EVERSOURCE MA GAS disclaims any liability resulting from
the reliance by any person on the location shown on this map. Massachusetts
law requires that any person performing excavation work contact Dig-Safe so
that the location of any underground may be marked.

Address: 9 Mount Pleasant Ln

City/Town: New Bedford

Date Plotted: 04/03/2023