

APPLICATION / AGREEMENT  
For DISTURBANCE PERMIT within the City of New Bedford

Permit # 124-2023

Dig Safe # \_\_\_\_\_

Date Issued: February 27, 2023

**This permit shall be posted at the work site, and shall remain until the work is completed. It is subject to inspection at all times.**

TO THE MAYOR AND CITY COUNCIL: X DISTURBANCE PERMIT

Permission is hereby requested to excavate the surface of: X City Property

Location of work: State Street, Purchase Street and County Street (underneath 195 bridge)

Substantially as per plan annexed, for the purpose of: test borings in city layout on County St  
between Cedar Grove St and Pennuman St

Work will begin (weather permitting) on: 03-06-2023

Work will end (weather permitting) on: 03-31-2023

Applicant Name: Nehorah A. Grey

Company Name: Geologic Earth Exploration, Inc.

Excavator(s) Name: \_\_\_\_\_

Hoisting Equipment License Number: \_\_\_\_\_

Grade: \_\_\_\_\_ Expiration Date: \_\_\_\_\_

Contact Name: \_\_\_\_\_

Name & Contact Number of Insurer: Rogers Grey 508-746-3311

Approved By: Amanda Gupin Date: March 2, 2023

Title: program director - permit eng.

Roadway closures will require authorization from the Commissioner of Public Infrastructure.

Traffic management plans may be required.

For inspection, 24 hour notice is required and the Contractor / Applicant is required to

notify the D.P.I. @ 508-979-1550 Press 4 Repair. Permit Expires in 3 Months from work start date.

Provide Sketch

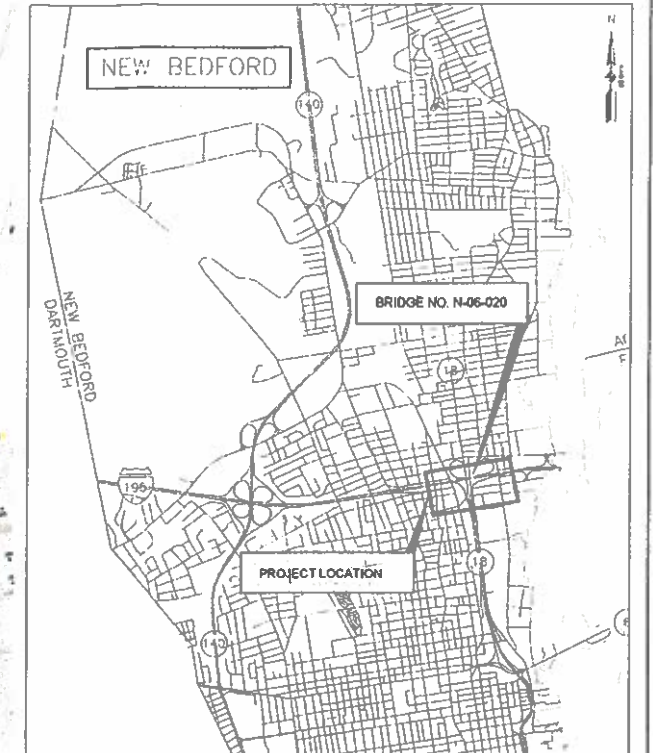

#### LOCUS MAP

#### NOTES

1. LOCATION OF BORINGS ARE SHOWN THUS:  $\odot$  TT-01
2. SEE THE BORING LOCATIONS TABLE FOR THE SPECIFIED HIGHEST BOTTOM ELEVATION (B.B.E.) OF EACH BORING.
3. FOR TYPICAL TEST BORINGS, BORINGS SHALL EXTEND TO THE SPECIFIED HIGHEST BOTTOM ELEVATION OR TO REFUSAL IF BEDROCK IS ENCOUNTERED ABOVE THE B.B.E.
4. FOR TEST BORINGS WHERE ROCK CORES ARE INDICATED, THE BORING SHALL EXTEND TO WHATEVER DEPTH IS ENCOUNTERED, THE BORING SHALL BE CONTINUED AS A ROCK CORE BORING FOR A DEPTH OF 10 FT., THEN TERMINATED. TEST BORINGS SHALL NOT EXTEND MORE THAN 50 FT. ROCK CORE LOCATIONS MAY BE SHIPPED BASED ON ACCESS REQUIREMENTS, CONVICTION OF TESSAH OR OTHER FACTORS.
5. STANDARD SPLIT SPOON SAMPLING AT SURFACE AND 5 FT. INTERVALS SHALL BE TAKEN. ADDITIONAL BEDROCK SAMPLES SHALL BE COLLECTED FOR LAB TESTING AT BORING DEPTHS SPECIFIED BY THE ENGINEER.
6. TEST BORINGS TO BE BACKFILLED WITH CUTTINGS AND IF NECESSARY CLEAN SAND. CLOSURE PATCH TO BE USED WHEN TEST BORING IS THROUGH ROADWAY SURFACE.
7. BORINGS ARE LOCATED BY SCALES FROM EXISTING FEATURES ON THE PLAN. LOCATIONS MAY BE ADJUSTED BASED ON ACCESS REQUIREMENTS, CONVICTION OF TERRAIN, EFFORTS TO MAINTAIN A 50 FT. OFFSET FROM RAILROAD CENTERLINE OR OTHER FACTORS.
8. ADDITIONAL BORINGS MAY BE REQUESTED BY THE ENGINEER, IF NECESSARY.
9. EXISTING PLANNED LOCATIONS FOR PAVEMENT CORES ARE SHOWN FOR REFERENCE ONLY AND MAY BE ADJUSTED. PAVEMENT CORES ARE SHOWN THUS:  $\odot$

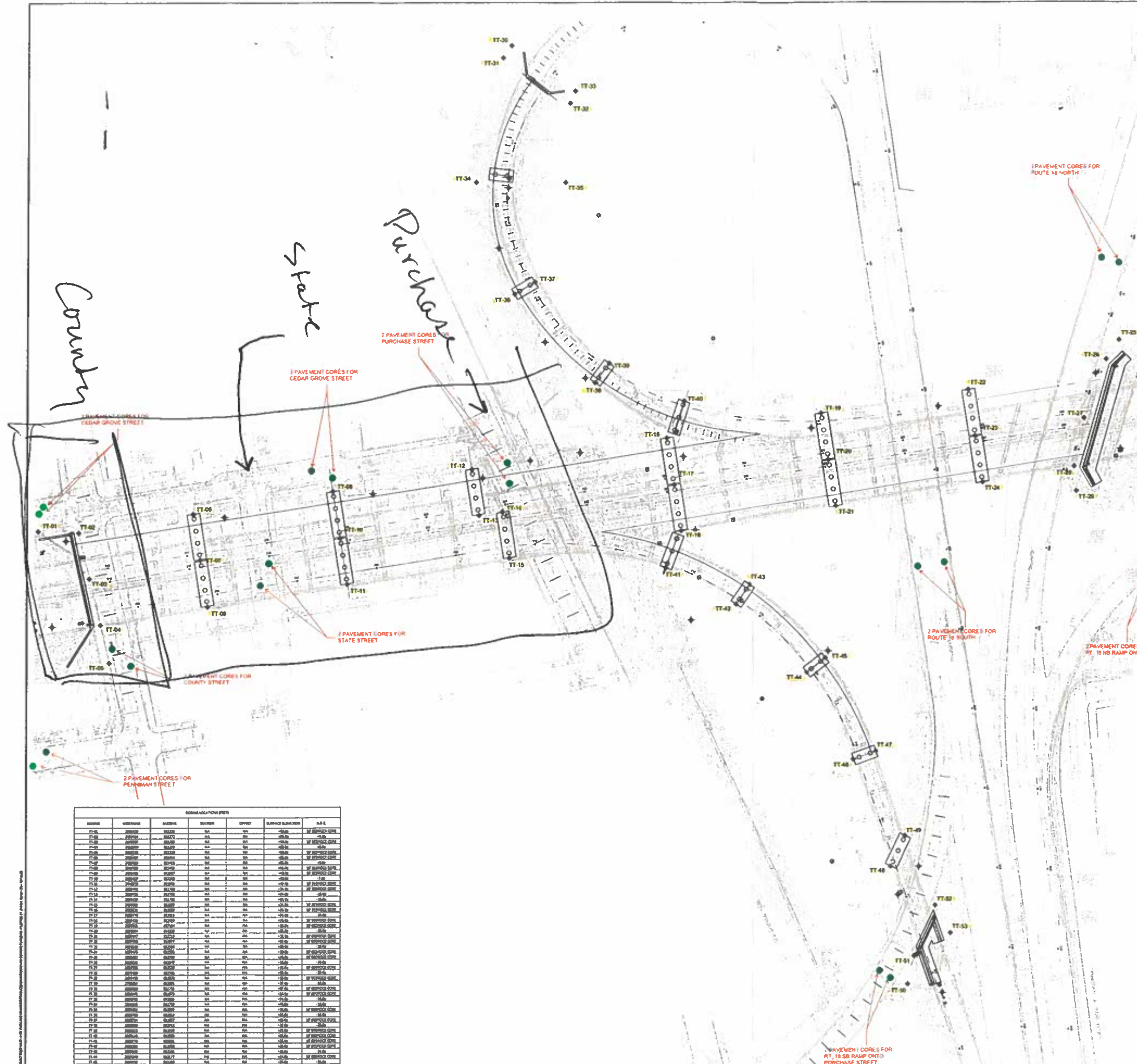

BORING LOCATION DATA						
BORING	UTM E	UTM N	UTM ZONE	UTM OFFSET	BOTTOM ELEVATION	B.B.E.
TT-01	180000	5500000	18N	0	-1.50	SEE BORING LOG
TT-02	180000	5500000	18N	0	-1.50	SEE BORING LOG
TT-03	180000	5500000	18N	0	-1.50	SEE BORING LOG
TT-04	180000	5500000	18N	0	-1.50	SEE BORING LOG
TT-05	180000	5500000	18N	0	-1.50	SEE BORING LOG
TT-06	180000	5500000	18N	0	-1.50	SEE BORING LOG
TT-07	180000	5500000	18N	0	-1.50	SEE BORING LOG
TT-08	180000	5500000	18N	0	-1.50	SEE BORING LOG
TT-09	180000	5500000	18N	0	-1.50	SEE BORING LOG
TT-10	180000	5500000	18N	0	-1.50	SEE BORING LOG
TT-11	180000	5500000	18N	0	-1.50	SEE BORING LOG
TT-12	180000	5500000	18N	0	-1.50	SEE BORING LOG
TT-13	180000	5500000	18N	0	-1.50	SEE BORING LOG
TT-14	180000	5500000	18N	0	-1.50	SEE BORING LOG
TT-15	180000	5500000	18N	0	-1.50	SEE BORING LOG
TT-16	180000	5500000	18N	0	-1.50	SEE BORING LOG
TT-17	180000	5500000	18N	0	-1.50	SEE BORING LOG
TT-18	180000	5500000	18N	0	-1.50	SEE BORING LOG
TT-19	180000	5500000	18N	0	-1.50	SEE BORING LOG
TT-20	180000	5500000	18N	0	-1.50	SEE BORING LOG
TT-21	180000	5500000	18N	0	-1.50	SEE BORING LOG
TT-22	180000	5500000	18N	0	-1.50	SEE BORING LOG
TT-23	180000	5500000	18N	0	-1.50	SEE BORING LOG
TT-24	180000	5500000	18N	0	-1.50	SEE BORING LOG
TT-25	180000	5500000	18N	0	-1.50	SEE BORING LOG
TT-26	180000	5500000	18N	0	-1.50	SEE BORING LOG
TT-27	180000	5500000	18N	0	-1.50	SEE BORING LOG
TT-28	180000	5500000	18N	0	-1.50	SEE BORING LOG
TT-29	180000	5500000	18N	0	-1.50	SEE BORING LOG
TT-30	180000	5500000	18N	0	-1.50	SEE BORING LOG
TT-31	180000	5500000	18N	0	-1.50	SEE BORING LOG
TT-32	180000	5500000	18N	0	-1.50	SEE BORING LOG
TT-33	180000	5500000	18N	0	-1.50	SEE BORING LOG
TT-34	180000	5500000	18N	0	-1.50	SEE BORING LOG
TT-35	180000	5500000	18N	0	-1.50	SEE BORING LOG
TT-36	180000	5500000	18N	0	-1.50	SEE BORING LOG
TT-37	180000	5500000	18N	0	-1.50	SEE BORING LOG
TT-38	180000	5500000	18N	0	-1.50	SEE BORING LOG
TT-39	180000	5500000	18N	0	-1.50	SEE BORING LOG
TT-40	180000	5500000	18N	0	-1.50	SEE BORING LOG
TT-41	180000	5500000	18N	0	-1.50	SEE BORING LOG
TT-42	180000	5500000	18N	0	-1.50	SEE BORING LOG
TT-43	180000	5500000	18N	0	-1.50	SEE BORING LOG
TT-44	180000	5500000	18N	0	-1.50	SEE BORING LOG
TT-45	180000	5500000	18N	0	-1.50	SEE BORING LOG
TT-46	180000	5500000	18N	0	-1.50	SEE BORING LOG
TT-47	180000	5500000	18N	0	-1.50	SEE BORING LOG
TT-48	180000	5500000	18N	0	-1.50	SEE BORING LOG
TT-49	180000	5500000	18N	0	-1.50	SEE BORING LOG
TT-50	180000	5500000	18N	0	-1.50	SEE BORING LOG

#### KEY PLAN



**massDOT**  
BORING PLAN OF  
PROPOSED BRIDGE REPLACEMENT  
**NEW BEDFORD**  
1-195, RAMP C & F OVER COUNTY ST.,  
STATE STREET, PURCHASE STREET,  
RTE. 18 & MASS. COASTAL RAILROAD  
MASSACHUSETTS DEPARTMENT OF TRANSPORTATION  
HIGHWAY DIVISION  
SCALE: 1" = 40'-0" FEBRUARY, 2023  
BRIDGE NO. N-06-020