

APPLICATION/AGREEMENT

Permit # 12-2023

For Trench/Disturbance Permit within the City of New Bedford

Dig Safe: 20225104254

Date: 12/21/2022

TO THE MAYOR AND CITY COUNCIL:

DISTURBANCE PERMIT/TRENCH SAFETY PERMIT

Permission is hereby requested to excavate the surface of: X City Property and/or X Private Property

Provide Sketch

Location of Work: Harmony St.

Wking from Social St. to Brock Ave. (including intersections)

Relay Gas Main & Services

Trenches must be maintained
weekly until final paving is
completed

Work will begin (weather permitting) on: January 4, 2022

Applicant Name: Thomas Costa (ra)

Excavator(s) Name: _____

Company Name: Eversource

Hoisting Equipment License Number: _____

Grade: _____ Expiration Date: _____

Contact Number: 508-441-5143

Name & Contact Number of Insurer: _____

Competent Person on Work Site: ON FILE

APPROVED BY: Stephen Cupito DATE: 1-12-2023

TITLE: Asst. City Engineer

This permit shall be posted at the work site, and shall remain until the work is completed. It is subject to inspection at all times.

ROADWAY CLOSURES WILL REQUIRE
AUTHORIZATION FROM THE
COMMISSIONER OF PUBLIC
INFRASTRUCTURE. TRAFFIC MANAGEMENT
PLANS MAY BE REQUIRED.

PATCH REPAIR: Curb line to center of roadway.

Adjust structures as needed. All existing wheelchair
ramps abutting the final paving must be ADA
compliant and built in accordance with City of New
Bedford's Construction Standards. Wheelchair
ramps must be installed prior to final paving.

Permit only valid for six months
from date of approval

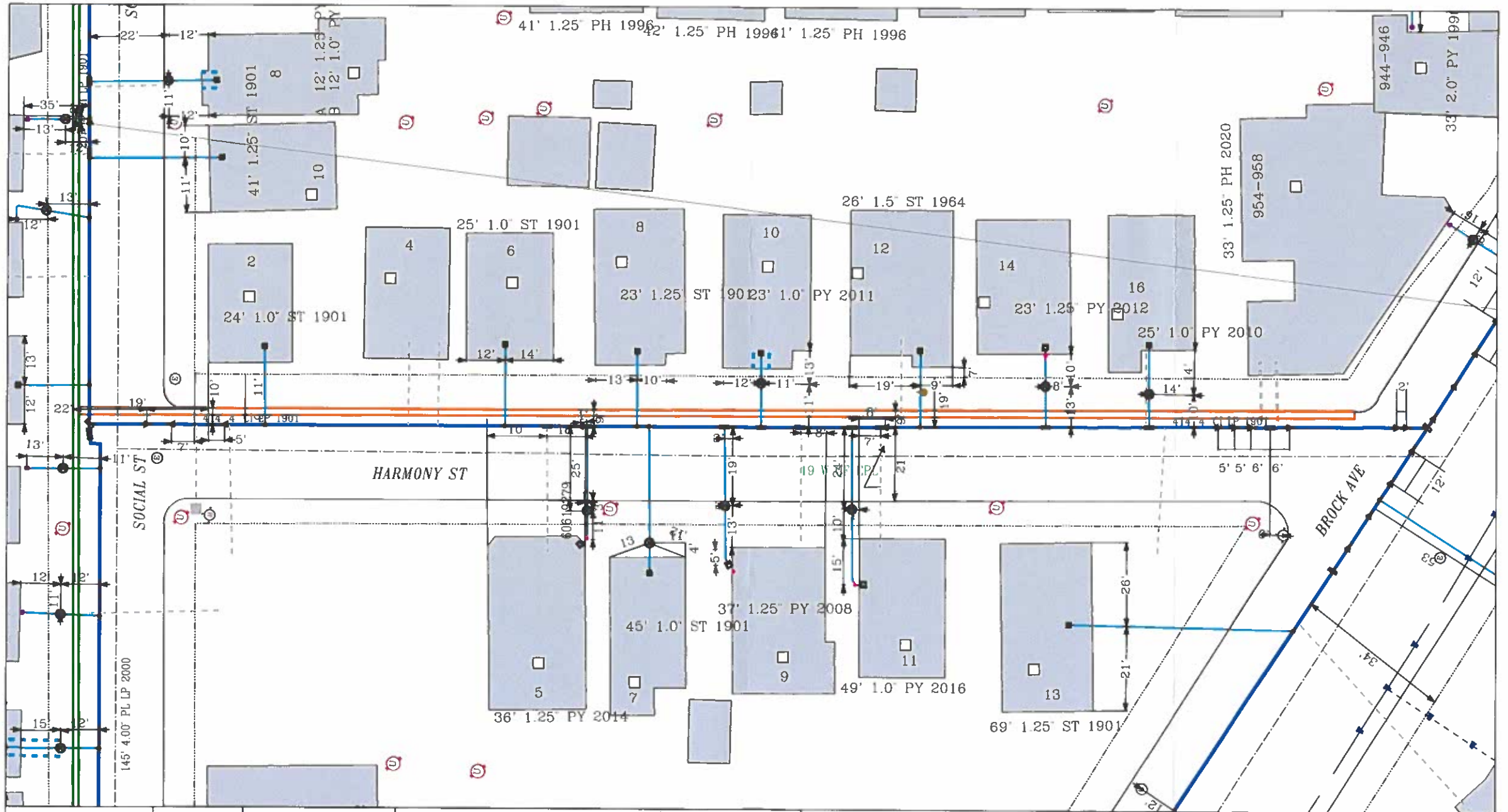

EVERSOURCE	<div style="text-align: center;">  <p>MASS LAW</p> <p><small>Regulated by the Massachusetts Department of Energy Resources</small></p> <p>Call Dig-Safe: 811</p> </div>	<p>IMPORTANT – DO NOT SCALE</p> <p><small>This drawing provides approximate locations only and all facility information may not be shown. Contact Eversource MA Gas to have specific field information identified. Eversource MA Gas disclaims any liability resulting from reliance by any on the location shown on this map. Measurements are required. Mark any location prior to performing excavation work essential. Dig-safe is not responsible for the location of any underground may be marked.</small></p>	<p>Address: Harmony St</p> <p>City / Town: New Bedford</p>
-------------------	--	--	--

EVERSOURCE MA GAS
One NSTAR Way
Westwood, MA 02090
Phone 1-800-592-2000

Date Plotted: 12/19/2022