

APPLICATION/AGREEMENT

For Trench/Disturbance Permit within the City of New Bedford

Permit # 119-2023Dig Safe# 20230706931Date: 2/16/23

TO THE MAYOR AND CITY COUNCIL:

DISTURBANCE PERMIT/TRENCH SAFETY PERMIT

Permission is hereby requested to excavate the surface of: X City Property and/or X Private Property
Provide SketchLocation of Work: 268-270 Maple St.Brownell St. - (Wking on Brownell St. side) - Huston StRelay Gas ServiceWork will begin (weather permitting) on: March 2, 2023Applicant Name: Steve Botelho (ra)

Excavator(s) Name: _____

Company Name: Eversource

Hoisting Equipment License Number: _____

Grade: _____ Expiration Date: _____

Contact Number: 508-441-5817

Name & Contact Number of Insurer: _____

Competent Person on Work Site: ON FILEAPPROVED BY: Shirley J. Poirier DATE: Feb. 28, 2023TITLE: program director - permit sig**This permit shall be posted at the work site, and shall remain until the work is completed. It is subject to inspection at all times.**ROADWAY CLOSURES WILL REQUIRE
AUTHORIZATION FROM THE
COMMISSIONER OF PUBLIC
INFRASTRUCTURE. TRAFFIC MANAGEMENT
PLANS MAY BE REQUIRED.Trenches must be maintained
weekly until final paving is
completedFinal Trench Restoration: Trench must be laid and
maintained in accordance with the current City of
New Bedford standards and specificationsPermit only valid for three months
from date of approvalFinal Trench Restoration: Final patch to be one large
patch that includes new service install and cut and cap
service. Not to be two separate patches

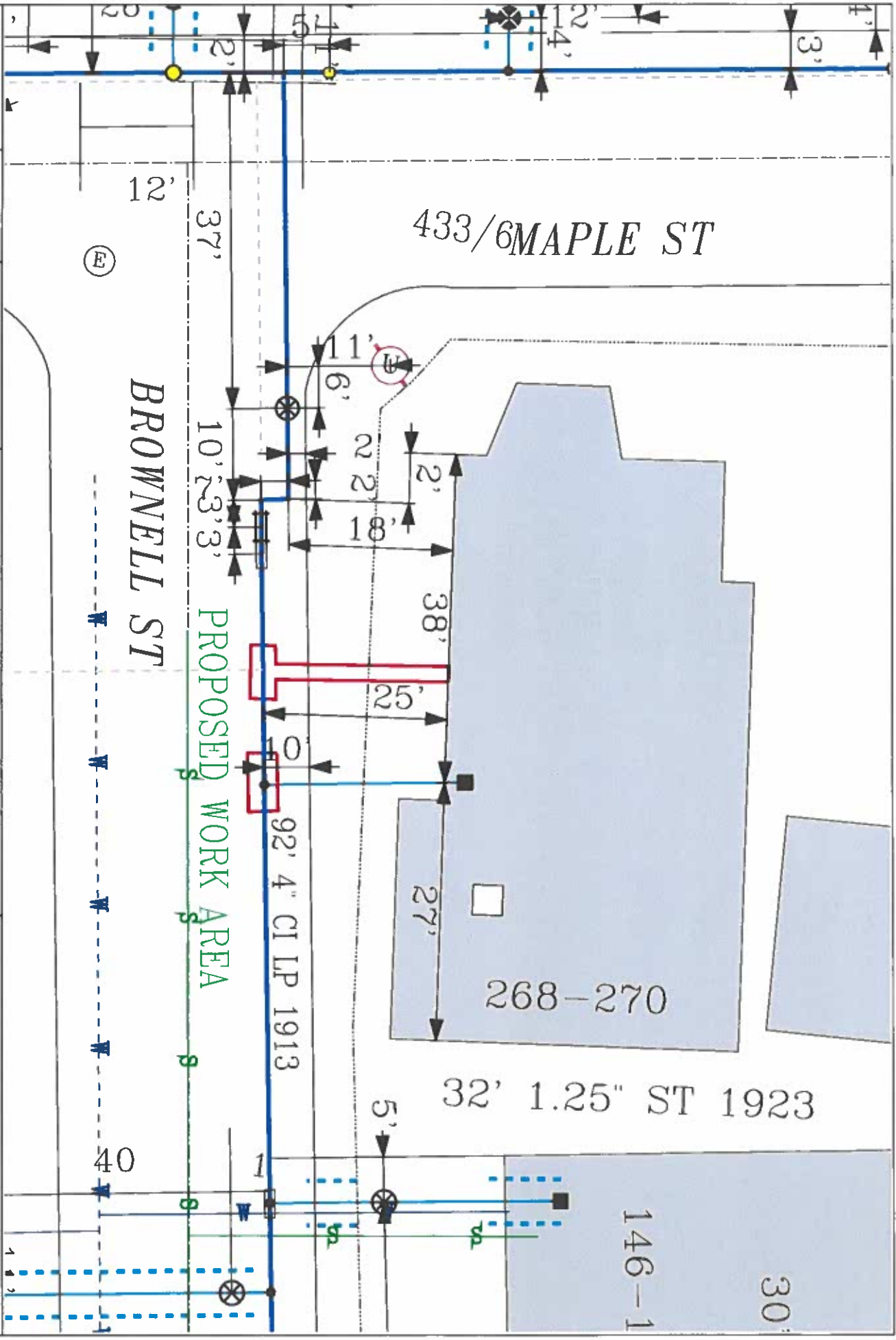

EVERSOURCE

EVERSOURCE MA GAS
One NSTAR way
Bedford, MA 02090
Phone 1-800-952-2000

MASB LAW

Resolving 72-hour advance
notice to utility companies
before digging by anyone

Call Dig-Safe: 811

IMPORTANT - DO NOT SCALE

This drawing provides approximate locations only and all facility information
may not be shown. Contact EVERSOURCE MA GAS to have specific field
information identified. EVERSOURCE MA GAS disclaims any liability resulting from
any use of this drawing on any project. On any project, all map users must
have suitable field equipment and personnel to contact Dig-Safe so
that the location of any underground may be marked.

Address: 268-270 Maple St

City/Town: New Bedford

Date Plotted: 02/15/2023