

APPLICATION / AGREEMENT
For DISTURBANCE PERMIT within the City of New Bedford

Permit # 105-2023

Dig Safe # 26230802285

Date Issued: February 21, 2023

This permit shall be posted at the work site, and shall remain until the work is completed. It is subject to inspection at all times.

TO THE MAYOR AND CITY COUNCIL: ☒ DISTURBANCE PERMIT

Permission is hereby requested to excavate the surface of: ☒ City Property

Location of work: Intersection of Brownell Avenue & Richfield Street

Substantially as per plan annexed, for the purpose of: Installing electrical conduit for Buttonwood Park Zoo

Work will begin (weather permitting) on: 2-27-23

Work will end (weather permitting) on: 5-27-23

Applicant Name: _____

Company Name: Frank Corp. Environmental Services

Excavator(s) Name: Kirk Franklin

Hoisting Equipment License Number: HE-076597

Grade: 2A Expiration Date: 9-6-24

Contact Name: Kevin Rocha

Name & Contact Number of Insurer: Smithwick & Mariners 207-791-5553

Approved By: Dennis M. Amador Date: 2/24/2023

Title: Admin Manager

Roadway closures will require authorization from the Commissioner of Public Infrastructure.

Traffic management plans may be required.

For inspection, 24 hour notice is required and the Contractor / Applicant is required to notify the D.P.I. @ 508-979-1550 Press 4 Repair. Permit Expires in 3 Months from work start date.

Provide Sketch

Attached

Service Address: BROWNELL AVE & RICHFIELD ST	City: NEW BEDFORD	Page Number: 2 of 2 Pages	Auth. No.	Work Order Number: 10350696
Customer's Name/Title: CITY OF NEW BEDFORD		Prepared by: JOSEPH PASTERIS		Date: 12SEP22
Sales Representative: BRIAN MELLO	RELOC OH TO UG SVC PG2		Circuit Number: 2-72-501	
Electrician: CITY OF NEW BEDFORD (508) 979-1530			TLM: 290714	
Switch Size: 15T			Secondary Sheet Number:	

AT PRIVATE POLE 1209/X1

EVERSOURCE WORK
REMOVE EXISTING 50KVA OH TRANSFORMER

1/23-S

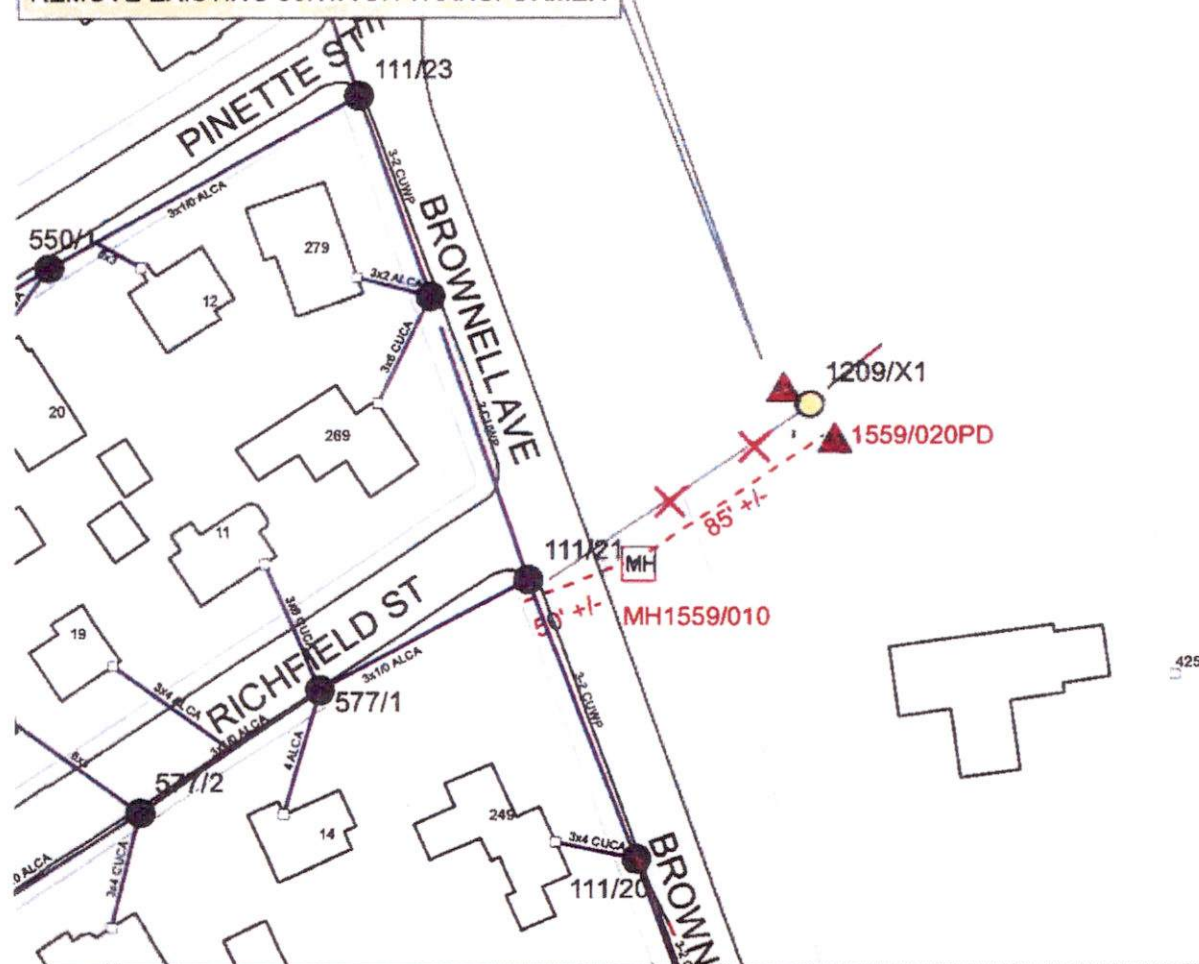

CUSTOMER WORK-

SUPPLY AND INSTALL THE FOLLOWING-

- 1 VAULT- MH1559/010 (5'X5'X5') M1216 (ON CUSTOMER PROPERTY)
- 1 SINGLE PHASE TRANSFORMER FOUNDATION- 1559/020PD (ON CUSTOMER PROPERTY)
- 2-4" PVC CONDUITS (CONCRETE ENCASED)
- APPROXIMATE SPANS:
 - 1559/010 TO 1559/020PD (85' +/-)
 - 1-4' PVC CONDUIT
 - APPROXIMATE SPAN:
 - 1559/020PD TO CUSTOMER HANDHOLE (10'+/-)

NOTE: PRIOR TO CONSTRUCTION, CONTACT EVERSOURCE
LARRY BELL @ (339) 987-7027