



PERMIT NO.  
25062

CITY OF NEW BEDFORD  
SEWER AND/OR STORM DRAIN PERMIT

DATE 6-28-22  
Expire date: 6-28-23

This certifies that permission is granted to

Robert Joseph Property Owner SS 1400 S Eastford Rd Grafton Tel. (508) 496-2344

To connect a sewer and/or storm drain located at 16 Lindsey Street  
Assessor's Plot 50 Lot 188 to the sewer and/or storm drain in 10 inch sewer Lindsey Street

To be laid in accordance with the conditions in this application and the City of New Bedford ordinances.  
TYPE OF USE: RESIDENTAL COMMERCIAL INDUSTRIAL FLOW G.P.D.

If applicant other than actual property owner, attach Letter of Authorization from Property Owner.

Name: RJA Tel.:  
Mailing Address:  
The Bonded Contractor/Drain Layer authorized to perform this work is:

Name JTC Construction Address Tel.

PERMIT EXPIRES ONE YEAR AFTER DATE OF ISSUE

- Requires separate connections for sewage and storm drain where applicable. Storm water cannot be discharged to a sanitary sewer.
  - All work must be inspected and approved by a D.P.I. inspector before backfilling.
  - If this connection is to be part of a private service shared jointly with other building owners, attach copy of Recorded Joint Maintenance Agreement.
  - Permits can be issued to Industrial and/or Commercial Applicants only upon receipt and approval by the Commissioner of Public Infrastructure of required plans and supplemental information.
  - In addition, a City-issued Industrial User Discharge Permit and/or a Sewer Extension/Connection Permit issued by the Commonwealth of Massachusetts D.E.P. shall be required by the City for Industrial Discharge into the sewer system.
- Industrial User Discharge Permit No. Date:

Comm. Mass. Sewer Conn./Ext. Permit No. Date:  
A Filing and Inspection Fee of \$4500 plus an Entrance Fee of \$ where applicable, must accompany this application.

Bank Coastal Eng'g Check# 507 Date 6-28-2022 Receipt# 3954422

Other requirements: Sewer line made connection not on sewer

Connection made to Sewer Part of jointly-shared private line YES NO  
Storm Drain

Applicant agrees to abide by the above terms, as well as all pertinent ordinances of the City of New Bedford, and such other special rules as the Commissioner of Public Infrastructure and/or City Engineer may deem necessary

Asst. City Engineer Signature of Property Owner or Representative

INSPECTOR'S REPORT

INSPECTED BY:

DATE:

COMMENTS:

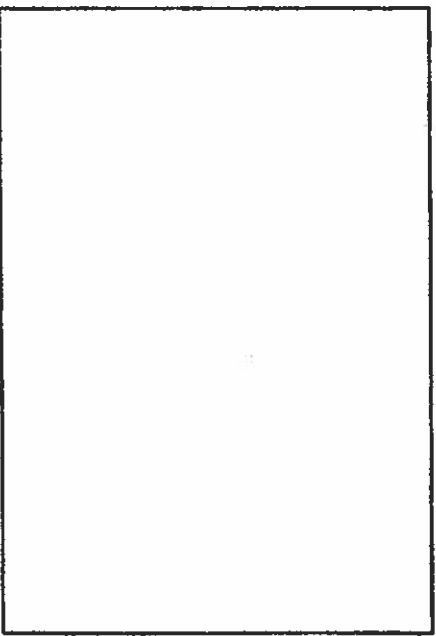

APPROVED DISAPPROVED

SKETCH PLAN

SIGNATURE



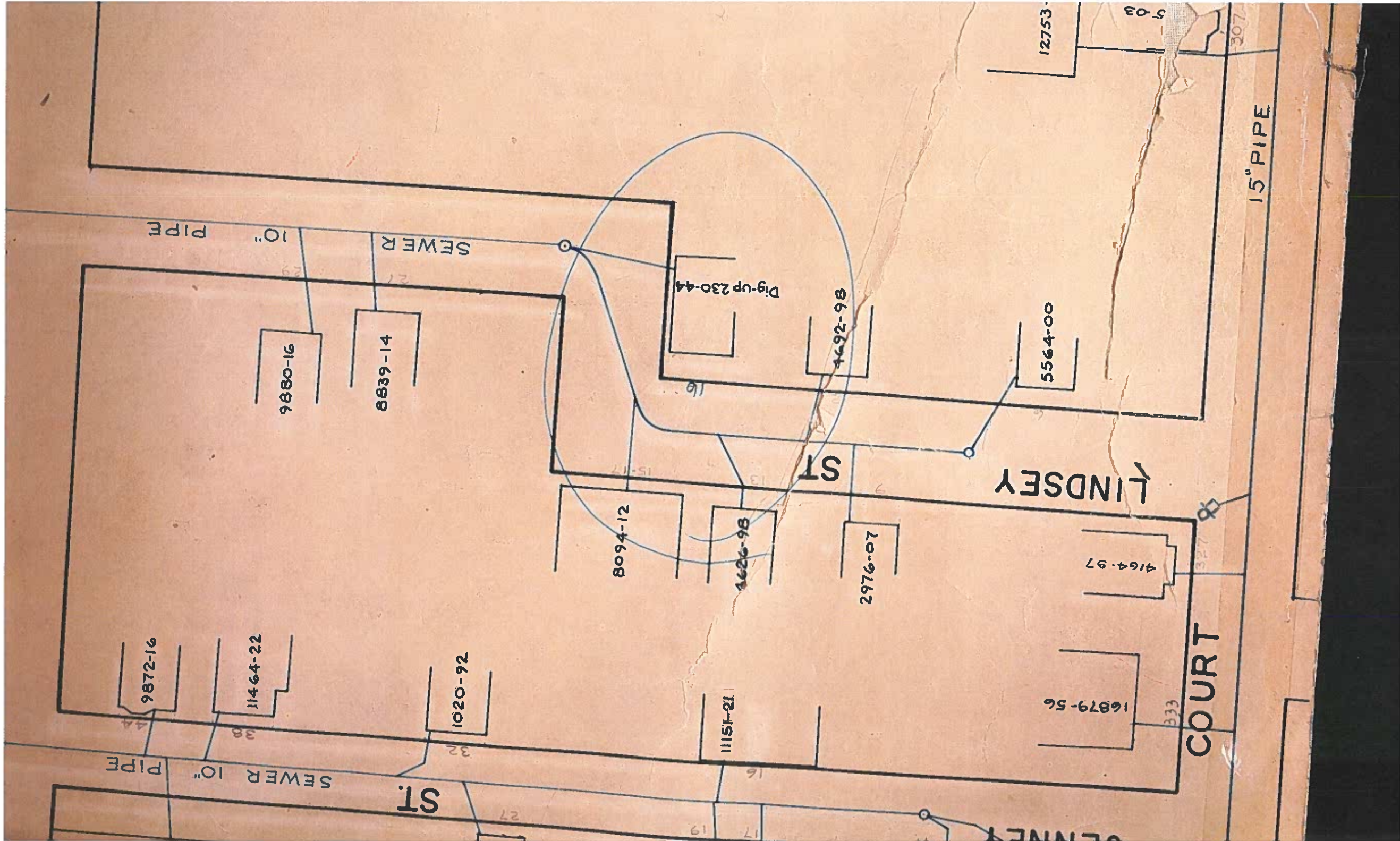

Robert A Jope  
Linda C Jope  
85 Upton Street  
New Bedford, MA 02746

507

53-8471/2113

June 28, 2022  
Date

Pay to the order of City of New Bedford \$ 450.00  
Four hundred fifty and 00/100 ————— Dollars

 Security features  
included.  
Details on back.



For Sewer connection fee

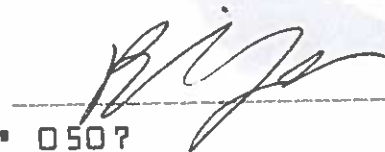

MP

⑆ 211384719⑆ 4002554040⑆ 0507

Main Street Coastal New England Federal Credit Union





