



PERMIT NO.  
25012

CITY OF NEW BEDFORD  
SEWER AND/OR STORM DRAIN PERMIT

DATE 1-16-2020  
Expire date: \_\_\_\_\_

This certifies that permission is granted to

RENEALD, CLAUDE RAY, JR. ROSA, INVESTMENT REALTY TRUST 5 ARCHER WAY ARDENSHIRE, MA  
Property Owner Address Tel. 62743

To connect a sewer and/or storm drain located at 473 COTTAGE ST  
Assessor's Plot 65 Lot 15 to the sewer and/or storm drain in COTTAGE ST Street

To be laid in accordance with the conditions in this application and the City of New Bedford ordinances.  
TYPE OF USE: RESIDENTIAL COMMERCIAL INDUSTRIAL FLOW G.P.D.

If applicant other than actual property owner, attach Letter of Authorization from Property Owner.

Name..... Tel.....  
Mailing Address.....  
The Bonded Contractor/Drain Layer authorized to perform this work is:  
Name Address Tel.  
Type of Pipe Required:.....

PERMIT EXPIRES ONE YEAR AFTER DATE OF ISSUE

- Requires separate connections for sewage and storm drain where applicable. Storm water cannot be discharged to a sanitary sewer.
  - All work must be inspected and approved by a D.P.L. inspector before backfilling.
  - If this connection is to be part of a private service shared jointly with other building owners, attach copy of Recorded Joint Maintenance Agreement.
  - Permits can be issued to Industrial and/or Commercial Applicants only upon receipt and approval by the Commissioner of Public Infrastructure of required plans and supplemental information.
  - In addition, a City-issued Industrial User Discharge Permit and/or a Sewer Extension/Connection Permit issued by the Commonwealth of Massachusetts D.E.P. shall be required by the City for Industrial Discharge into the sewer system.
- Industrial User Discharge Permit No. .... Date .....

Comm. Mass. Sewer Conn./Ext. Permit No. .... Date .....

A Filing and Inspection Fee of \$ ..... plus an Entrance Fee of \$ ..... where applicable, must accompany this application.

Bank# ..... Check# ..... Date ..... Receipt# .....

Other requirements: .....

Connection made to  
Sewer Part of jointly-shared private line YES NO  
Storm Drain

Applicant agrees to abide by the above terms, as well as all pertinent ordinances of the City of New Bedford, and such other special rules as the Commissioner of Public Infrastructure and/or City Engineer may deem necessary

Asst. City Engineer

Signature of Property Owner or Representative

INSPECTOR'S REPORT

INSPECTED BY: P. GIERSE, SONS, INC.

DATE: \_\_\_\_\_

COMMENTS: \_\_\_\_\_

APPROVED

DISAPPROVED

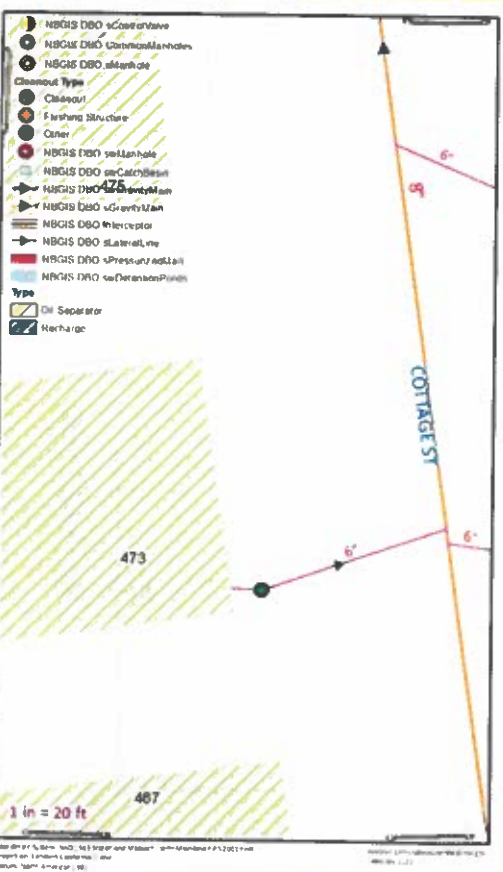

SIGNATURE

PERMIT FULFILLED BY DR FOR PURPOSE OF UNKNOWN EXISTING LATERAL SERVICE

97/98

# Record of Sewer Service Connection

PROJECT:

Lead Service Line Replacement Program-Phase 1, New Bedford, MA

STREET:

Cottage Street NYNLINE WILKINS ST. 1201 BT FLY LINE

ADDRESS:

473

CONTRACTOR:

P. Gioioso & Sons, Inc. Hyde Park, MA

Date :

1/16/2020

Length of New Pipe Installed (ft.):

21

Type:

PVC

Diameter (in.):

6

WYE distance to downstream manhole (ft.):

180

Depth at Property Line (ft.):

4.8

Clean-out Installed:

yes

Distance Curb Face to Clean-out (ft.):

7

Ties:

OWNER: RONALD OLIVEIRA TRS, ROSO INVESTMENT REALTY TRUST

P.65/L.15

SEIR # 25012-2020

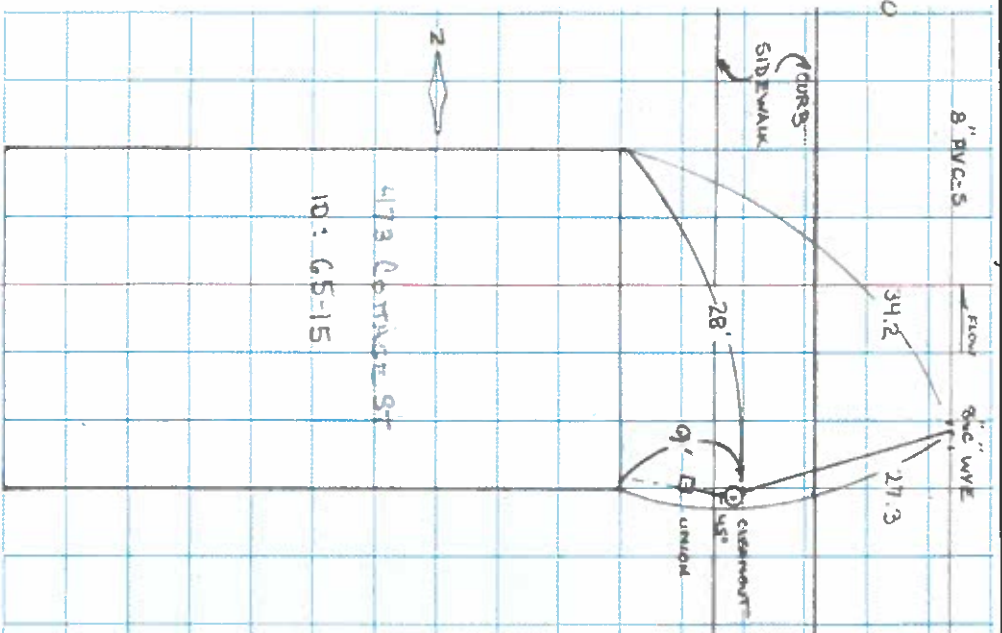

Notes: