



PERMIT NO.
25000

CITY OF NEW BEDFORD
SEWER AND/OR STORM DRAIN PERMIT

DATE 2-7-2020
Expire date: _____

This certifies that permission is granted to

Property Owner THOMAS P. LISA & WALSH Address 398 COTTAGE ST. NITON D2746 Tel. _____

To connect a sewer and/or storm drain located at 398 COTTAGE ST.

Assessor's Plot 6.5 Lot 3.98, to the sewer and/or storm drain in COTTAGE ST Street

To be laid in accordance with the regulations in this application and the City of New Bedford ordinances.

TYPE OF USE: RESIDENTIAL COMMERCIAL INDUSTRIAL FLOW _____ G.P.D.

If applicant other than actual property owner, attach Letter of Authorization from Property Owner.

Name: _____ Tel. _____

Mailing Address: _____

The Bonded Contractor/Drain Layer authorized to perform this work is:

Name _____ Address _____ Tel. _____

Type of Pipe Required: _____

PERMIT EXPIRES ONE YEAR AFTER DATE OF ISSUE

- Requires separate connections for sewage and storm drain where applicable. Storm water cannot be discharged to a sanitary sewer.
- All work must be inspected and approved by a D.P.L. inspector before backfilling.
- If this connection is to be part of a private service shared jointly with other building owners, attach copy of Recorded Joint Maintenance Agreement.
- Permits can be issued to Industrial and/or Commercial Applicants only upon receipt and approval by the Commissioner of Public Infrastructure of required plans and supplemental information.
- In addition, a City-issued Industrial User Discharge Permit and/or a Sewer Extension/Connection Permit issued by the Commonwealth of Massachusetts D.E.P. shall be required by the City for Industrial Discharge into the sewer system.
- Industrial User Discharge Permit No. _____ Date _____

Comm. Mass. Sewer Conn./Ext. Permit No. _____ Date _____
A Filing and Inspection Fee of \$ _____, plus an Entrance Fee of \$ _____, where applicable, must accompany this application.

Bank# _____ Check# _____ Date _____ Receipt# _____

Other requirements: _____

Connection made to	Part of jointly-shared private line	YES	NO
Sewer			
Storm Drain			

Applicant agrees to abide by the above terms, as well as all pertinent ordinances of the City of New Bedford, and such other special rules as the Commissioner of Public Infrastructure and/or City Engineer may deem necessary

Asst. City Engineer _____
Signature of Property Owner or Representative _____

INSPECTOR'S REPORT

INSPECTED BY: P. G. 10105015015 INC.

DATE: _____

COMMENTS: _____

APPROVED _____ DISAPPROVED _____

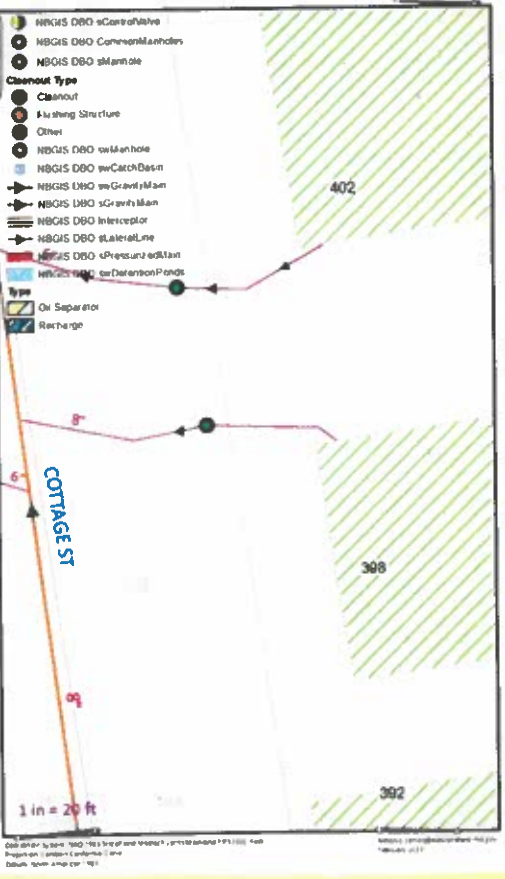

Permit Poured by DPT for Repairs of UNKNOWN EXISTING LATERAL SERVICE

SIGNATURE

9/3/97

Record of Sewer Service Connection

PROJECT: Lead Service Line Replacement Program-Phase 1, New Bedford, MA

STREET: Cottage Street NY 5220MADE St, 11612 FT WYKLINE

ADDRESS: 398

CONTRACTOR: P. Gioioso & Sons, Inc. Hyde Park, MA Date: 2/7/2020

Length of New Pipe Installed (ft.): 33.8 Type: PVC Diameter (in.): 6

WYE distance to downstream manhole (ft.): 114 Depth at Property Line (ft.): 5

Clean-out Installed: yes Distance Curb Face to Clean-out (ft.): 7

Ties: OWNER: THOMAS P. LISA & WALSH

P. 65/L. 382

SER# 25000-2020

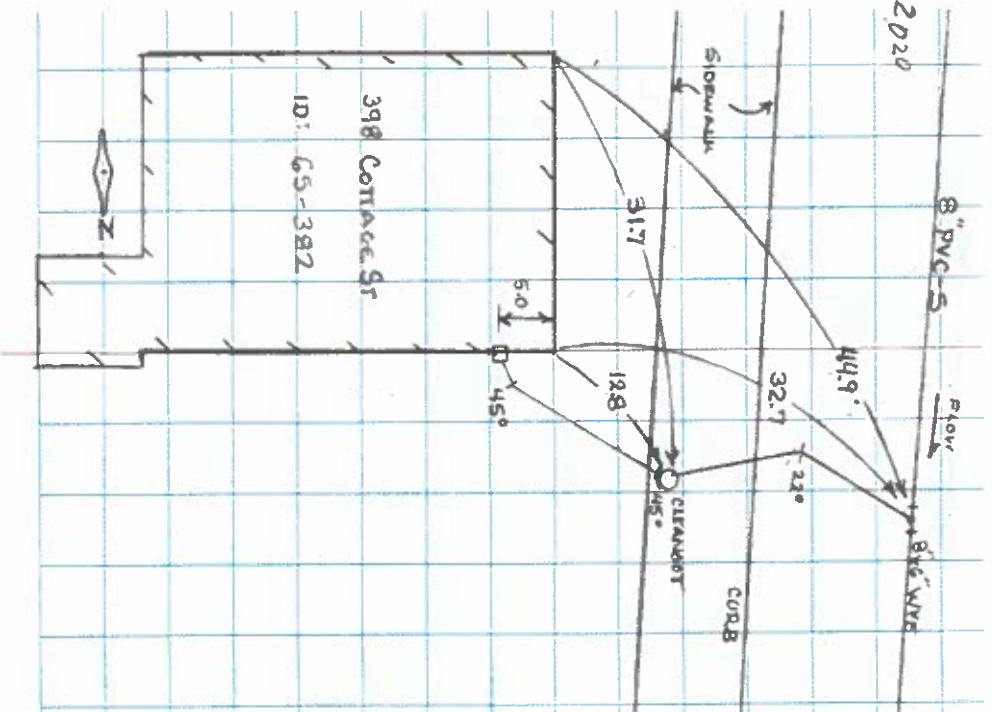

Notes: