



PERMIT NO.
24994

CITY OF NEW BEDFORD
SEWER AND/OR STORM DRAIN PERMIT

DATE 6-18-2021

This certifies that permission is granted to

Expire date: _____

JOSE MARIA ARMAS / JOSE ESTACIL ARMAS JR. 241 TICKLE RD., WESTPORT, MA 02790
Property Owner Address Tel.

To connect a sewer and/or storm drain located at 16 KEARSARGE ST
Assessor's Plot 112 Lot 59 to the sewer and/or storm drain in KEARSARGE ST Street

To be laid in accordance with the conditions in this application and the City of New Bedford ordinances.
TYPE OF USE: RESIDENTIAL COMMERCIAL INDUSTRIAL FLOW _____ G.P.D.

If applicant other than actual property owner, attach Letter of Authorization from Property Owner.

Name _____ Tel. _____
Mailing Address _____
The Bonded Contractor/Drain Layer authorized to perform this work is:
Name _____ Address _____ Tel. _____
Type of Pipe Required: _____

PERMIT EXPIRES ONE YEAR AFTER DATE OF ISSUE

- Requires separate connections for sewage and storm drain where applicable. Storm water cannot be discharged to a sanitary sewer.
 - All work must be inspected and approved by a D.P.I. inspector before backfilling.
 - If this connection is to be part of a private service shared jointly with other building owners, attach copy of Recorded Joint Maintenance Agreement.
 - Permits can be issued to Industrial and/or Commercial Applicants only upon receipt and approval by the Commissioner of Public Infrastructure of required plans and supplemental information.
 - In addition, a City-issued Industrial User Discharge Permit and/or a Sewer Extension/Connection Permit issued by the Commonwealth of Massachusetts D.E.P. shall be required by the City for Industrial Discharge into the sewer system.
- Industrial User Discharge Permit No. _____ Date _____

Comm. Mass. Sewer Conn./Ext. Permit No. _____ Date _____
A Filing and Inspection Fee of \$ _____, plus an Entrance Fee of \$ _____ where applicable, must accompany this application.

Bank# _____ Check# _____ Date _____ Receipt# _____

Other requirements: _____

Connection made to Sewer Part of jointly-shared private line YES NO
Storm Drain

Applicant agrees to abide by the above terms, as well as all pertinent ordinances of the City of New Bedford, and such other special rules as the Commissioner of Public Infrastructure and/or City Engineer may deem necessary

Asst. City Engineer

Signature of Property Owner or Representative

INSPECTOR'S REPORT

INSPECTED BY: P. GARCIA

LOTAGE ST SEWER PROJECT
DATE: 6-18-2021

COMMENTS: _____

APPROVED

DISAPPROV

SIGNATURE

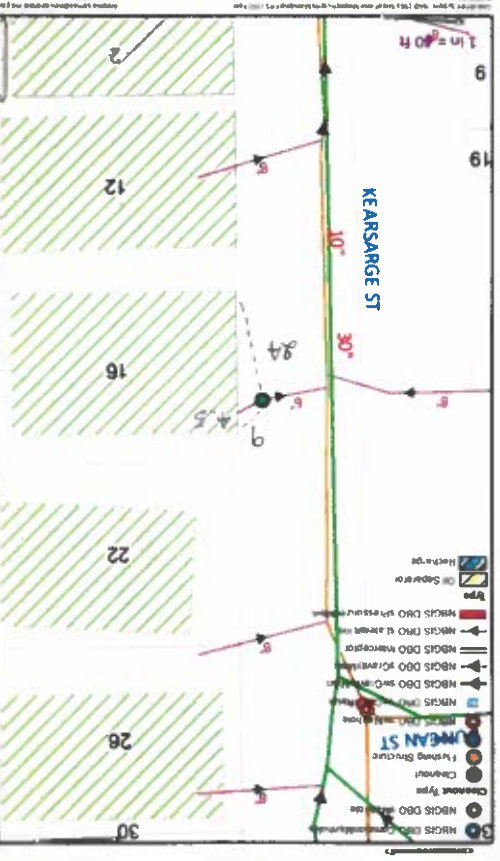

PERMIT PULLED BY D.P.I. FOR PURPOSE OF UNKNOWN EXISTING LATERAL SERVICE