



CITY OF NEW BEDFORD

MASSACHUSETTS

CONSTRUCTION OF
SIDEWALK / DRIVEWAY

ENGINEERING 508.979.1550

Expiration Date: 8-31-23Permit Number: 11799 Date: 8-31-23Property Owner: Jose Bevenuto / Susan Daniels Telephone Number: (508) 991-1877Owner Address: 39 Stephen St NR MA 02740☒ Permit not pulled by owner, pulled with permission slip

The above hereby request permission to construct a: 1 driveway / 1 sidewalk located at 39 Stephen Street, Plot 22, Lot 56 to be constructed in accordance with the city's latest construction standards and specifications and adhere to the Ordinances of the City of New Bedford.

Sidewalk	Dimensions	Driveway	Dimensions
<input type="checkbox"/> Residential		<input checked="" type="checkbox"/> Residential	remove 13' x 10' existing asphalt
<input type="checkbox"/> Commercial		<input type="checkbox"/> Commercial	open + grade sidewalk
<input type="checkbox"/> Hot Mix Asphalt		<input type="checkbox"/> Relocation / Widening	
<input type="checkbox"/> Concrete Full Width		<input type="checkbox"/> Hot Mix Asphalt	
<input type="checkbox"/> Concrete w/Grass Ribbon		<input checked="" type="checkbox"/> Concrete	remove 13' x 14' w/ new curb cement concrete
<input type="checkbox"/> Curbing Needed		<input type="checkbox"/> Curb Removal	

Comments: Please follow City of New Bedford DP
Construction standard specs

Bonded Contractor: JRS dlc Tel: _____

Traffic Commission: _____ Approved _____ Rejected _____ Date _____

Signature _____

Building Department: _____

Approved (New Build) ☒
Approved-Bldg. Permit# B-22-825Rejected ☐Signature Stanley Monemouchy (C.T.)Engineering Department: _____ Approved ☒ Rejected ☐ Date 11-13-22

Signature _____

Permit / Inspection fee of \$150.00 must accompany this application for driveway work.
Permit / Inspection fee of \$50.00 must accompany this application for sidewalk only work.

Special Requirements: Contractor to call 24 hrs. in advance for pre-inspection (prior to pouring). If curbing is removed, it must be returned in whole pieces within 24 hrs. to the DP1 City Yard on Liberty St. (Between Parker St & Durfee St) accompanied with original curbing receipt.

PAID: \$150 Check Number: 1128Supervising Civil Engineer Stephen Crompton (C.T.) Print Name (Property Owner / Representative) Jessica VieiraBy: Orsaci Torres Signature (Property Owner / Representative) Jessica Vieira1105 Shawmut Ave, New Bedford, MA 02746
Telephone Number 508.979.1550



Department of Public Infrastructure

Jamie Ponte
Commissioner

Water
Wastewater
Highways
Engineering
Cemeteries
Park Maintenance
Forestry

CITY OF NEW BEDFORD

Jonathan F. Mitchell, Mayor

PERMISSION SLIP

I hereby authorize Jives LLC / Jessica Vieira of
(Applicant Name)

Jives LLC 774-644-4929 at the address of
(Company Name & Telephone Number)

139 Highland Rd Assonet MA to act on my behalf including affixing
(Company Address)

my signature in securing permits for Plot _____, Lot _____

39 Stephen St New Bedford MA
(Address for permit location)

☐ Sewer Service Permits
☐ Stormwater Permits
☐ Water Service Permits
☒ Driveway Installation Permits
☒ Sidewalk Installation Permits

I further agree to conform to, and abide by, all City rules and regulations applicable to the permit(s) being applied for.

Property Owner Information:

Printed Name Jose Bernardo Signature Jose Bernardo

Address 39 Stephen St. New Bedford MA City MA State 02740 Zip Code

Today's Date 8/31/22 Telephone Number 508 9911877

Driveway Review Form

Submitted By: nb.Carlos.Melo

Submitted Time: 04/06/2022 1:16 PM

WO #: 22-007083

Date & Time: April 6, 2022 1:08 PM

DPI Inspector: CM

Bldg. Inspector: Jimmy Papas

Contractor: JLC

Granite Curb: N/A

Address: 39 Stephen st.

Owner: Susan Daniels

Permit #: TB-22-825

Property

Plot #: 22 Lot #: 56

Permit Notes (Prop. Work): New Driveway

City Layout: 13 ft

Additional Inspection Notes:

1. Remove 13ft x 10 ft existing asphalt apron and grass sidewalk 2. Replace 13 ft x 14 ft with new apron cement concrete with City of New Bedford DPI construction standard specs

APPROVED

CM

4/13/2022

Driveway Review

Address: 39 STEPHEN ST

Permit: TB-22-825

DPI Inspector: Carlos Melo

City Layout: 13FT

Sketch

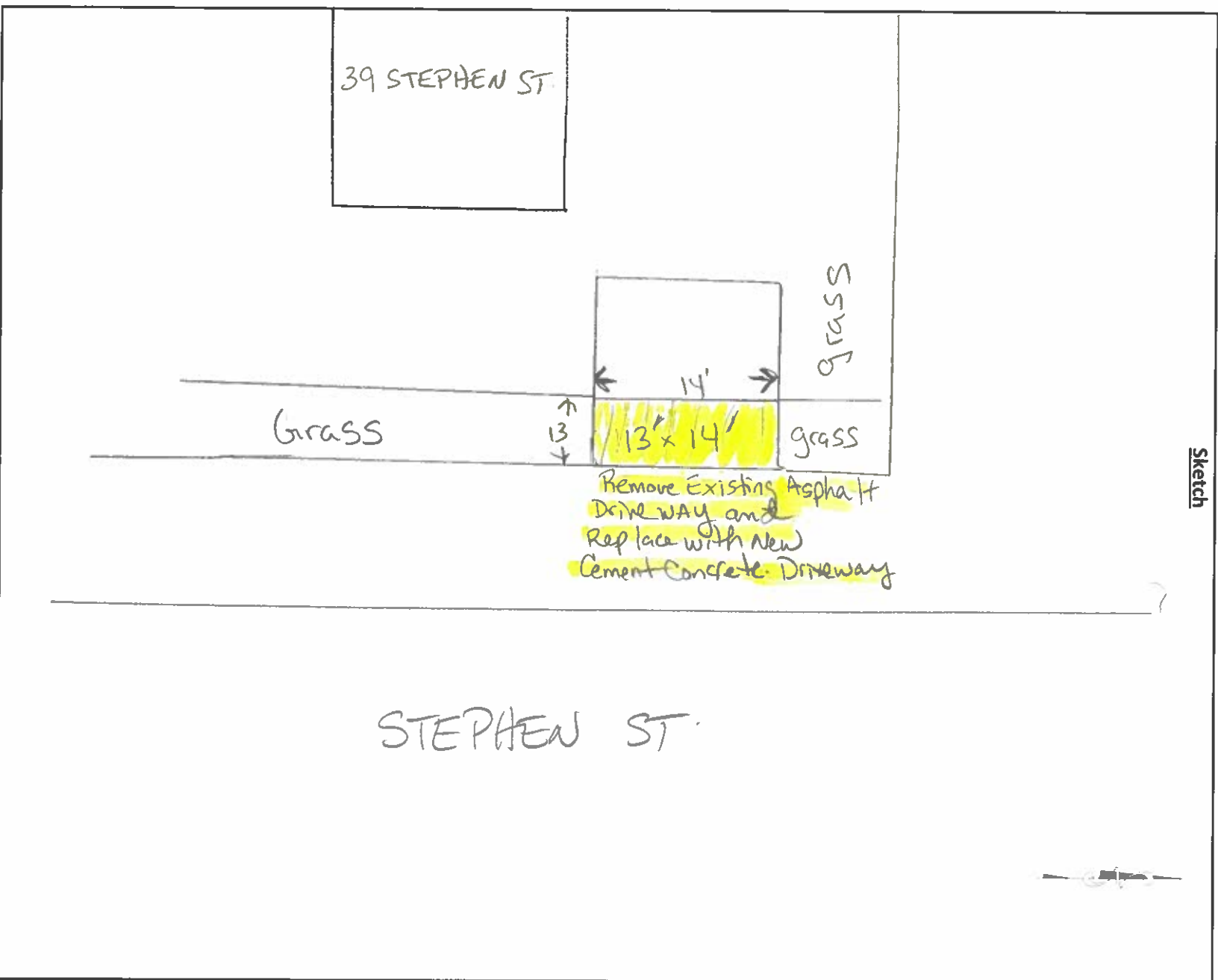

Work Order Number: 22-007083

4/6/2022
11:37 AM

Category:	Engineering	Priority:	
Problem:	Driveway	Crew:	
Cause:		Supervisor:	DENNIS SOUZA
Main Task:	Driveway Review	Status:	New Work Order
Work Order Start Date/Time:		Work Order End Date/Time:	
Department:	EN	Area:	
Division:	EN	Sub-Area:	
Sub-Division:			
Location (s)	39 STEPHEN ST		

Comments for Crew

Perform driveway review

825
TB-22-~~822~~

Task Start Date/Time:

Task End DateTime:

Task Code:

Task Description:

Driveway Review

Employee Number	Employee Name	Time Type			Units
		Reg	OT	Normal Type	
26084	CARLOS MELO	0.00	0.00	REGULAR TIME	Hours

<u>Equipment Code</u>	<u>Equipment Description</u>	<u>Units</u>

[illegible]

<u>Material Code</u>	<u>Material Description</u>	<u>Units</u>
----------------------	-----------------------------	--------------

<u>Fluid Code</u>	<u>Fluid Description</u>	<u>Units</u>
-------------------	--------------------------	--------------

13 cm leaf

$\frac{d}{dt}$

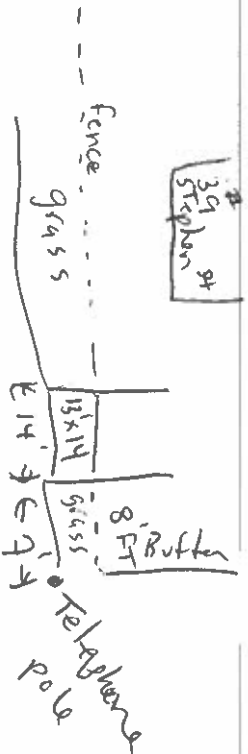



Commonwealth of Massachusetts

CITY OF NEW BEDFORD

City Hall, Room 308, 183 William Street New Bedford, MA 02740 (508) 979-1540



BUILDING PERMIT

No. **B-22-825**

7/14/2022

MSBC Sect. 110.14 - Any permit issued shall be deemed abandoned and invalid unless the work authorized by it shall have been commenced within six (6) months after its issuance.

FEE PAID: **\$30.00**

This certifies that jessica vieira

Contractor Lic. # _____

ParcelID **22-56**

owner/contractor has permission to: Driveways - 30.00

on: 39 STEPHEN ST

Providing that the person accepting this permit shall in every respect conform to the terms of application therefore on file in this office; to the provisions of the statute of the Commonwealth and to the by-laws of the City of New Bedford relating to the inspection, erection, enlarging, altering, raising, moving, repairing, or tearing down of a building.

Permit is issued subject to the following special requirements: (Restrictions)

CITY DEPARTMENT/COMMISSION COMMENTS

The following department/commission has expressed concern about the issuance of this permit. You are advised to contact that agency and resolve this matter.

Department/Commission: _____

BUILDING DEPARTMENT COMMENTS

: re-surface driveway
14' x 36'

YOUR AREA INSPECTOR IS: Jimmy Papas

Tel: (508) 979-1540 Between 8:00am - 9:00am

**NOTICE: NOTIFY INSPECTOR 48 HOURS IN
ADVANCE OF APPLYING SHEATHING OR LATHING**

OCCUPANCY PERMIT REQUIRED BEFORE OCCUPANCY

No Building or Structure shall be used or occupied until the Certificate of Use and Occupancy shall have been issued by the Building Commissioner - MSBC, Sect. 120.1

This Card Must Be Displayed in a Conspicuous Place on the Premises and Not Torn Down or Removed Until Completion of Work

SUBJECT TO MASSACHUSETTS
STATE BUILDING CODE

Building Commissioner

Plan Review Comments: : 1. Remove 13ft x 10 ft existing asphalt apron and grass sidewalk
2. Replace 13 ft x 14 ft with new apron cement concrete with City of New Bedford DPI construction standard specs
: CALL JIMMY PAPAS WHEN WORK BEGINS AND FOR INSPECTIONS 508-665-3126 and WHEN COMPLETE SO I CAN CLOSE
OUT PERMIT

MISCELLANEOUS PAYMENT RECPT#: 4055661
City of New Bedford
Office of the Treasurer
133 William Street
New Bedford, MA 02743

DATE: 08/31/22 TIME: 12:26:18
CLERK: a450mb DEPT:
CUSTOMER#: 0

COMMENT:

CHG: DPIDRV DPI DRIVEWAY PE 150.00

REVENUE:
1 03406000 454010 150.00
 DPI - Driveway-Sidewalk Permit
 PERMIT 11799
CASH:
 TW05 101609 150.00
 WEB5537

AMOUNT PAID: 150.00

PAID BY: JIVES LLC
PAYMENT METH: CHECK
 MR1128

REFERENCE:

AMT TENDERED: 150.00
AMT APPLIED: 150.00
CHANGE: .00