

APPLICATION/AGREEMENT
For Trench/Disturbance Permit within the City of New Bedford

Permit # _____
Dig Safe# 20222214702
Date: 06/03/2022

TO THE MAYOR AND CITY COUNCIL: DISTURBANCE PERMIT/TRENCH SAFETY PERMIT

Permission is hereby requested to excavate the surface of: X City Property and/or X Private Property
Provide Sketch

Location of Work: 63 - 63 1/2 County St
Between Nelson St. and Jouvette St. Working in the street and street to house.
Relay gas service.

Work will begin (weather permitting) on: June 17, 2022

Applicant Name: Steven Botelho (gk) Excavator(s) Name: _____

Company Name: Eversource Hoisting Equipment License Number: _____
Grade: _____ Expiration Date: _____

Contact Number: 338-987-8010 Name & Contact Number of Insurer: _____

Competent Person on Work Site: ON FILE APPROVED BY: _____ DATE: _____

TITLE: _____ DENIED

This permit shall be posted at the work site, and shall remain until the work is completed. It is subject to inspection at all times.

Concrete side walk granite curb
Curb stop within 2' of proposed work area

meter in side walk
adjacent to the side of
the house

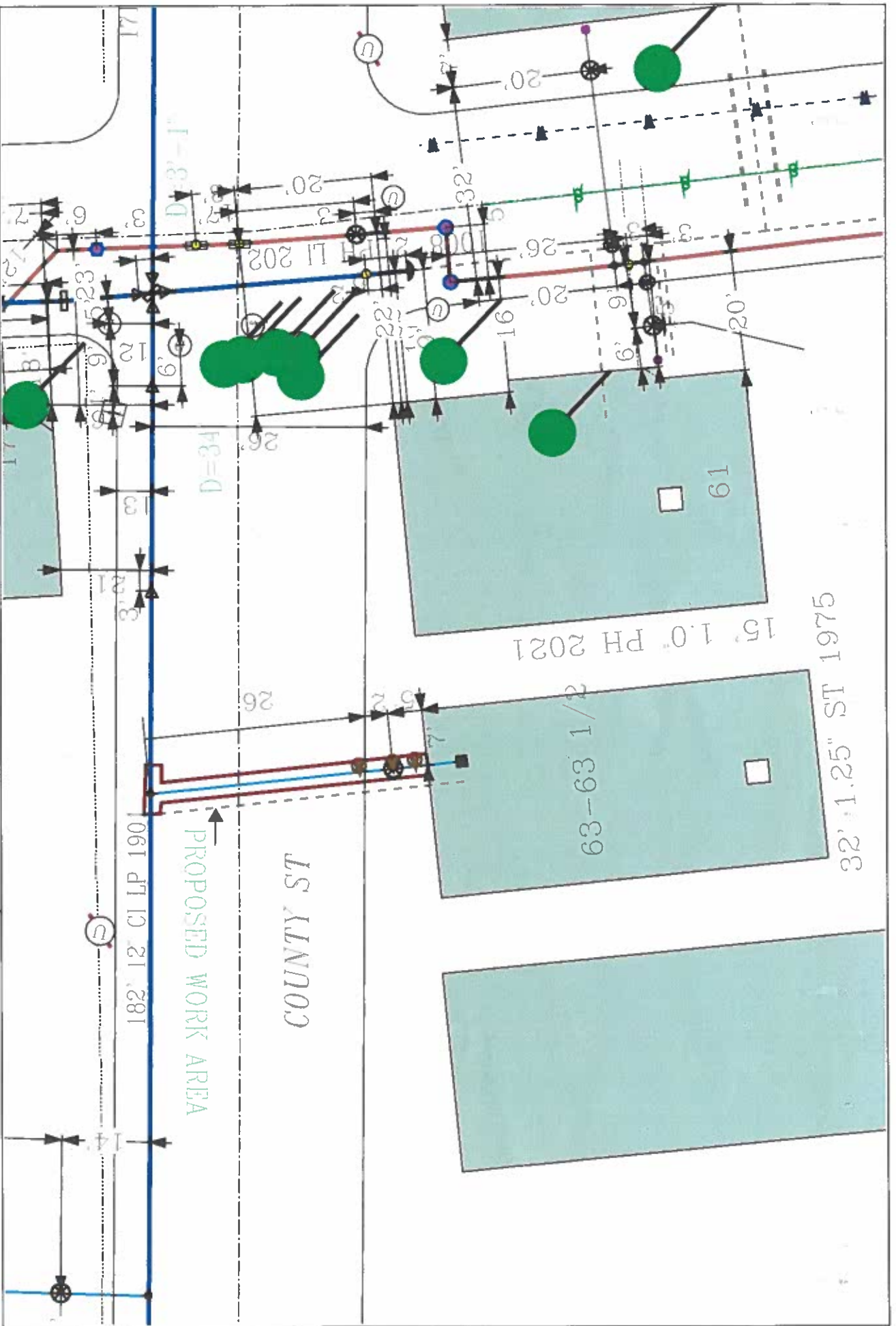

EVERSOURCE
 EVERSOURCE MA GAS
 One NSTAR Way, 02090
 Needham, MA 02090
 Phone 1-800-582-2000



MASS LAW
 Requires the owner of any
 building to notify the
 owner of any
 Dig Safe: 811

IMPORTANT - DO NOT SCALE
 Field drawing provides approximate locations only and all facility information
 may not be shown. Contact Eversource for more information. Information
 information identified. Eversource is not responsible for the location of any
 the required that a person performing excavation work contact Dig Safe so
 that the location of any underground may be marked.

Address: 63-63 1/2 County St
City/Town: New Bedford