

APPLICATION/AGREEMENT
For Trench/Disturbance Permit within the City of New Bedford

Permit # 01-2022
Dig Safe# 20220903115
Date: 3/2/2022

TO THE MAYOR AND CITY COUNCIL: DISTURBANCE PERMIT/TRENCH SAFETY PERMIT

Permission is hereby requested to excavate the surface of: X City Property and/or X Private Property
Provide Sketch

Location of Work: 15-17 Hollyhock St. complexe service shut out of
Dartmouth St. - Field St.
Gas Service Retirement

Work will begin (weather permitting) on: March 16, 2022

Applicant Name: Kevin O'Sullivan (ra) Excavator(s) Name: _____

Company Name: Eversource Hoisting Equipment License Number: _____

Grade: _____ Expiration Date: _____

Contact Number: 508-441-5817 Name & Contact Number of Insurer: _____

Competent Person on Work Site: ON FILE

APPROVED BY: Stephen Caputo DATE: 3-16-2022

TITLE: Asst City Engineer

This permit shall be posted at the work site, and shall remain until the work is completed. It is subject to inspection at all times.

Permit only valid for three months
from date of approval

ROADWAY CLOSURES WILL REQUIRE
AUTHORIZATION FROM THE
COMMISSIONER OF PUBLIC
INFRASTRUCTURE TRAFFIC MANAGEMENT
PLANS MAY BE REQUIRED.

Trenches must be maintained
weekly until final paving is
completed

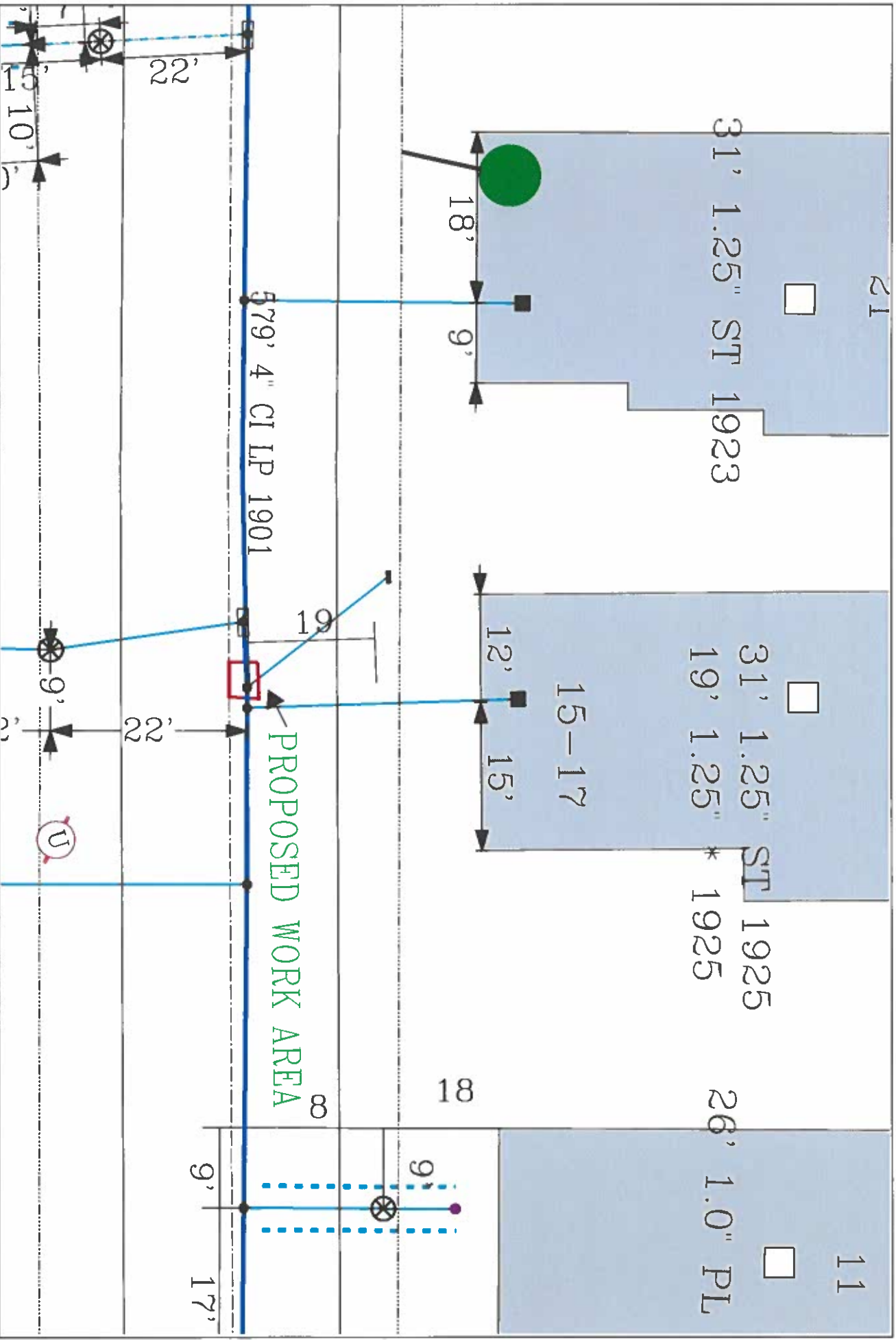

EVERSOURCE
EVERSOURCE MA GAS
One N STATE ST, 02090
Bedford, MA
Phone 1-800-582-2000



MASS LAW
Regulation 78: Every excavation
within the State of Massachusetts
shall be properly shored or
braced in accordance with the
Massachusetts Building Code.
Call Dig-Safe: 811

IMPORTANT - DO NOT SCALE
This drawing provides approximate locations only and all facility information
should be verified by the contractor. EVERSOURCE MA GAS does not warrant the
accuracy of the information provided. EVERSOURCE MA GAS disclaims liability for
any reliance by any person on the location shown on this map. Massachusetts
law requires that any person performing excavation work contact Dig-Safe so
that the location of any underground may be marked.

Address: 15-17 Hollyhock St
City/Town: New Bedford CD