

APPLICATION/AGREEMENT
For Trench/Disturbance Permit within the City of New Bedford

Permit # 72-2033
Dig Safe# 20220904183
Date: 3/2/2022

TO THE MAYOR AND CITY COUNCIL: DISTURBANCE PERMIT/TRENCH SAFETY PERMIT

Permission is hereby requested to excavate the surface of: X City Property and/or X Private Property
Provide Sketch

Location of Work: 1560-1570 Acushnet Ave. compliance service steel cut off
~~Working on Acushnet Ave. side of College St to Phillips Ave~~
Gas Service Retirement

Work will begin (weather permitting) on: March 16, 2022

Applicant Name: Kevin O'Sullivan (ra) Excavator(s) Name: _____

Company Name: Eversource Hoisting Equipment License Number: _____
Grade: _____ Expiration Date: _____

Contact Number: 508-441-5817 Name & Contact Number of Insurer: _____

Competent Person on Work Site: ON FILE APPROVED BY: Stephen Caputo DATE: 3-9-2022

TITLE: Asst City Engineer

This permit shall be posted at the work site, and shall remain until the work is completed. It is subject to inspection at all times.

Permit only valid for three months
from date of approval

Trenches must be maintained
weekly until final paving is
completed

ROADWAY CLOSURES WILL REQUIRE
AUTHORIZATION FROM THE
COMMISSIONER OF PUBLIC
INFRASTRUCTURE. TRAFFIC MANAGEMENT
PLANS MAY BE REQUIRED.

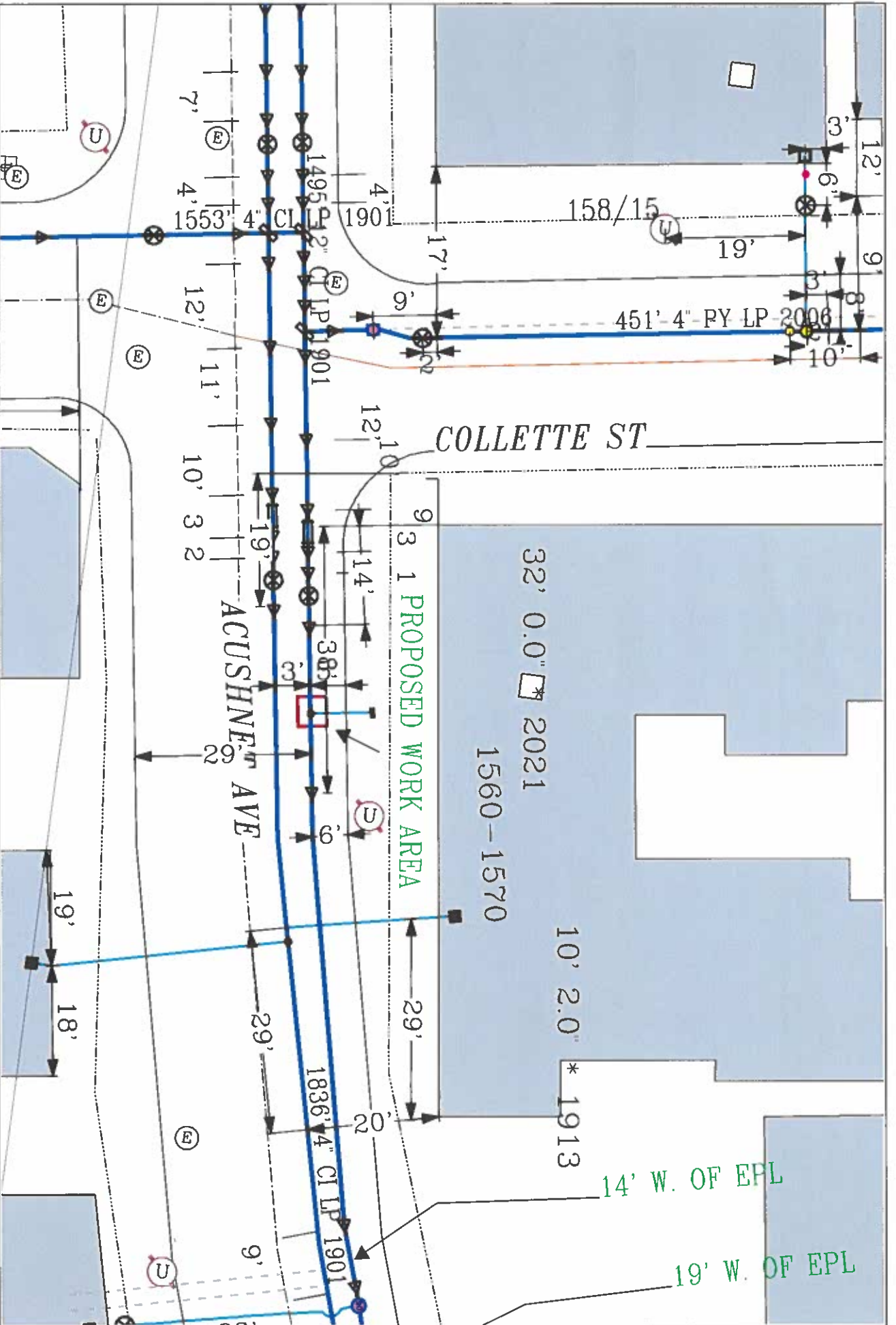

EVERSOURCE
EVERSOURCE MA GAS
One NSTAR Way
Needham, MA 02459
Phone 1-800-532-2000



MASS LAW
Impose 72 hour advance
notice to utility companies
before digging by anyone

Call Dig-Safe: 811

IMPORTANT - DO NOT SCALE
This drawing provides approximate locations only and all facility information
may not be shown. Contact Eversource and call to have specific field
location information provided. Eversource is not responsible for any resulting from
the reliance by any person on the location shown on this map. Massachusetts
law requires that any person performing excavation work contact Dig-Safe so
that the location of any underground may be marked.

Address: 1560-1570 Acushnet Ave
City/Town: New Bedford CD

Date Plotted: 01/28/2022