

APPLICATION / AGREEMENT

For DISTURBANCE PERMIT within the City of New Bedford

Permit # 108-2022
Dig Safe # _____
Date Issued: Dec. 27, 2022

This permit shall be posted at the work site, and shall remain until the work is completed. It is subject to inspection at all times.

TO THE MAYOR AND CITY COUNCIL: ☒ DISTURBANCE PERMIT

Permission is hereby requested to excavate the surface of: ☒ City Property

Location of work: 75 Church Street

Substantially as per plan annexed, for the purpose of: Installation of MDC traps

Small Permit # 14200-26

Work will begin (weather permitting) on: 12-28-2022

Work will end (weather permitting) on: 3-28-2023

Applicant Name: [Signature]

Excavator(s) Name: [Signature]

Company Name: JLC Construction

Hoisting Equipment License Number: _____

Grade: _____ Expiration Date: _____

Contact Name: _____

Name & Contact Number of Insurer: _____

Eastern Insurance

Approved By: [Signature]

Date: 12-28-2022

Title: Asst. City Engineer

Provide Sketch

Roadway closures will require authorization from the Commissioner of Public Infrastructure.
Traffic management plans may be required.

For inspection, 24 hour notice is required and the Contractor / Applicant is required to
notify the D.P.I. @ 508-979-1550 Press 4 Repair. Permit Expires in 3 Months from work start date.

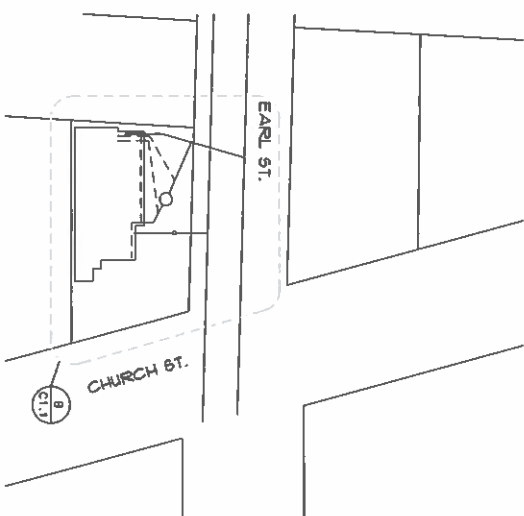
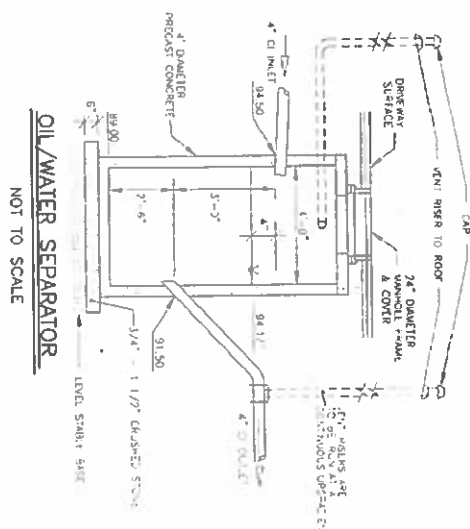
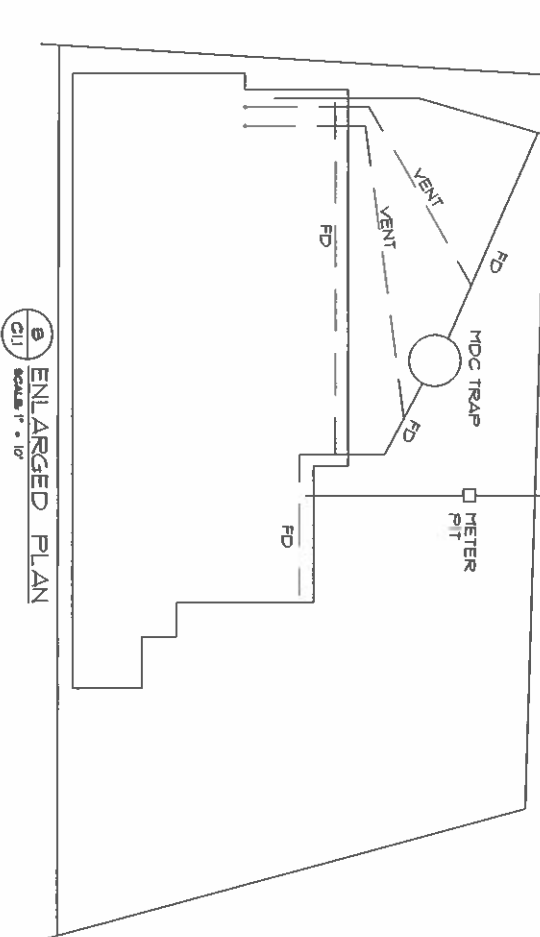
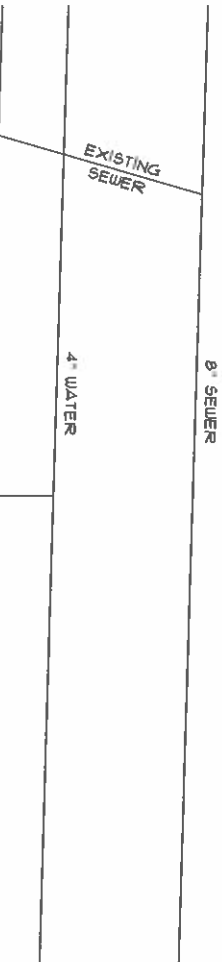
[illegible]

ENLARGED PLAN
SCALE 1" = 10'

SCALE: 1" = 40'

SITE PLAN PLAN

CL

Copyright © 2022 by LC Construction. All Rights Reserved. The plans, drawings, designs, specifications and other arrangements in this book are and shall remain the property of LC CONSTRUCTION. No part thereof shall be copied, disclosed to others, or used in connection with any sort of project, either done or intended to be done, without the express knowledge and written consent of LC CONSTRUCTION. LC CONSTRUCTION shall not be responsible for construction means, methods, techniques, or procedures utilized by the contractor, nor for the safety of public or contractor's employees, or for the failure of the contractor to carry out the work in accordance with the contract documents. LC CONSTRUCTION hereby disclaims all liability for the use of this third party content.

| | | | |
|---|--|--|--|
| <p>Drawings Title</p> <p style="text-align: center; font-size: 1.2em;">SITE PLAN</p> | | <p>Drawn/checked</p> <p style="text-align: center;">PROPOSED New MDC Trap</p> | |
| <p>Project</p> <p style="text-align: center;">PROPOSED MDC TRAP At: 79 CHURCH ST. MAP 102, LOT 103 NEW BEDFORD, MA</p> | | <p>Date</p> | |
| <p>Scale</p> <p style="text-align: center;">AS SHOWN</p> | | <p>Date</p> | |
| <p>Drawn</p> | | <p>Approved</p> | |
| <p>Checked</p> | | <p>Approved</p> | |
| <p>Scale</p> <p style="text-align: center;">1" = 20' - 0"</p> | | <p>Approved</p> | |
| <p>Date</p> <p style="text-align: center;">2022-1-5</p> | | <p>Approved</p> | |

Drawn/checked

PROPOSED
New MDC Trap

Date

Scale

AS SHOWN

Date

Drawn

Approved

Checked

Approved

Scale

1" = 20' - 0"

Approved