

APPLICATION/AGREEMENT

For Trench/Disturbance Permit within the City of New Bedford

Permit # 604-2002

Dig Safe# 20225001386

Date: 12/12/2022

TO THE MAYOR AND CITY COUNCIL:

DISTURBANCE PERMIT/TRENCH SAFETY PERMIT

Permission is hereby requested to excavate the surface of: X City Property and/or X Private Property

Provide Sketch

Location of Work: 219 Rivet St

Corner property with Hall St. Working in the street and street to building on Rivet St side.

Relay gas service.

Work will begin (weather permitting) on: December 26, 2022

Applicant Name: Steven Botelho (gk)

Excavator(s) Name: \_\_\_\_\_

Company Name: Eversource

Hoisting Equipment License Number: \_\_\_\_\_

Grade: \_\_\_\_\_ Expiration Date: \_\_\_\_\_

Contact Number: 339-987-8010

Name & Contact Number of Insurer: \_\_\_\_\_

Competent Person on Work Site: ON FILE

APPROVED BY: Signature DATE: 12-23-2002

TITLE: Asst. City Engineer

This permit shall be posted at the work site, and shall remain until the work is completed. It is subject to inspection at all times.

Trenches must be maintained  
weekly until final paving is  
completed

Permit only valid for three months  
from date of approval

ROADWAY CLOSURES WILL REQUIRE  
AUTHORIZATION FROM THE  
COMMISSIONER OF PUBLIC  
INFRASTRUCTURE. TRAFFIC MANAGEMENT  
PLANS MAY BE REQUIRED.

This site plan shows the 1995-98 PD II area. It includes building footprints for 233, 221-223, and 219. Building 233 is 41' x 0.5'. Building 221-223 is 32' x 19.5'. Building 219 is 14' x 0.5'. A green circle is located in building 221-223. A red line is drawn across the plan, labeled 58' 2.00" PD II 1995-98. Other dimensions include 29', 1', 16', 9', 11', 15', 12', 1', 4', and 9'. A north arrow is present in the upper right corner.

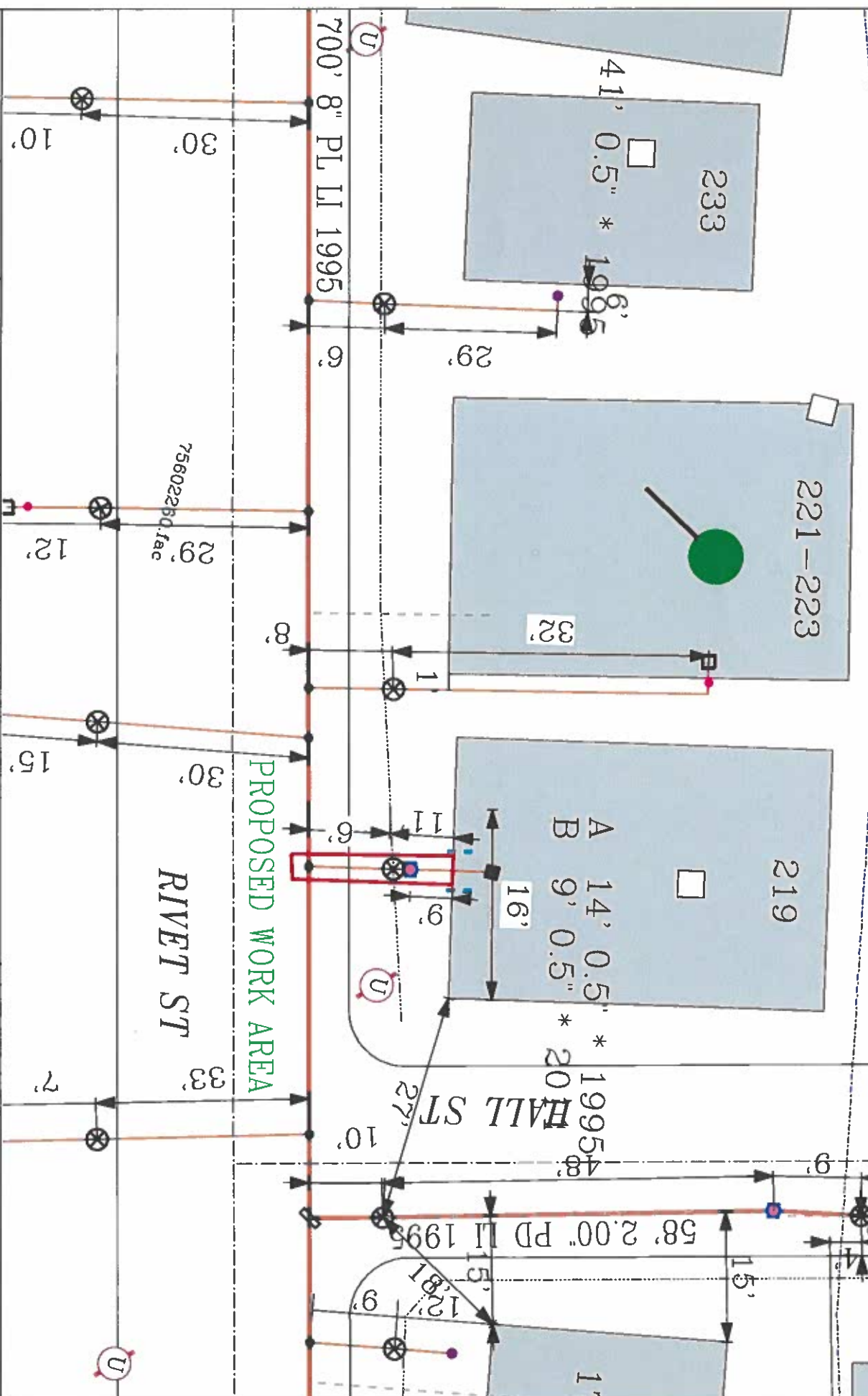

EVERSOURCE NA GAS  
One NSTAR Way  
Westwood, MA 02090  
Phone 1-800-592-2000



**Enables The lowest advertising prices to utility companies before being by anyone**

**Call Dig-Safe: 811**

This drawing provides approximate locations only and all facility information may not be shown. Contact EVERSOURCE MA GAS to have specific field information identified. EVERSOURCE MA GAS disclaims any liability resulting from the reliance by any person on the location shown on this map. Massachusetts law requires that any person performing excavation work contact Dig-Safe so that the location of any underground may be marked.

City/Town: New Bedford

Date Plotted: 02/01/2022