

APPLICATION/AGREEMENT

For Trench/Disturbance Permit within the City of New Bedford

Permit # 608-2000Dig Safe# 20225002821Date: 12/13/2022

TO THE MAYOR AND CITY COUNCIL:

DISTURBANCE PERMIT/TRENCH SAFETY PERMIT

Permission is hereby requested to excavate the surface of : X City Property and/or X Private Property
Provide SketchLocation of Work: 24 Durfee St.Cottage St. - Summer St.Gas Line MaintenanceWork will begin (weather permitting) on: December 27, 2022Applicant Name: Steven Botelho (ra)

Excavator(s) Name: _____

Company Name: Eversource

Hoisting Equipment License Number: _____

Grade: _____ Expiration Date: _____

Contact Number: 508-441-5817

Name & Contact Number of Insurer: _____

Competent Person on Work Site: ON FILEAPPROVED BY: Stephen Coughlin DATE: 12-23-2022TITLE: Asst. City Engineer

This permit shall be posted at the work site, and shall remain until the work is completed. It is subject to inspection at all times.

Trenches must be maintained
weekly until final paving is
completedPermit only valid for three months
from date of approvalROADWAY CLOSURES WILL REQUIRE
AUTHORIZATION FROM THE
COMMISSIONER OF PUBLIC
INFRASTRUCTURE. TRAFFIC MANAGEMENT
PLANS MAY BE REQUIRED.

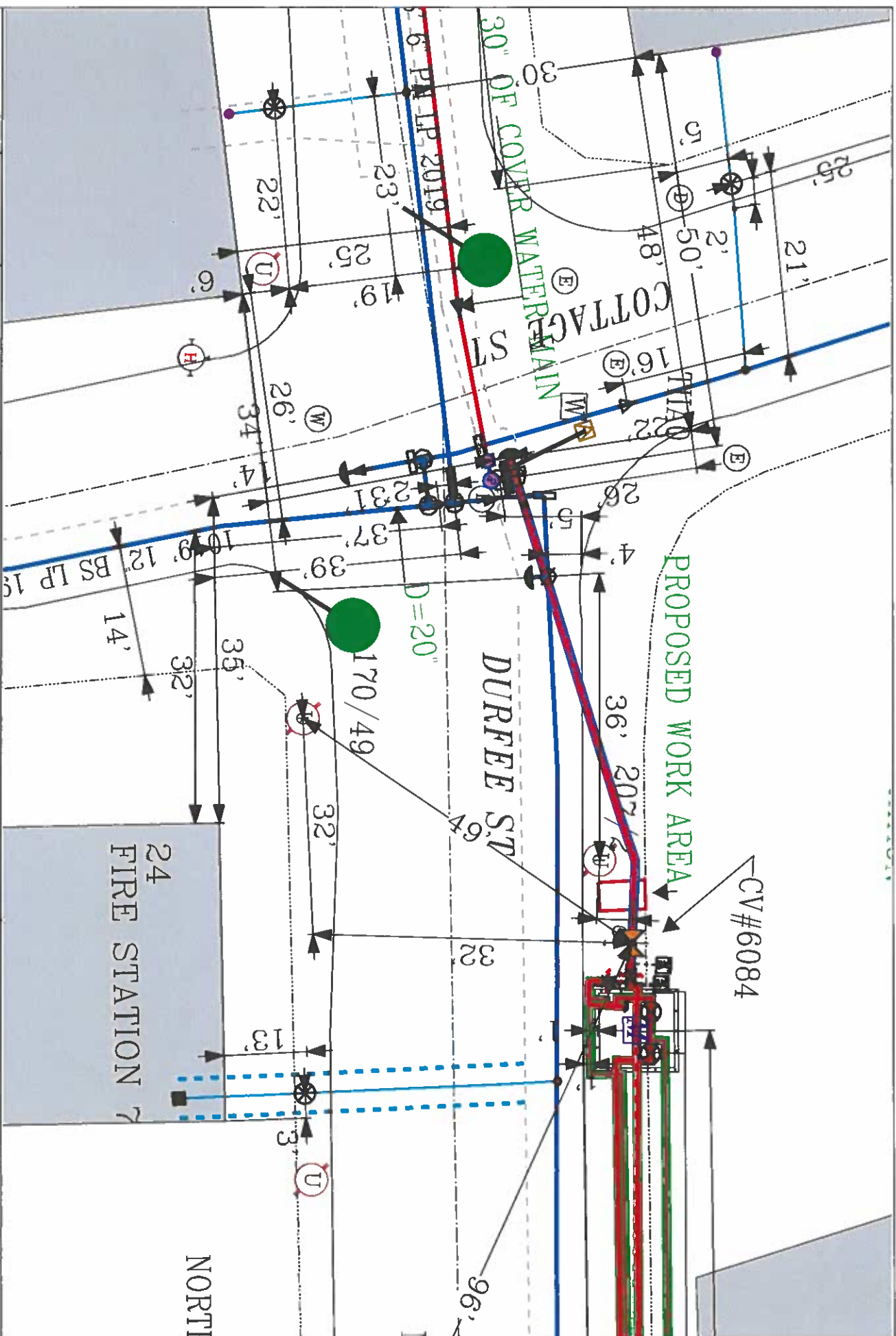
**EVERSOURCE**

EVERSOURCE MA GAS
One NSTAR Way
Westwood, MA 02090
Phone 1-800-592-2000



MASS LAW

**Regulates 72 binary addresses
needed to Unity Component
before digging by anyone**

Call Dig-Safe: 811

IMPORTANT – DO NOT SCALE

This drawing provides approximate locations only and all facility information may not be shown. Contact EVERSOURCE VA GAS to have specific field information identified. EVERSOURCE VA GAS disclaims any liability resulting from the reliance by any person on the location shown on this map. Massachusetts law requires that any person performing excavation work contact Dig-Date so that the location of any underground may be marked.

Address: 24 Durfee St

City/Town: New Bedford

Date Plotted: 12/13/2022