

APPLICATION/AGREEMENT

For Trench/Disturbance Permit within the City of New Bedford

Permit # 49-2022

Dig Safe# 20220500726

Date: 2/1/2022

TO THE MAYOR AND CITY COUNCIL:

DISTURBANCE PERMIT/TRENCH SAFETY PERMIT

Permission is hereby requested to excavate the surface of: X City Property and/or X Private Property

Provide Sketch

Location of Work: 117-119 Sylvia St.

Belleville Ave. - Brightman St.

Relay Gas Service

Work will begin (weather permitting) on: February 15, 2022

Applicant Name: Kevin O'Sullivan (ra)

Excavator(s) Name: \_\_\_\_\_

Company Name: Eversource

Hoisting Equipment License Number: \_\_\_\_\_

Grade: \_\_\_\_\_ Expiration Date: \_\_\_\_\_

Contact Number: 508-441-5817

Name & Contact Number of Insurer: \_\_\_\_\_

Competent Person on Work Site: ON FILE

APPROVED BY: Stephen Cupfaro DATE: 2-7-2022

TITLE: Asst. City Engineer

This permit shall be posted at the work site, and shall remain until the work is completed. It is subject to inspection at all times.

Trenches must be maintained  
weekly until final paving is  
completed

ROADWAY CLOSURES WILL REQUIRE  
AUTHORIZATION FROM THE  
COMMISSIONER OF PUBLIC  
INFRASTRUCTURE. TRAFFIC MANAGEMENT  
PLANS MAY BE REQUIRED.

Permit only valid for three months  
from date of approval

U

U

A I 30  
B 19

130-132  
25' 1.0" PY 2008

125  
B 15' 1.25" \* 1924  
A 12' 1.25" \* 1923

33' 1.25" ST 1901

117-119

33' 1.5" ST

PROPOSED WORK AREA

SYLVIA ST

237' 6" CL LP 1901

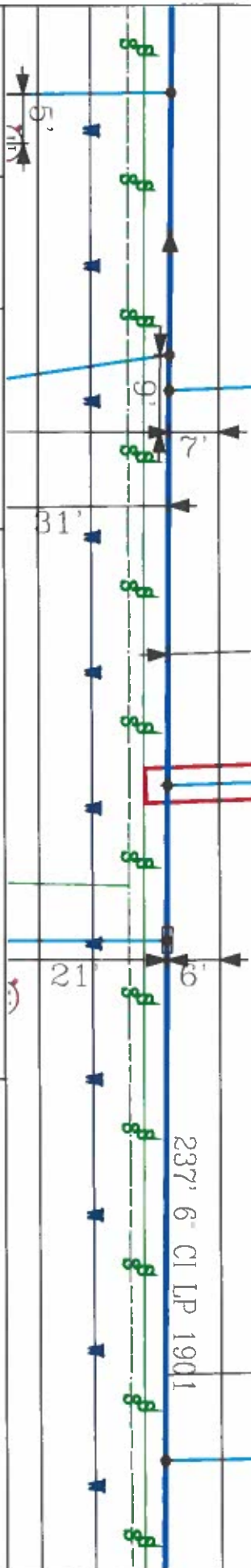

**EVERSOURCE**

EVERSOURCE MA GAS  
One NSTAR Way  
Bedford, MA 02090  
Phone 1-800-692-2000



**MASS LAW**

Regulate the layout, siting, and construction of utility equipment before digging begins  
Call Dig-Safe: 811

**IMPORTANT - DO NOT SCALE**

Map drawing provided represents location only and all facility information must be verified by the user. EVERSOURCE MA GAS disclaims any liability resulting from the reliance by any person on the location shown on this map. Users must verify the required that any person performing excavation work contact Dig-Safe so that the location of any underground may be marked.

**Address:** 117-119 Sylvia St WL

**City/Town:** New Bedford 1/28/22

Date Plotted: 01/28/2022