

APPLICATION/AGREEMENT
For Trench/Disturbance Permit within the City of New Bedford

Permit # 465-2022
Dig Safe# 20224008552
Date: 10/5/2022

TO THE MAYOR AND CITY COUNCIL: DISTURBANCE PERMIT/TRENCH SAFETY PERMIT

Permission is hereby requested to excavate the surface of: X City Property and/or X Private Property
Provide Sketch

Location of Work: 539-541 N. Front St.
Whitman St. - Wkg on N. Front St. side
Gas Line Maintenance

Work will begin (weather permitting) on: October 19, 2022

Applicant Name: Steven Botelho (ra)

Excavator(s) Name: _____

Company Name: Eversource

Hoisting Equipment License Number: _____
Grade: _____ Expiration Date: _____

Contact Number: 508-441-5817

Name & Contact Number of Insurer: _____

Competent Person on Work Site: ON FILE

APPROVED BY: Stephen Cyprian DATE: 10-13-22
TITLE: Asst. City Engineer

This permit shall be posted at the work site, and shall remain until the work is completed. It is subject to inspection at all times.

**Trenches must be maintained
weekly until final paving is
completed**

**Permit only valid for three months
from date of approval**

**ROADWAY CLOSURES WILL REQUIRE
AUTHORIZATION FROM THE
COMMISSIONER OF PUBLIC
INFRASTRUCTURE. TRAFFIC MANAGEMENT
PLANS MAY BE REQUIRED.**

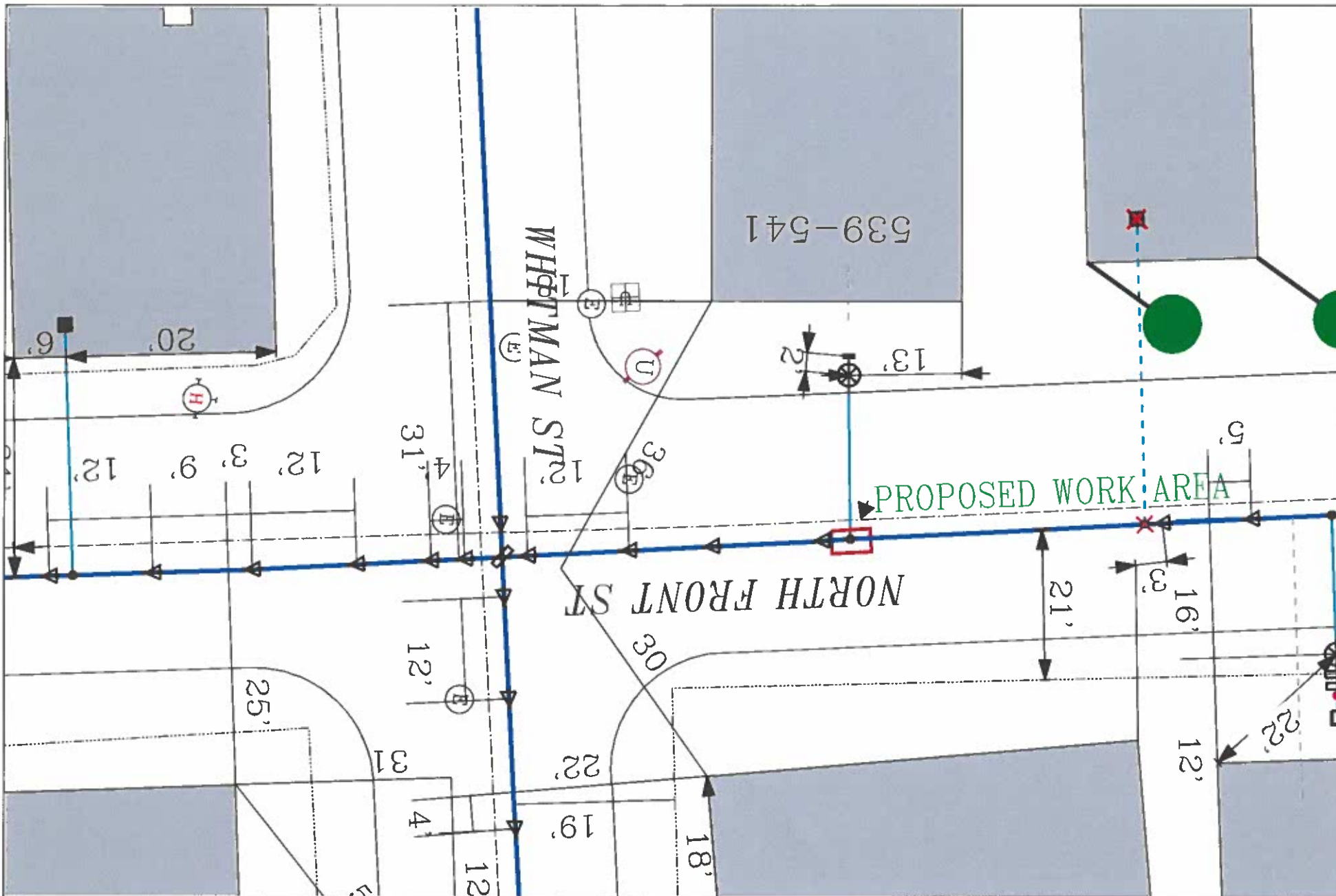

<p>EVERSOURCE</p> <p>EVERSOURCE MA GAS One NSTAR Way Westwood, MA 02090 Phone 1-800-592-2000</p>		<p>MASS LAW</p> <p>Requires 72 hours advance notice to Utility Companies before digging by Anyone</p> <p>Call Dig-Safe: 811</p>	<p>IMPORTANT - DO NOT SCALE</p> <p>This drawing provides approximate locations only and all facility information may not be shown. Contact EVERSOURCE MA GAS to have specific field information identified. EVERSOURCE MA GAS disclaims any liability resulting from the reliance by any person on the location shown on this map. Massachusetts law requires that any person performing excavation work contact Dig-Safe so that the location of any underground may be marked.</p>	<p>Address: 539-541 North Front St</p> <p>City/Town: New Bedford</p>
---	---	--	---	--