

## APPLICATION/AGREEMENT

Permit # 443-2000

For Trench/Disturbance Permit within the City of New Bedford

Dig Safe# 20223914653Date: 9/30/2022

TO THE MAYOR AND CITY COUNCIL:

DISTURBANCE PERMIT/TRENCH SAFETY PERMIT

Permission is hereby requested to excavate the surface of: X City Property and/or X Private Property

Provide Sketch

Location of Work: 224 Church St.Query St. - Glennon St.Relay Gas ServiceWork will begin (weather permitting) on: October 14, 2022Applicant Name: Steven Botelho (a)

Excavator(s) Name: \_\_\_\_\_

Company Name: Eversource

Hoisting Equipment License Number: \_\_\_\_\_

Grade: \_\_\_\_\_ Expiration Date: \_\_\_\_\_

Contact Number: 508-441-5817

Name &amp; Contact Number of Insurer: \_\_\_\_\_

Competent Person on Work Site: ON FILEAPPROVED BY: Stephen Costa DATE: 10-5-2022TITLE: Asst. City Engineer

This permit shall be posted at the work site, and shall remain until the work is completed. It is subject to inspection at all times.

ROADWAY CLOSURES WILL REQUIRE  
AUTHORIZATION FROM THE  
COMMISSIONER OF PUBLIC  
INFRASTRUCTURE TRAFFIC MANAGEMENT  
PLANS MAY BE REQUIRED.Trenches must be maintained  
weekly until final paving is  
completedPermit only valid for three months  
from date of approval

32' 1.0" PH 202021' 1.25" ST 1901

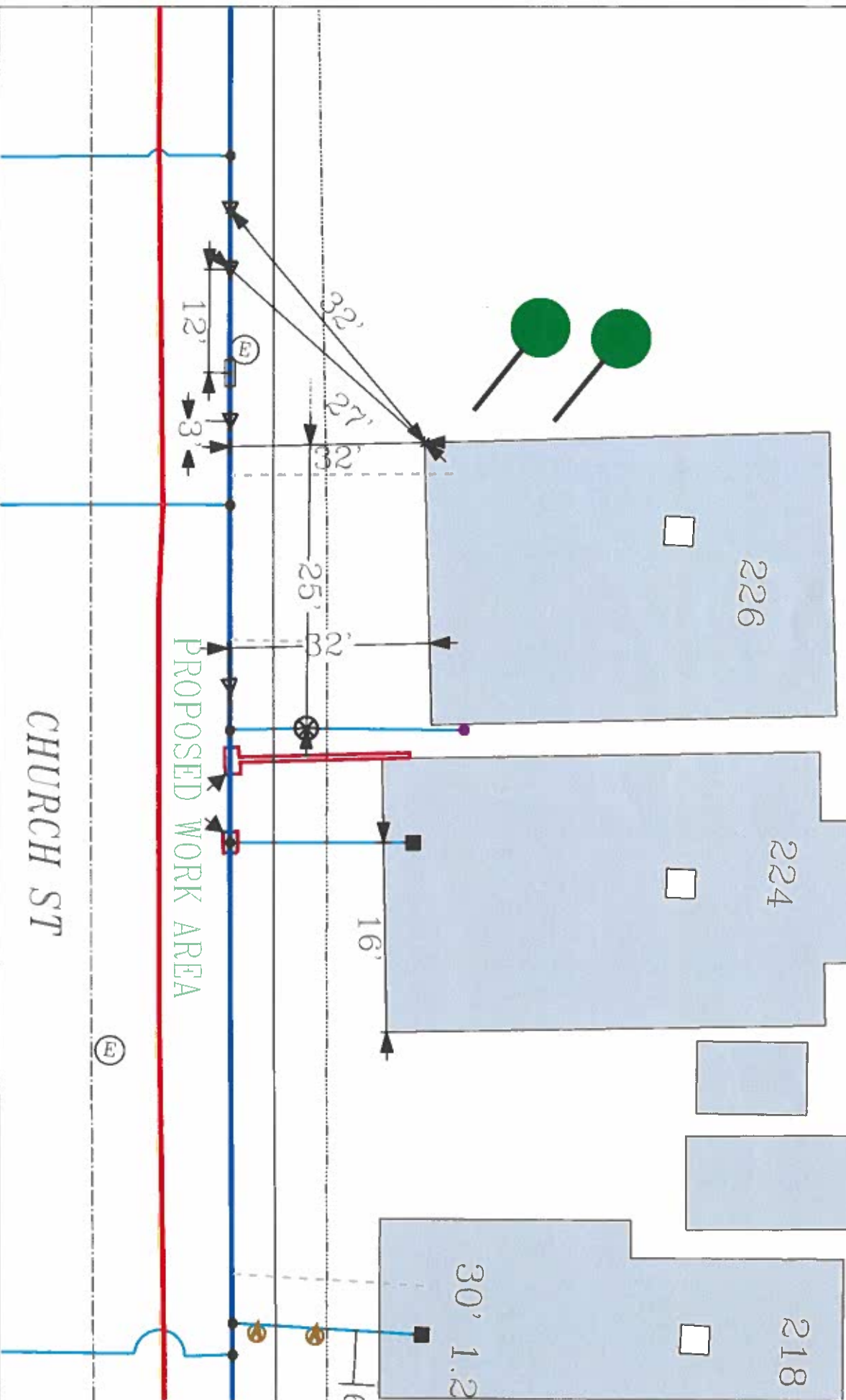

**EVERSOURCE**

EVERSOURCE MA GAS  
One NSTAR Way  
Boston, MA 02109  
Phone 1-800-592-2000

**MASS LAW**

Any person who excavates  
without a permit  
is guilty of a crime

Call Dig-Safe: 811

**IMPORTANT! - DO NOT SCALE**

Field drawings provided are for informational purposes only and are not to be used for any other purpose. Information provided is not to be used for any other purpose. Information provided is not to be used for any other purpose. Information provided is not to be used for any other purpose.

Address: 224 Church St

City/Town: New Bedford

Date Plotted: 09/29/2022