

APPLICATION/AGREEMENT

Permit # 1424-232

For Trench/Disturbance Permit within the City of New Bedford

Dig Safe#20223807880Date: 09/21/2022

TO THE MAYOR AND CITY COUNCIL:

DISTURBANCE PERMIT/TRENCH SAFETY PERMIT

Permission is hereby requested to excavate the surface of: X City Property and/or X Private Property
Provide SketchLocation of Work: 157 Armsby StBetween Pine Grove St and Metcalf St. Working in the street.Gas line maintenance.Work will begin (weather permitting) on: October 5, 2022Applicant Name: Steven Botelho (gk) Excavator(s) Name: _____Company Name: Eversource Hoisting Equipment License Number: _____

Grade: _____ Expiration Date: _____

Contact Number: 339-987-8010 Name & Contact Number of Insurer: _____Competent Person on Work Site: ON FILEAPPROVED BY: Stephen CristaDATE: 10-4-2022TITLE: Asst City Engineer**This permit shall be posted at the work site, and shall remain until the work is completed. It is subject to inspection at all times.****Trenches must be maintained
weekly until final paving is
completed**Permit only valid for three months
from date of approvalROADWAY CLOSURES WILL REQUIRE
AUTHORIZATION FROM THE
COMMISSIONER OF PUBLIC
INFRASTRUCTURE. TRAFFIC MANAGEMENT
PLANS MAY BE REQUIRED.

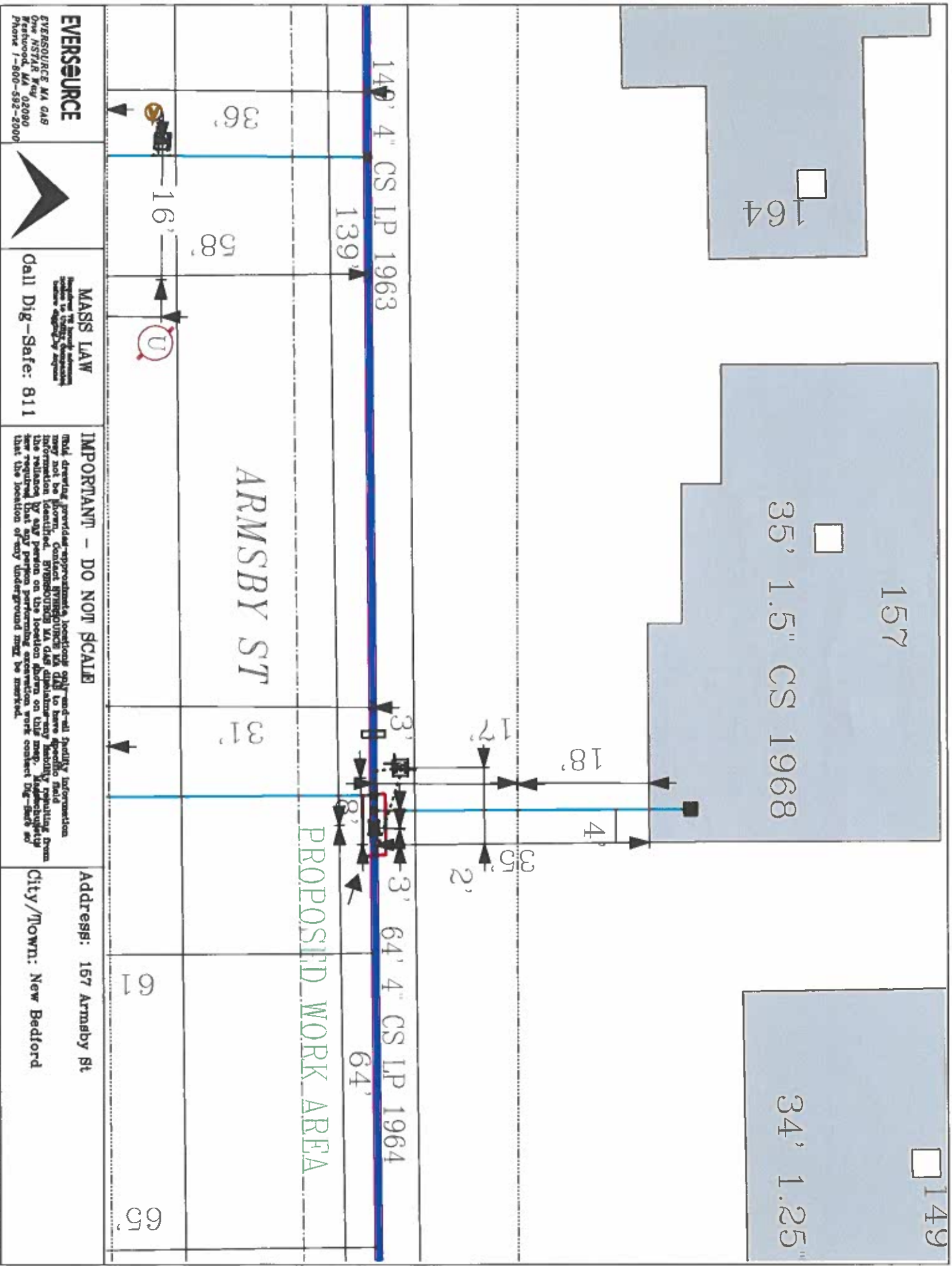

EVERSOURCE

EVERSOURCE MA GAS
One NSTAR Way
Bedford, MA 03309
Phone 1-800-582-2000



MASIS LAW

Impose 10 foot minimum
setback to existing underground
utilities adjacent to easement

Call Dig-Safe: 811

IMPORTANT - DO NOT SCALE

This drawing provides approximate locations only and all specific information
may not be shown. Contractors are to have specific field
verification of all utilities shown. Eversource MA GAS does not warrant the
accuracy of any information on this map. Verifying from
the field is the responsibility of the contractor. The location of any underground may be marked.

Address: 167 Armsby St

City/Town: New Bedford