

APPLICATION/AGREEMENT

For Trench/Disturbance Permit within the City of New Bedford

Permit # 113 2032

Dig Safe# 20223512546

Date: 9/1/2022

TO THE MAYOR AND CITY COUNCIL:

DISTURBANCE PERMIT/TRENCH SAFETY PERMIT

Permission is hereby requested to excavate the surface of: X City Property and/or X Private Property

Provide Sketch

Location of Work: 1471 Morton Ave.

Ivers St

Install Gas Service

Work will begin (weather permitting) on: September 15, 2022

Applicant Name: Steven Botelho (ra)

Excavator(s) Name: _____

Company Name: Eversource

Hoisting Equipment License Number: _____

Grade: _____ Expiration Date: _____

Contact Number: 508-441-5817

Name & Contact Number of Insurer: _____

Competent Person on Work Site: ON FILE

APPROVED BY: Stephen Cepeda DATE: 9-21-2022

TITLE: Asst. City Engineer

This permit shall be posted at the work site, and shall remain until the work is completed. It is subject to inspection at all times.

ROADWAY CLOSURES WILL REQUIRE
AUTHORIZATION FROM THE
COMMISSIONER OF PUBLIC
INFRASTRUCTURE. TRAFFIC MANAGEMENT
PLANS MAY BE REQUIRED.

Permit only valid for three months
from date of approval

**Trenches must be maintained
weekly until final paving is
completed**

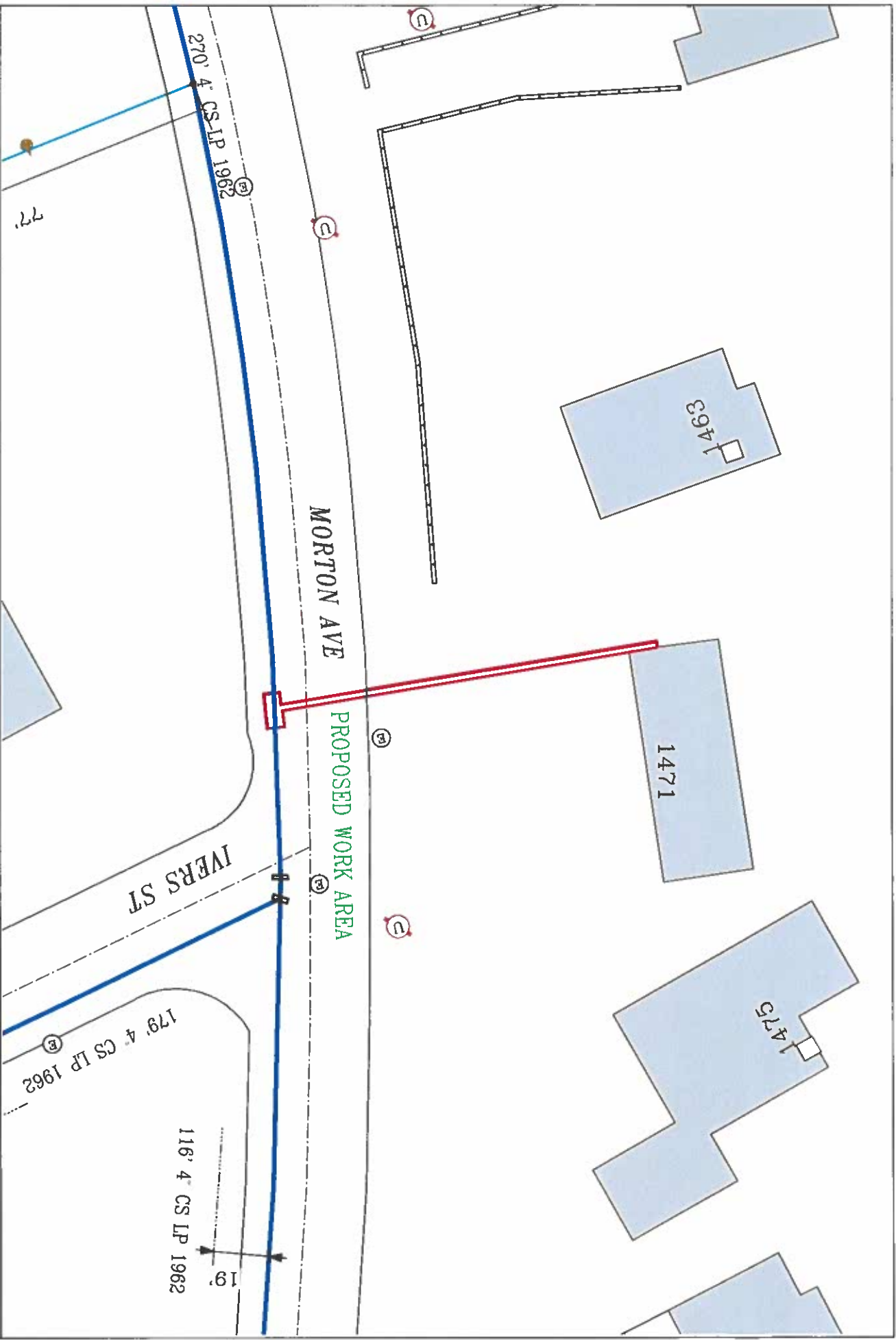

EVERSOURCE

EVERSOURCE MA GAS
One NORTHEAST
Bedford, MA 02090
Phone 1-800-532-2000

MASS LAW

Regulation 18 requires advance
notice to utility companies
before digging by anyone

Call Dig-Safe: 811

IMPORTANT - DO NOT SCALE

This drawing provides approximate locations only and all facility information
may not be shown. Contact EVERSOURCE MA GAS to have specific field
information identified. EVERSOURCE MA GAS disclaims any liability resulting from
the reliance by any person on the location shown on this map. Massachusetts
law requires that any person performing excavation work contact Dig-Safe so
that the location of any underground may be marked.

Address: 1471 Moton Ave

City/Town: New Bedford

Date Plotted: 08/31/2022