

APPLICATION/AGREEMENT

Permit # 370-2037

For Trench/Disturbance Permit within the City of New Bedford

Dig Safe# 20223208053Date: 8/10/2022

TO THE MAYOR AND CITY COUNCIL:

DISTURBANCE PERMIT/TRENCH SAFETY PERMIT

Permission is hereby requested to excavate the surface of: X City Property and/or X Private Property

Provide Sketch

Location of Work: 138-140 Sylvia St.Acushnet Ave. - Brightman St.Relay Gas ServiceWork will begin (weather permitting) on: August 24, 2022Applicant Name: Steven Botelho (a)

Excavator(s) Name: _____

Company Name: Eversource

Hoisting Equipment License Number: _____

Grade: _____ Expiration Date: _____

Contact Number: 508-441-5817

Name & Contact Number of Insurer: _____

Competent Person on Work Site: ON FILEAPPROVED BY: Stephen Lyda DATE: 9-10-22TITLE: Asst. City EngineerThis permit shall be posted at the work site, and shall remain until the work is completed. It is subject to inspection at all times.Trenches must be maintained
weekly until final paving is
completedPermit only valid for three months
from date of approvalROADWAY CLOSURES WILL REQUIRE
AUTHORIZATION FROM THE
COMMISSIONER OF PUBLIC
INFRASTRUCTURE. TRAFFIC MANAGEMENT
PLANS MAY BE REQUIRED.

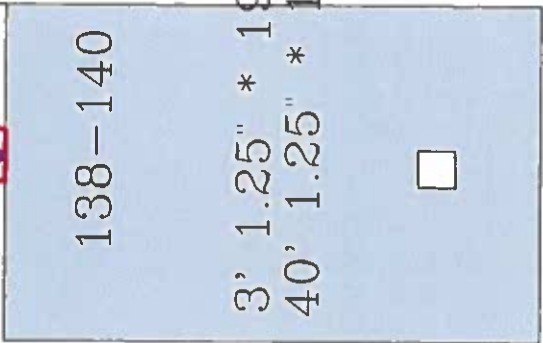
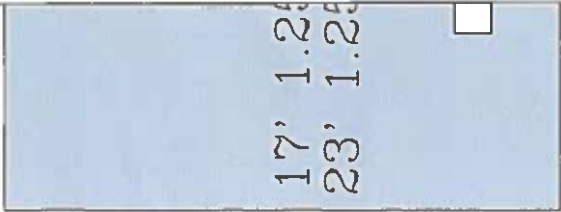

53' 0.5" 201 YD

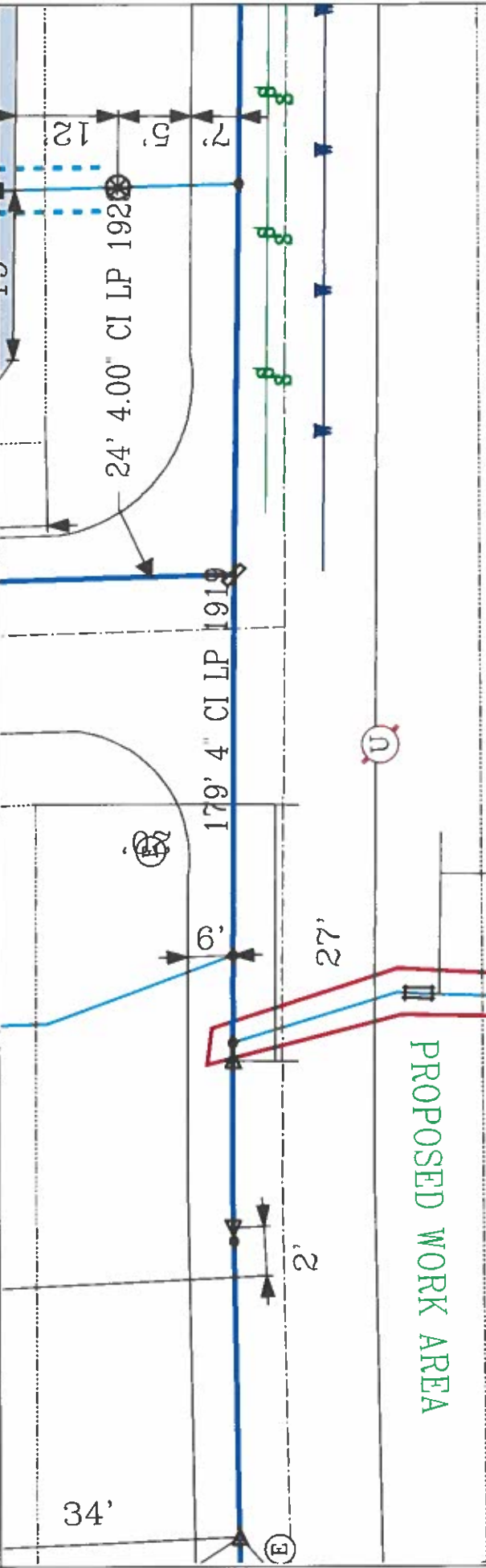

EVERSOURCE EVERSOURCE MA GAS One NSTAR Way Bedford, MA 02090 Phone 1-800-392-2000		MASS LAW Regulation 78 hours advance notice to Utility Companies before digging of anyone	IMPORTANT - DO NOT SCALE This drawing provides approximate locations only and all facility information may change. Eversource MA GAS to share specific field information identified. Eversource MA GAS disavows any liability resulting from the reliance by any person on the location shown on this map. Massachusetts law requires that any person performing excavation work contact Dig-State so that the location of any underground may be marked.	Address: 138-140 Sylvia St City/Town: New Bedford CD
--	--	---	--	---