

## APPLICATION/AGREEMENT

For Trench/Disturbance Permit within the City of New Bedford

Permit # 2540-20000

Dig Safe#20223314373

Date 8/19/22

TO THE MAYOR AND CITY COUNCIL:

DISTURBANCE PERMIT/TRENCH SAFETY PERMIT

Permission is hereby requested to excavate the surface of: X City Property and/or X Private Property  
Provide SketchLocation of Work: 39 Maitland St  
Cross st Richmond St corner property working on Maitland St side Working street  
Gas line maintenanceWork will begin (weather permitting) on: September 2, 2022Applicant Name: Steven Botelho (sl)

Excavator(s) Name: \_\_\_\_\_

Company Name: Eversource

Hoisting Equipment License Number: \_\_\_\_\_

Grade: \_\_\_\_\_ Expiration Date: \_\_\_\_\_

Contact Number: 339-987-8010

Name &amp; Contact Number of Insurer: \_\_\_\_\_

Competent Person on Work Site: ON FILEAPPROVED BY: Stephen Cuppa DATE: 9-11-22TITLE: Asst. City Engineer**This permit shall be posted at the work site, and shall remain until the work is completed. It is subject to inspection at all times.****Trenches must be maintained  
weekly until final paving is  
completed**Permit only valid for three months  
from date of approvalROADWAY CLOSURES WILL REQUIRE  
AUTHORIZATION FROM THE  
COMMISSIONER OF PUBLIC  
INFRASTRUCTURE. TRAFFIC MANAGEMENT  
PLANS MAY BE REQUIRED.

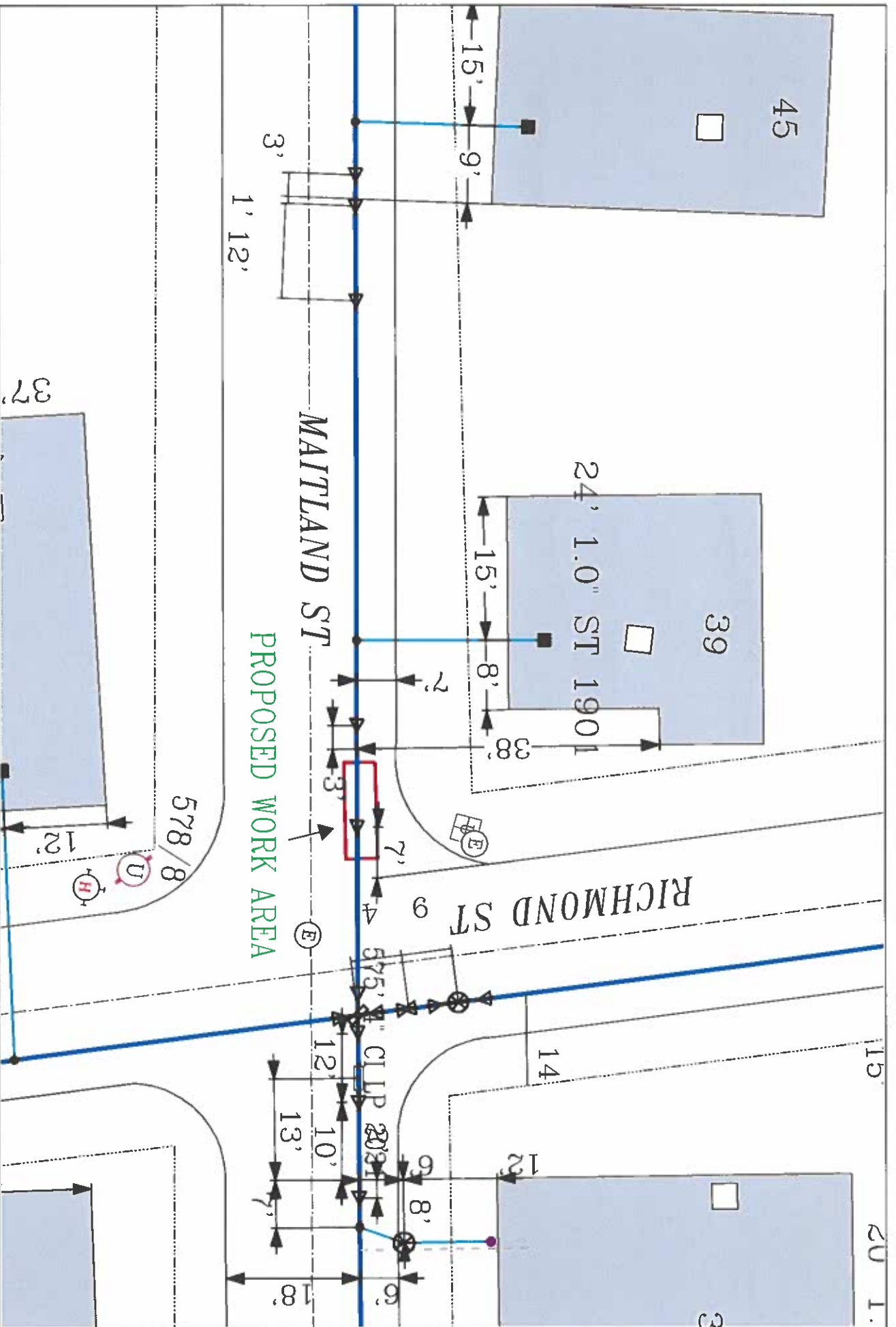

**EVERSOURCE**  
EVERSOURCE MA GAS  
One N STATE ST  
Providence, RI 02903  
Phone 1-800-582-2000



**MASS LAW**  
Regulate 72 hour advance  
notice to Utility Companies  
before digging by anyone  
**Call Dig-Safe: 811**

**IMPORTANT - DO NOT SCALE**  
This drawing provides approximate locations only and all facility information  
must be confirmed by field inspection. EVERSOURCE MA GAS is not responsible for  
information not identified. EVERSOURCE MA GAS disclaims any liability resulting from  
the reliance by any person on the location shown on this map. Massachusetts  
law requires that any person performing excavation work contact Dig-Safe so  
that the location of any underground may be marked.

**Address:** 39 Maitland St  
**City/Town:** New Bedford