

APPLICATION/AGREEMENT

Permit # 325.2082

For Trench/Disturbance Permit within the City of New Bedford

Dig Safe#20223102243

Date: 08/01/2022

TO THE MAYOR AND CITY COUNCIL:

DISTURBANCE PERMIT/TRENCH SAFETY PERMIT

Permission is hereby requested to excavate the surface of: X City Property and/or X Private Property

Provide Sketch

Location of Work: 49 Rochambeau St

Between Carlisle St and Irvington St. Working in the street and street to building.

Relay gas service.

Work will begin (weather permitting) on: August 15, 2022

Applicant Name: Steven Botelho (gk)

Excavator(s) Name: _____

Company Name: Eversource

Hoisting Equipment License Number: _____

Grade: _____ Expiration Date: _____

Contact Number: 339-987-8010

Name & Contact Number of Insurer: _____

Competent Person on Work Site: ON FILE

APPROVED BY: Stephen Capota DATE: 8-1-22

TITLE: Asst. City Engineer

This permit shall be posted at the work site, and shall remain until the work is completed. It is subject to inspection at all times.

**Trenches must be maintained
weekly until final paving is
completed**

ROADWAY CLOSURES WILL REQUIRE
AUTHORIZATION FROM THE
COMMISSIONER OF PUBLIC
INFRASTRUCTURE. TRAFFIC MANAGEMENT
PLANS MAY BE REQUIRED.

Permit only valid for three months
from date of approval

47' 1.0" PY 2008

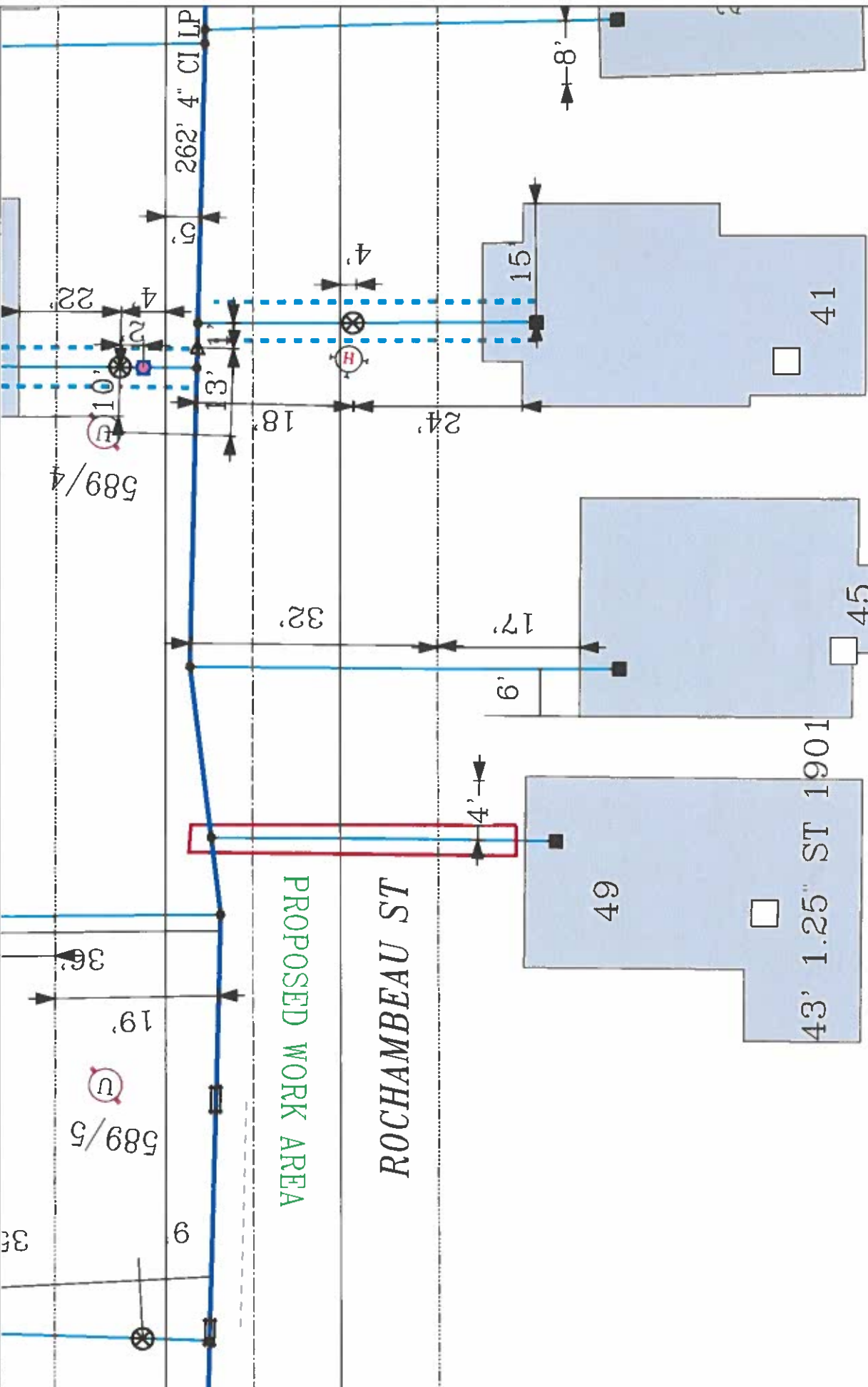

EVERSOURCE

EVERSOURCE MA GAS
One NSTAR Way
Westford, MA 02090
Phone 1-800-592-2000



MASB LAW

Massachusetts law requires that utility locations be shown on all excavation permits. Call Dig-Safe: 811

IMPORTANT - DO NOT SCALE

This drawing provides approximate locations only and all facility information may not be shown. Contact EVERSOURCE MA GAS to have specific field information identified. EVERSOURCE MA GAS disclaims any liability resulting from the reliance by any person on the location shown on this map. Massachusetts law requires that any person performing excavation work contact Dig-Safe so that the location of any underground may be marked.

Address: 49 Rochambeau St

City/Town: New Bedford **CD**