

APPLICATION/AGREEMENT

Permit # 215-2022

For Trench/Disturbance Permit within the City of New Bedford

Dig Safe # 20223115086

Date: 8/5/2022

TO THE MAYOR AND CITY COUNCIL: DISTURBANCE PERMIT/TRENCH SAFETY PERMIT

Permission is hereby requested to excavate the surface of: X City Property and/or X Private Property
Provide Sketch

Location of Work: 141 Earle St

Cross streets N-Front St and Madiera Ave Working street & street to house

Relay gas service

Work will begin (weather permitting) on: August 19, 2022

Applicant Name: Steven Botelho (sl) Excavator(s) Name: _____

Company Name: Eversource Hoisting Equipment License Number: _____

Grade: _____ Expiration Date: _____

Contact Number: 339-987-8010 Name & Contact Number of Insurer: _____

Competent Person on Work Site: ON FILE APPROVED BY: Stephen Capata DATE: 8-11-22

TITLE: Asst. City Engineer

This permit shall be posted at the work site, and shall remain until the work is completed. It is subject to inspection at all times.

Trenches must be maintained
weekly until final paving is
completed

ROADWAY CLOSURES WILL REQUIRE
AUTHORIZATION FROM THE
COMMISSIONER OF PUBLIC
INFRASTRUCTURE. TRAFFIC MANAGEMENT
PLANS MAY BE REQUIRED.

Permit only valid for three months
from date of approval

32' 1.0" PD 1986

27' 1.0" PD 1986

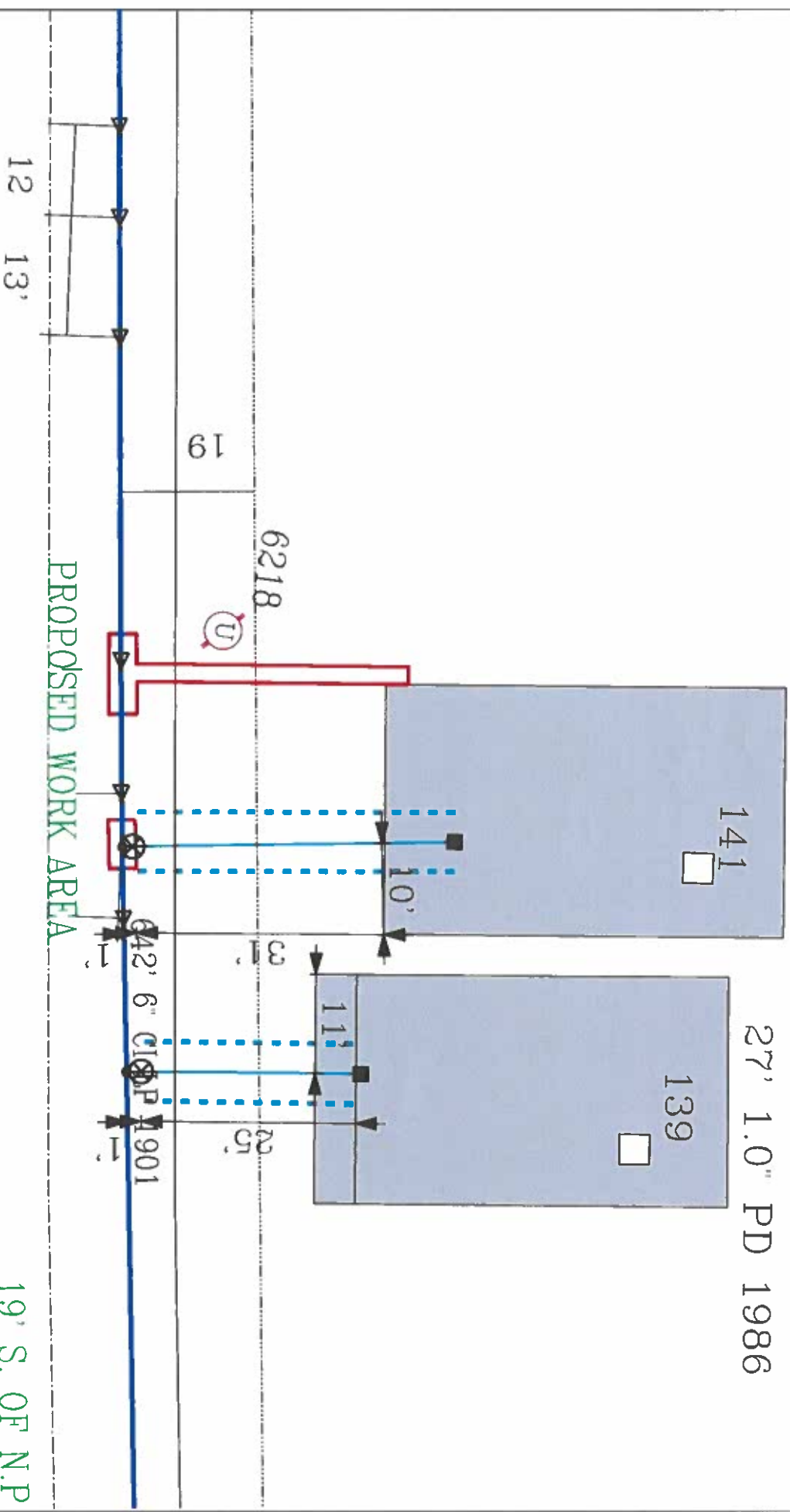

EARLE ST

19' S. OF N.P

EVERSOURCE

EVERSOURCE MA GAS
One NSTAR Way 02090
Bedford MA
Phone 1-800-592-2000



MASS LAW

Excavate 72 hours advance
notice to utility companies
before digging by anyone

Call Dig-Safe: 811

IMPORTANT - DO NOT SCALE

While drawing provided approximate locations only and all facility information may not be shown. Contact EVERSOURCE MA GAS to have precise field information identified. EVERSOURCE MA GAS disclaims any liability resulting from the reliance by any person on the location shown on this map. Massachusetts law requires that any person performing excavation work contact Dig-Safe so that the location of any underground may be marked.

Address: 141 Earle St

City/Town: New Bedford