

APPLICATION/AGREEMENT
For Trench/Disturbance Permit within the City of New Bedford

Permit # 255-2022
Dig Safe# 20222204623
Date: 06/01/2022

TO THE MAYOR AND CITY COUNCIL: DISTURBANCE PERMIT/TRENCH SAFETY PERMIT

Permission is hereby requested to excavate the surface of: X City Property and/or X Private Property
Provide Sketch

Location of Work: 26 Stephanie Pl
Cross street Monica's Way. Working in the street and sidewalk.
Gas service retirement.

Work will begin (weather permitting) on: June 15, 2022

Applicant Name: Steven Botelho (gk) Excavator(s) Name: _____

Company Name: Eversource Hoisting Equipment License Number: _____
Grade: _____ Expiration Date: _____

Contact Number: 339-987-8010 Name & Contact Number of Insurer: _____

Competent Person on Work Site: ON FILE

APPROVED BY: Stephan Cypher DATE: 6-29-22
TITLE: Asst. City Engineer

This permit shall be posted at the work site, and shall remain until the work is completed. It is subject to inspection at all times.

ROADWAY CLOSURES WILL REQUIRE
AUTHORIZATION FROM THE
COMMISSIONER OF PUBLIC
INFRASTRUCTURE. TRAFFIC MANAGEMENT
PLANS MAY BE REQUIRED.

Permit only valid for three months
from date of approval

Trenches must be maintained
weekly until final paving is
completed

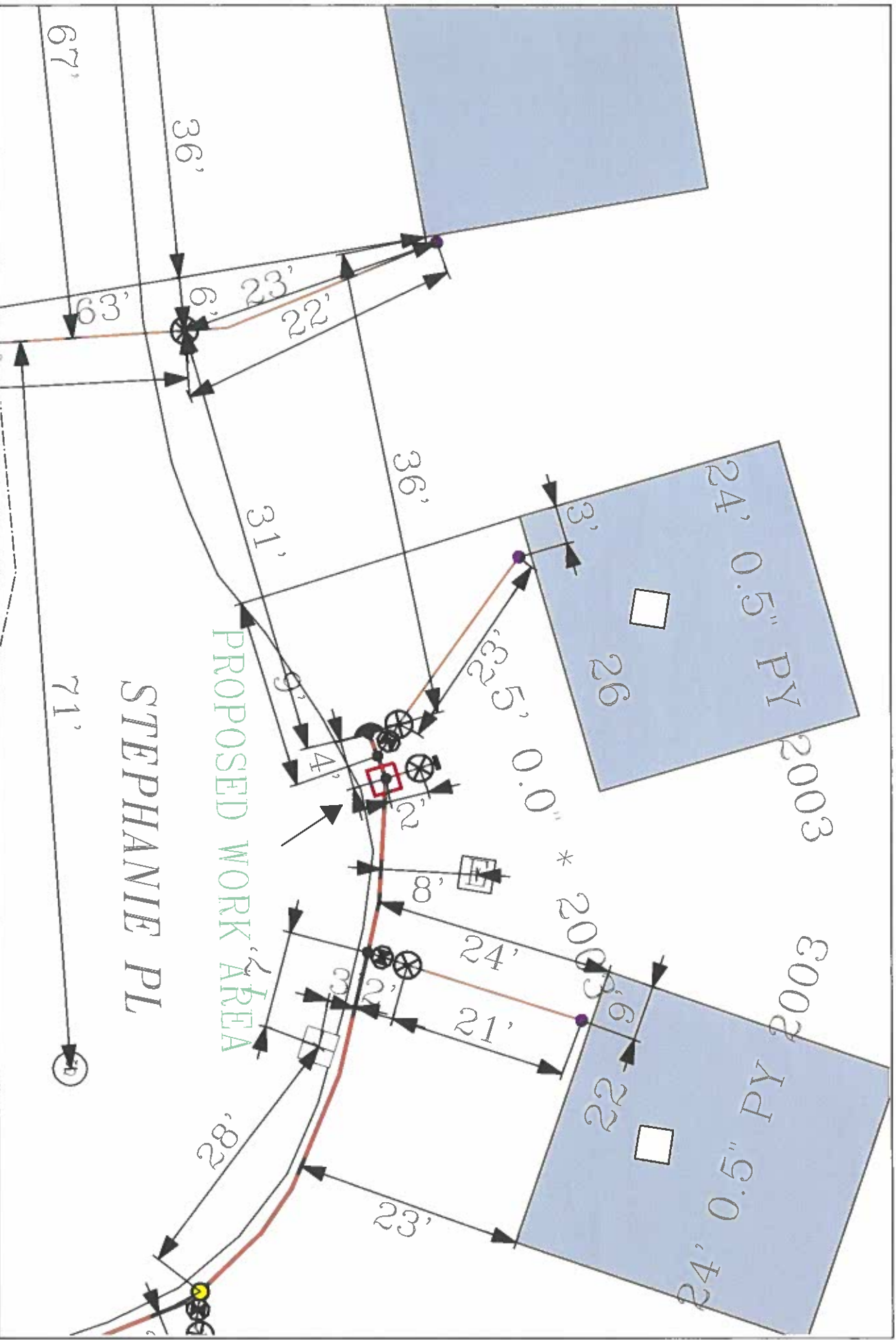

EVERSOURCE
 EVERSOURCE MA GAS
 The NSTAR Key
 Bedford, MA 03090
 Phone 1-800-582-2000



MASS LAW
 Regarding the handling and disposal
 of hazardous waste, Massachusetts
 requires a permit for any person
 who handles, stores, transports, or
 disposes of hazardous waste.
 Call Dig-Safe: 811

IMPORTANT - DO NOT SCALE
 While drawing, provide appropriate location and all facility information
 including but not limited to: EVERSOURCE MA GAS distribution facility, including
 information identifying the location and on this map, Massachusetts
 law requires that any person performing excavation work contact Dig-Safe so
 that the location of any underground may be marked.

Address: 26 Stephanie Pl
City/Town: New Bedford