

APPLICATION/AGREEMENT
For Trench/Disturbance Permit within the City of New Bedford

Permit # 195-2002
Dig Safe# 20222017297
Date: 05/20/2022

TO THE MAYOR AND CITY COUNCIL: DISTURBANCE PERMIT/TRENCH SAFETY PERMIT

Permission is hereby requested to excavate the surface of: X City Property and/or X Private Property
Provide Sketch

Location of Work: Shawmut Ave (Coggeshall St to 195 over pass)
~~Cross St-Kennedy St. Working in the street & intersection on Shawmut Ave appx. 50 ft. south of #697.~~
Gas line maintenance.

Work will begin (weather permitting) on: June 3, 2022

Applicant Name: Steven Botelho (gk) Excavator(s) Name: _____

Company Name: Eversource Hoisting Equipment License Number: _____
Grade: _____ Expiration Date: _____

Contact Number: 508-441-5124 Name & Contact Number of Insurer: _____

Competent Person on Work Site: ON FILE APPROVED BY: Stephen Lydon DATE: 5-23-22

TITLE: Asst. City Engineer

This permit shall be posted at the work site, and shall remain until the work is completed. It is subject to inspection at all times.

ROADWAY CLOSURES WILL REQUIRE
AUTHORIZATION FROM THE
COMMISSIONER OF PUBLIC
INFRASTRUCTURE. TRAFFIC MANAGEMENT
PLANS MAY BE REQUIRED.

Permit only valid for three months
from date of approval

Trenches must be maintained
weekly until final paving is
completed

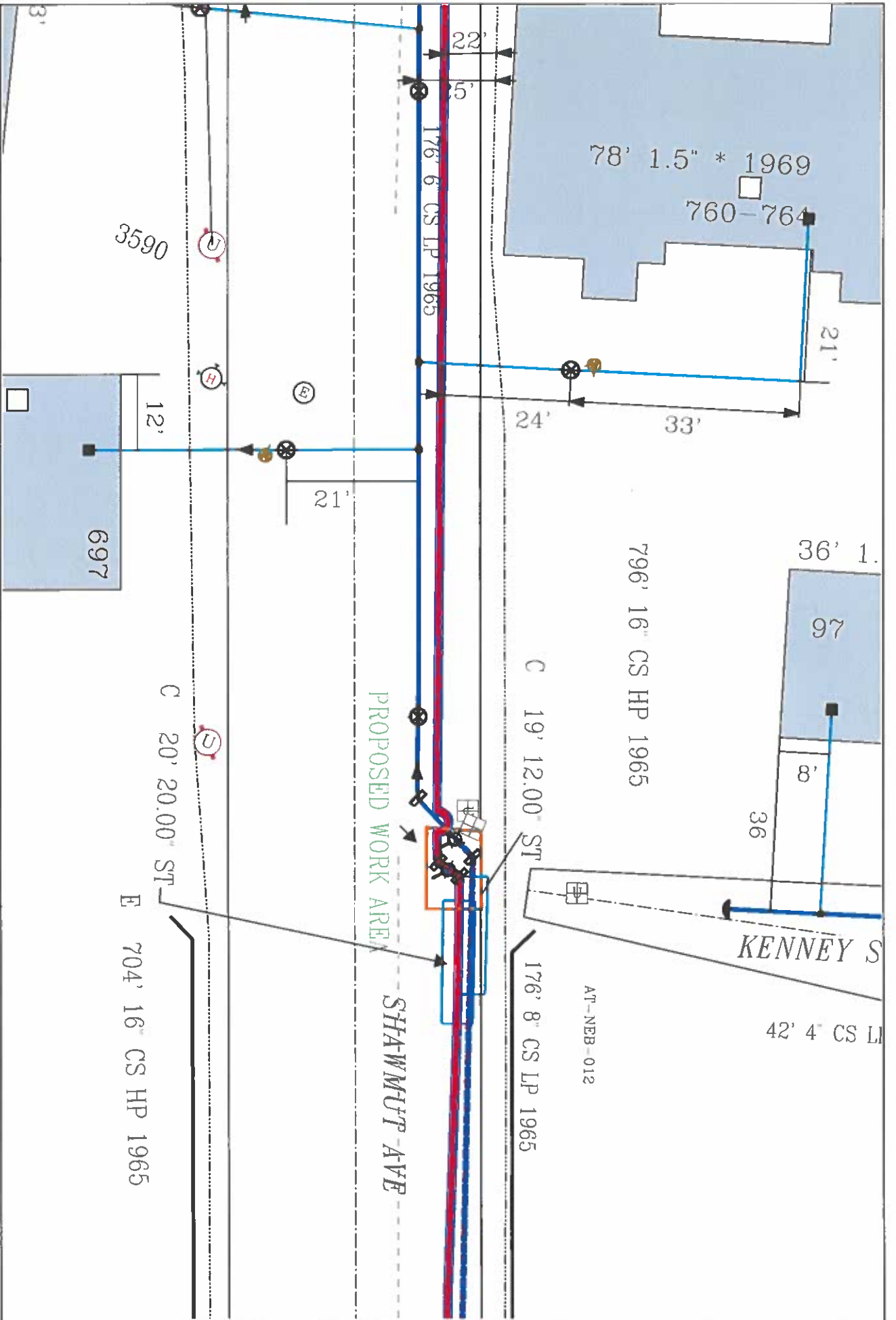

EVERSOURCE

EVERSOURCE MA GAS
600 WESTLB
Westford, MA 02090
Phone 1-800-592-2000

MASS LAW

Noting the fact that the
location of the proposed
work is shown on the
map, the location of the
work is shown on the
map.

Call Dig-Safe: 811

IMPORTANT - DO NOT SCALE

Map drawing provided represents a location only and all facility information
may not be shown. Contact EVERSOURCE MA GAS to have specific field
information identified. EVERSOURCE MA GAS disclaims any liability resulting from
the reliance by any person on the location shown on this map. It is the responsibility
that the location of any underground may be marked.

Address: Shawmut Ave & Kenney St

City/Town: New Bedford

Date Plotted: 05/20/2022