

APPLICATION/AGREEMENT

For Trench/Disturbance Permit within the City of New Bedford

Permit # 188-2022Dig Safe # 20222016964Date: 05/20/2022

TO THE MAYOR AND CITY COUNCIL:

DISTURBANCE PERMIT/TRENCH SAFETY PERMIT

Permission is hereby requested to excavate the surface of: X City Property and/or X Private Property

Provide Sketch

Location of Work: 15 Garrison Rd (Hill Rd to Poplar Rd)~~Cross street Hill Rd~~ Working in the street and street to house.Relay gas service.Work will begin (weather permitting) on: June 3, 2022Applicant Name: Steven Botelho (gk) Excavator(s) Name: _____Company Name: Eversource Hoisting Equipment License Number: _____

Grade: _____ Expiration Date: _____

Contact Number: 508-441-5124 Name & Contact Number of Insurer: _____Competent Person on Work Site: ON FILEAPPROVED BY: Stephen Cupina DATE: 5-23-2022TITLE: Asst. City EngineerROADWAY CLOSURES WILL REQUIRE
AUTHORIZATION FROM THE
COMMISSIONER OF PUBLIC
INFRASTRUCTURE, TRAFFIC MANAGEMENT
PLANS MAY BE REQUIRED.Permit only valid for three months
from date of approval**This permit shall be posted at the work site, and shall remain until the work is completed. It is subject to inspection at all times.****Trenches must be maintained
weekly until final paving is
completed**

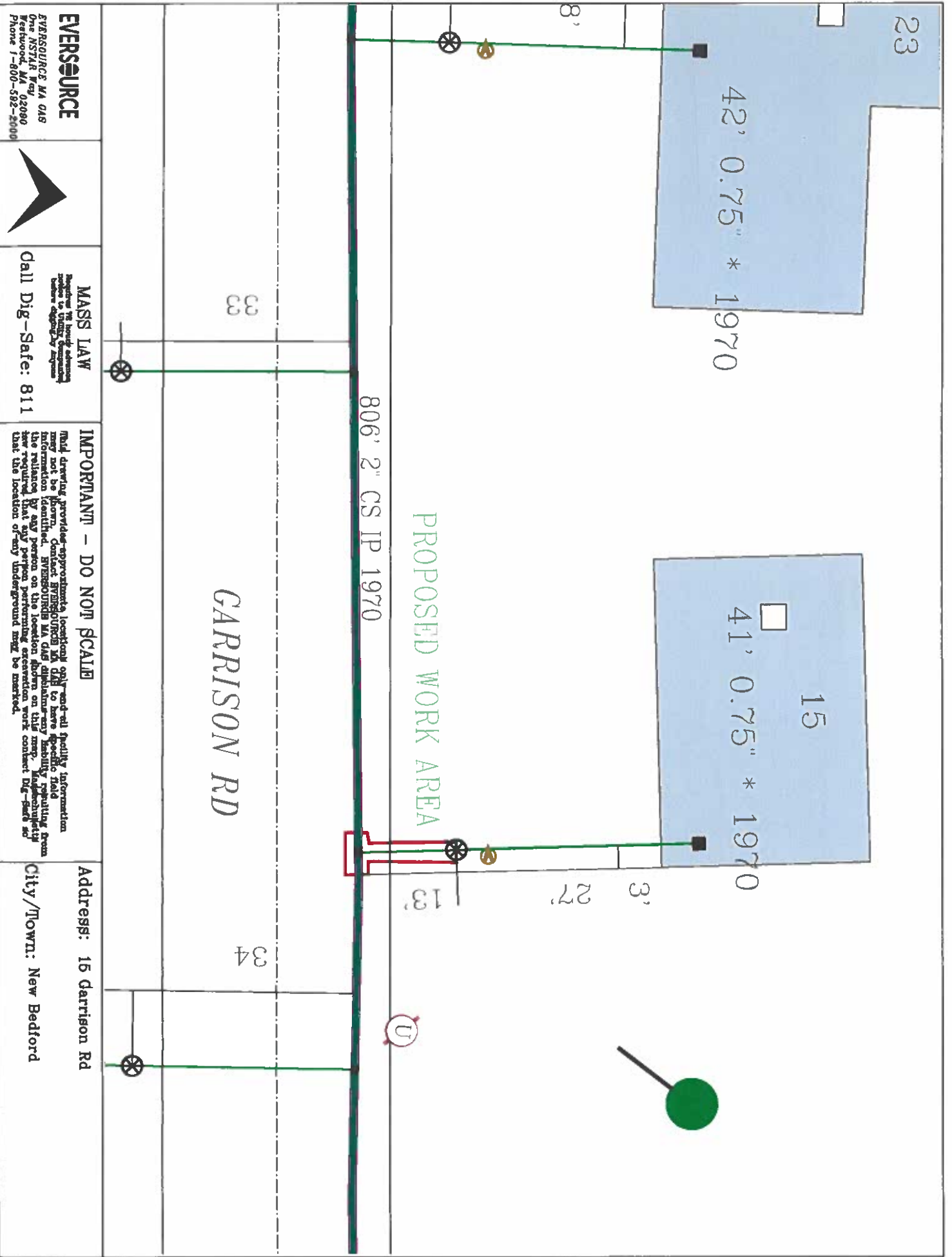

EVERSOURCE

EVERSOURCE MA GAS
One NSTAR Way
Westwood, MA 02090
Phone 1-800-582-5000



MASS LAW

Noting the fact that the location of the proposed work area is shown on this map, the location of the proposed work area is shown on this map.

Call Dig-Safe: 811

IMPORTANT - DO NOT SCALE

This drawing provides approximate location only and all facility information may not be shown. Contact EVERSOURCE MA GAS to have specific field information identified. EVERSOURCE MA GAS disclaims any liability resulting from the reliance by any person on the location shown on this map. Additionally, the required that any person performing excavation work contact Dig-Safe and that the location of any underground may be marked.

Address: 15 Garrison Rd

City/Town: New Bedford