

APPLICATION/AGREEMENT

Permit # 173, 2022

For Trench/Disturbance Permit within the City of New Bedford

Dig Safe#20221817348

Date: 05/06/2022

TO THE MAYOR AND CITY COUNCIL:

DISTURBANCE PERMIT/TRENCH SAFETY PERMIT

Permission is hereby requested to excavate the surface of: X City Property and/or X Private Property
Provide SketchLocation of Work: 5 Spruce StBetween North St & Hillman St. Working in the street and street to house.Relay gas service.Work will begin (weather permitting) on: May 20, 2022Applicant Name: Steven Botelho (gk)

Excavator(s) Name: _____

Company Name: Eversource

Hoisting Equipment License Number: _____

Grade: _____ Expiration Date: _____

Contact Number: 508-441-5817

Name & Contact Number of Insurer: _____

Competent Person on Work Site: ON FILEAPPROVED BY: Stephen Cugifera DATE: 5-10-22TITLE: Asst. City Engineer**This permit shall be posted at the work site, and shall remain until the work is completed. It is subject to inspection at all times.**ROADWAY CLOSURES WILL REQUIRE
AUTHORIZATION FROM THE
COMMISSIONER OF PUBLIC
INFRASTRUCTURE. TRAFFIC MANAGEMENT
PLANS MAY BE REQUIRED.Permit only valid for three months
from date of approvalTrenches must be maintained
weekly until final paving is
completed

A 21, 0.75" PL 1974

31' 0.5" PY 2005

29' 0.5" PY 2005

30.0

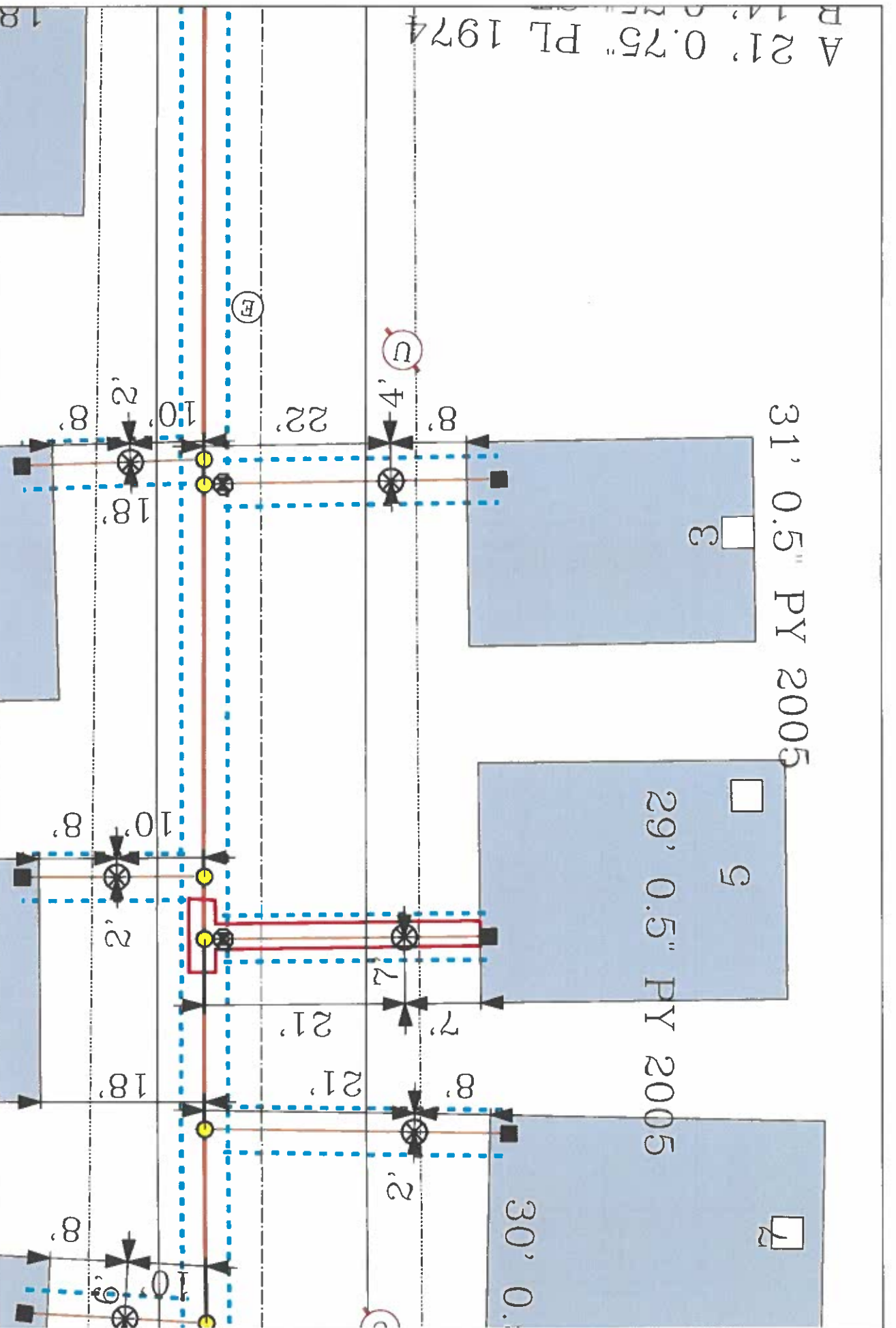

EVERSOURCE

EVERSOURCE NA GAS
One NSTAR Way
Westwood, MA 02090
Phone 1-800-592-2000



MASS LAW

Regulated TR board advances
issues to utility companies

Call Dig-Safe: 811

IMPORTANT - DO NOT SCALE

This drawing provides approximate locations only and all facility information may not be shown. Contact 877-860-0000 MA C&S to have specific field information identified. BREXIDOR® MA C&S describes any liability resulting from the reliance by any person on the location shown on this map. Massachusetts law requires that any person performing excavation work contact Dig-It-First so that the location of any underground may be marked.

Address: 5 Spruce St

City/Town: New Bedford

Date Plotted: 05/05/2022