

APPLICATION/AGREEMENT

Permit # 171-2000

For Trench/Disturbance Permit within the City of New Bedford

Dig Safe#20221808117

Date: 05/03/2022

TO THE MAYOR AND CITY COUNCIL:

DISTURBANCE PERMIT/TRENCH SAFETY PERMIT

Permission is hereby requested to excavate the surface of: X City Property and/or X Private Property

Provide Sketch

Location of Work: 519 N. Front StCross street Nash Rd. Working in the street and street to house, right side of building.Relay gas service – retirement.Work will begin (weather permitting) on: May 17, 2022Applicant Name: Steven Botelho (gk) Excavator(s) Name: _____Company Name: Eversource Hoisting Equipment License Number: _____

Grade: _____ Expiration Date: _____

Contact Number: 508-441-5817 Name & Contact Number of Insurer: _____Competent Person on Work Site: ON FILEAPPROVED BY: Stephen Costa DATE: 5-10-2022TITLE: Asst. City Engineer**This permit shall be posted at the work site, and shall remain until the work is completed. It is subject to inspection at all times.**ROADWAY CLOSURES WILL REQUIRE
AUTHORIZATION FROM THE
COMMISSIONER OF PUBLIC
INFRASTRUCTURE. TRAFFIC MANAGEMENT
PLANS MAY BE REQUIRED.Permit only valid for three months
from date of approvalTrenches must be maintained
weekly until final paving is
completed

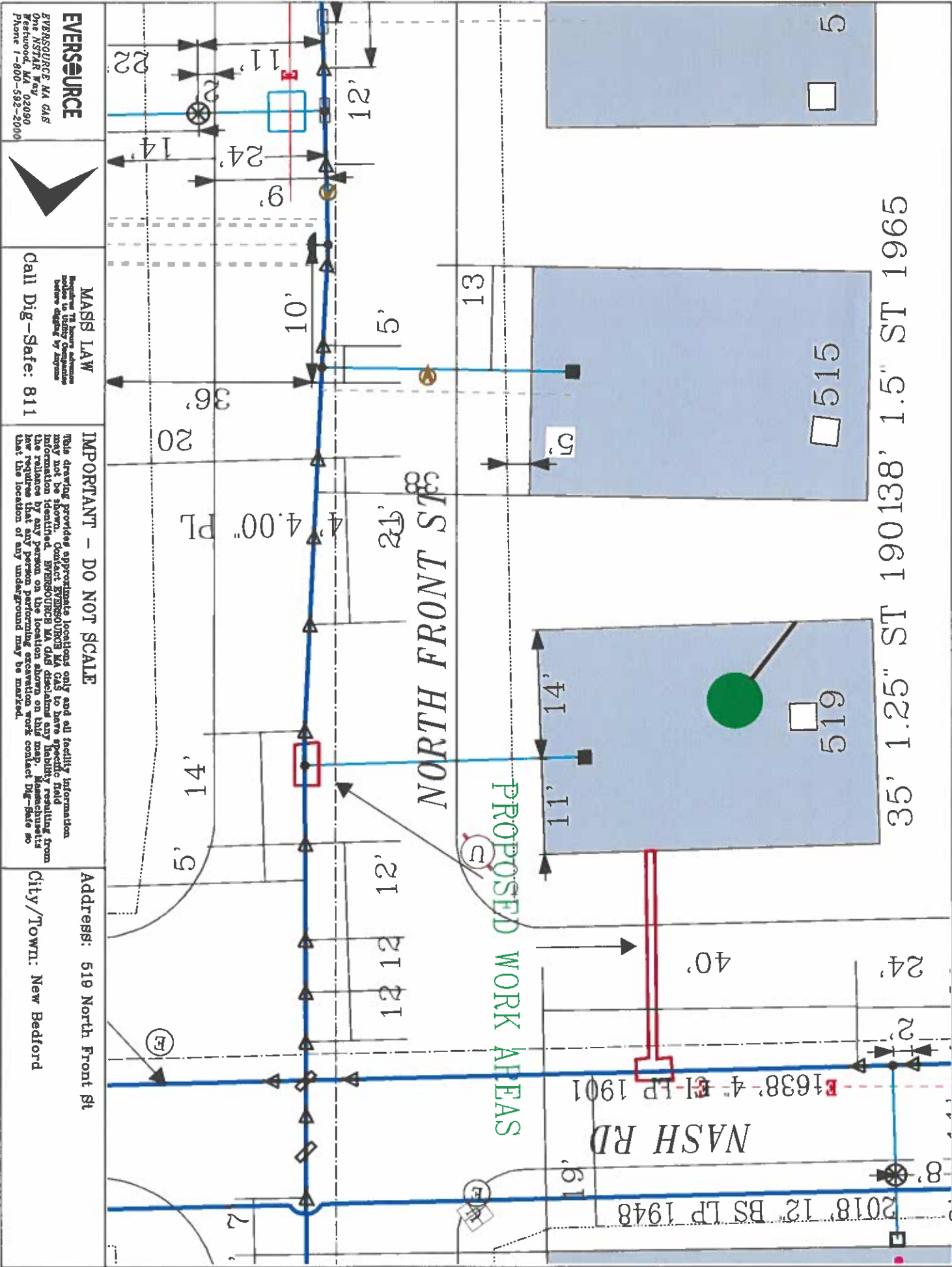

EVERSOURCE

EVERSOURCE MA GAS
100 NORTH ST
NEW BEDFORD, MA 01909
Phone 1-800-582-2000

MASS LAW

Requires 72 hour advance
notice to utility companies
before digging by anyone

Call Dig-State: 811

IMPORTANT - DO NOT SCALE

This drawing provides approximate locations only and all facility information
has not been verified. EVERSOURCE MA GAS is not responsible for any liability resulting from
information identified. EVERSOURCE MA GAS disclaims any liability resulting from
the reliance by any person on the location shown on this map. Massachusetts
law requires that any person performing excavation work contact Dig-State so
that the location of any underground may be marked.

Address: 519 North Front St

City/Town: New Bedford

Date Plotted: 04/28/2022