

APPLICATION/AGREEMENT  
For Trench/Disturbance Permit within the City of New Bedford

Permit # 104-2002  
Dig Safe# 20221606741  
Date: 04/19/2022

TO THE MAYOR AND CITY COUNCIL: DISTURBANCE PERMIT/TRENCH SAFETY PERMIT

Permission is hereby requested to excavate the surface of: X City Property and/or X Private Property  
Provide Sketch

Location of Work: Lot 357 Appleton St  
Between Pine Grove St & Metcalf St. Working in the street and street to house. Left of #143  
Install gas service.

Work will begin (weather permitting) on: May 3, 2022

Applicant Name: Kevin O'Sullivan (gk) Excavator(s) Name: \_\_\_\_\_

Company Name: Eversource Hoisting Equipment License Number: \_\_\_\_\_  
Grade: \_\_\_\_\_ Expiration Date: \_\_\_\_\_

Contact Number: 508-441-5817 Name & Contact Number of Insurer: \_\_\_\_\_

Competent Person on Work Site: ON FILE

APPROVED BY: Stephen Caputo DATE: 5-10-2022  
TITLE: Asst. City Engineer

**This permit shall be posted at the work site, and shall remain until the work is completed. It is subject to inspection at all times.**

ROADWAY CLOSURES WILL REQUIRE  
AUTHORIZATION FROM THE  
COMMISSIONER OF PUBLIC  
INFRASTRUCTURE. TRAFFIC MANAGEMENT  
PLANS MAY BE REQUIRED.

Permit only valid for three months  
from date of approval

Trenches must be maintained  
weekly until final paving is  
completed

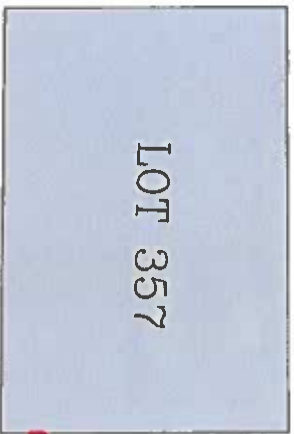

LOT 357

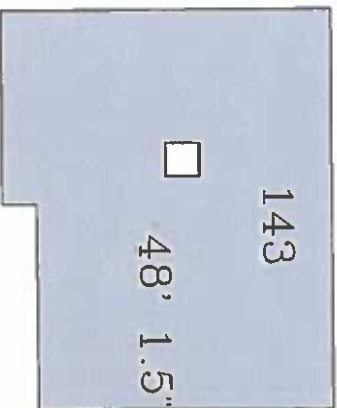

143

48' 1.5" ST 14

PROPOSED WORK AREA

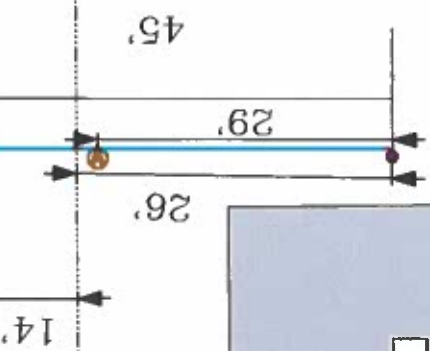

148' 4" CS LP

APPLETON ST

(E)

27/10 32'

IMPORTANT - DO NOT SCALE

This drawing provides approximate locations only and all facility information may not be shown. EVERSOURCE MA GAS to advise of any facility resulting from the reliance by any person on the location shown on this map. Massachusetts law requires that any person performing excavation work contact Dig-Date so that the location of any underground may be marked.

Address: Lot 367 Appleton St

City/Town: New Bedford

EVERSOURCE

EVERSOURCE MA GAS  
City/Town: New Bedford  
Phone 1-800-582-2000



MASS LAW

Regulation 7B: Before excavation  
beginning to dig, the excavator  
must call Dig-Date to advise of  
any facility resulting from the  
reliance by any person on the  
location shown on this map.