



PERMIT NO.  
24942

CITY OF NEW BEDFORD  
SEWER AND/OR STORM DRAIN PERMIT

DATE 06.10.2021  
Expire date: 06.10.2022

This certifies that permission is granted to

Andre Andrade 1267 Main St Huxmet, MA. 774.488.2002  
Property Owner Tel. 101 # 13

Address

To connect a sewer and/or storm drain located at 1267 Farland Circle x Phillips Rd  
Assessor's Plot BOD Lot. 4108, to the sewer and/or storm drain in EXISTING Manhole

ON 8" main ON Farland Circle

To be laid in accordance with the conditions in this application and the City of New Bedford ordinances.

TYPE OF USE: RESIDENTIAL

COMMERCIAL

INDUSTRIAL

FLOW G.P.D.

If applicant other than actual property owner, attach Letter of Authorization from Property Owner.

Name

Tel.

Mailing Address

The Bonded Contractor/Drain Layer authorized to perform this work is:

RJ. Canessa

Name

Tel.

Type of Pipe Required: 16" Address 5DR

PERMIT EXPIRES ONE YEAR AFTER DATE OF ISSUE

- Requires separate connections for sewage and storm drain where applicable. Storm water cannot be discharged to a sanitary sewer.
- All work must be inspected and approved by a D.P.I. inspector before backfilling.
- If this connection is to be part of a private service shared jointly with other building owners, attach copy of Recorded Joint Maintenance Agreement.
- Permits can be issued to Industrial and/or Commercial Applicants only upon receipt and approval by the Commissioner of Public Infrastructure of required plans and supplemental information.
- In addition, a City-issued Industrial User Discharge Permit and/or a Sewer Extension/Connection Permit issued by the Commonwealth of Massachusetts D.E.P. shall be required by the City for Industrial Discharge into the sewer system.

Industrial User Discharge Permit No.

Date

Comm. Mass. Sewer Conn./Ext. Permit No. Date  
A Filing and Inspection Fee of \$1,150 plus an Entrance Fee of \$1,000 where applicable, must accompany this application.

Bank# Citibank Check# 168 Date 06.08.2021 Receipt# 3313411

Other requirements: Proposed sewer clean out 2' off PL

Connection made to

Sewer

Part of jointly-shared private line

YES

Storm Drain

NO

Applicant agrees to abide by the above terms, as well as all pertinent ordinances of the City of New Bedford, and such other special rules as the Commissioner of Public Infrastructure and/or City Engineer may deem necessary

Signature of Property Owner or Representative  
Asst. City Engineer

Signature of Property Owner or Representative  
See attached for signature

INSPECTOR'S REPORT

INSPECTED BY:

DATE:

COMMENTS:

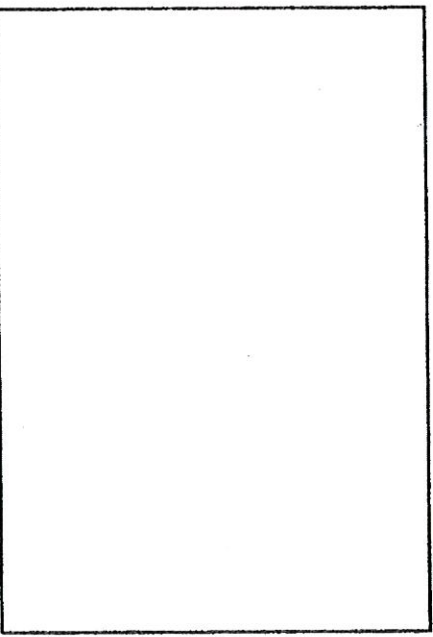

APPROVED

DISAPPROVED

SKETCH PLAN

SIGNATURE





# COPY

PERMIT NO.  
24942

CITY OF NEW BEDFORD  
SEWER AND/OR STORM DRAIN PERMIT

DATE \_\_\_\_\_  
Expire date: \_\_\_\_\_

This certifies that permission is granted to  
Andra Andrade 1867 Main St. Hushnet, MA 01904  
Property Owner Address Tel. 774.488.3000  
lot # 13

To connect a sewer and/or storm drain located at 145 Farland Circle x Phillips Rd. to existing Manhole  
Assessor's Plot BOD Lot 418, to the sewer and/or storm drain in ON 8" main ON Farland Circle

To be laid in accordance with the conditions in this application and the City of New Bedford ordinances.  
TYPE OF USE: RESIDENTIAL COMMERCIAL INDUSTRIAL FLOW \_\_\_\_\_ G.P.D.

If applicant other than actual property owner, attach Letter of Authorization from Property Owner.

Name \_\_\_\_\_ Tel. \_\_\_\_\_  
Mailing Address \_\_\_\_\_  
The Bonded Contractor/Drain Layer authorized to perform this work is: R.J. Canessa  
Name \_\_\_\_\_ Address \_\_\_\_\_ Tel. \_\_\_\_\_  
Type of Pipe Required: 16" SDR

PERMIT EXPIRES ONE YEAR AFTER DATE OF ISSUE

- Requires separate connections for sewage and storm drain where applicable. Storm water cannot be discharged to a sanitary sewer.
  - All work must be inspected and approved by a D.P.I. inspector before backfilling.
  - If this connection is to be part of a private service shared jointly with other building owners, attach copy of Recorded Joint Maintenance Agreement.
  - Permits can be issued to Industrial and/or Commercial Applicants only upon receipt and approval by the Commissioner of Public Infrastructure of required plans and supplemental information.
  - In addition, a City-issued Industrial User Discharge Permit and/or a Sewer Extension/Connection Permit issued by the Commonwealth of Massachusetts D.E.P. shall be required by the City for Industrial Discharge into the sewer system.
- Industrial User Discharge Permit No. \_\_\_\_\_ Date \_\_\_\_\_

Comm. Mass. Sewer Conn./Ext. Permit No. \_\_\_\_\_ Date \_\_\_\_\_  
A Filing and Inspection Fee of \$1,150 plus an Entrance Fee of \$1,150 where applicable, must accompany this application.

Bank# \_\_\_\_\_ Check# \_\_\_\_\_ Date \_\_\_\_\_ Receipt# \_\_\_\_\_

Other requirements: Proposed sewer clean out 2' off PL

Connection made to ☒ Sewer ☐ Storm Drain Part of jointly-shared private line YES ☐ NO ☒

Applicant agrees to abide by the above terms, as well as all pertinent ordinances of the City of New Bedford, and such other special rules as the Commissioner of Public Infrastructure and/or City Engineer may deem necessary

Asst. City Engineer \_\_\_\_\_  
Signature of Property Owner or Representative \*Andra Andrade

INSPECTOR'S REPORT

INSPECTED BY: \_\_\_\_\_

DATE: \_\_\_\_\_

COMMENTS: \_\_\_\_\_

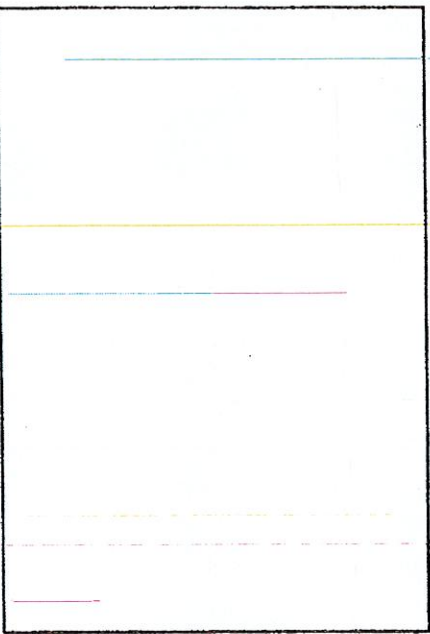

APPROVED \_\_\_\_\_ DISAPPROVED \_\_\_\_\_

SKETCH PLAN

SIGNATURE

ANDREA E ANDRADE  
ANDRE RICARDO ANDRADE  
1267 N MAIN ST.  
ACUSHNET, MA 02743

DATE 6-3-2021

PAY TO THE ORDER OF City of New Bedford  
\$ 450.00  
Four hundred Fifty Dollars no cents

City of New Bedford  
Wealth Management #24942#  
Permit Sealer  
PREMIER ADVISORY  
NP

1:211070175: 1320406510 0168

MISCELLANEOUS PAYMENT RECPT#: 3373411  
City of New Bedford  
133 William St.  
New Bedford MA 02740

DATE: 06/08/21 TIME: 09:19  
CLERK: a450mb DEPT:  
CUSTOMER#: 0

COMMENT:

CHG: DPISEW DPI SEWER PERMI 450.00

REVENUE:  
1 63906000 422185 450.00  
Sewer Permit Fee

CASH:  
TW05 101009 450.00  
Cash Treasurer Dep W

AMOUNT PAID: 450.00

PAID BY: ANDRE ANDRADE  
PAYMENT METH: CHECK  
REFERENCE: MR168

AMT TENDERED: 450.00  
AMT APPLIED: 450.00  
CHANGE: .00



Commonwealth of Massachusetts



# CITY OF NEW BEDFORD

City Hall, Room 308, 133 William Street New Bedford, MA 02740 (508) 979-1540



# FOUNDATION PERMIT

2/8/2021

No. **B-20-3550**

MSBC Sect. 111.8 - Any permit issued shall be deemed abandoned and invalid unless the work authorized by it shall have been commenced within six (6) months after its issuance.

FEE PAID \$100.00

This certifies that **Lionel P. Barbosa**

owner/contractor has permission to:

WS- **FARLAND CRC**

on:

130D  
-468

**Foundations Only 1-2 Family - 100.00**

Providing that the person accepting this permit shall in every respect conform to the terms of application therefore on file in this office; to the provisions of the statute of the Commonwealth and to the by-laws of the City of New Bedford relating to the inspection, erection, enlarging, altering, raising, moving, repairing, or tearing down of a building.

Permit is issued subject to the following special requirements: (Restrictions)



Wiring Inspector



Plumbing Inspector



Building Inspector

\_\_\_\_\_  
\_\_\_\_\_  
\_\_\_\_\_

\_\_\_\_\_  
\_\_\_\_\_  
\_\_\_\_\_

\_\_\_\_\_  
\_\_\_\_\_  
\_\_\_\_\_

YOUR AREA INSPECTOR IS: **Thomas Welch**

Tel. (508) 979-1540 Between 8:00am - 9:00am

**NOTICE: NOTIFY INSPECTOR 48 HOURS IN  
ADVANCE OF APPLYING SHEATHING OR LATHING**

**OCCUPANCY PERMIT REQUIRED BEFORE OCCUPANCY**  
No Building or Structure shall be used or occupied until the Certificate of Use and Occupancy shall have been issued by the Building Commissioner - MSBC, Sect. 120.1

This Card Must Be Displayed in a Conspicuous Place on the Premises and Not Torn Down or Removed Until Completion of Work

SUBJECT TO MASSACHUSETTS  
STATE BUILDING CODE

*Dan P. Brown*





MAP 130D LOT 147,  
247, 248, & 447  
N/F

CUMBERLAND FARMS, INC.

N13°03'07"W  
126.39'

ASSESSORS  
MAP 130D LOT 468  
(AREA=18,187± S.F.)

183.36'  
N84°53'42"E

MAP 130D  
LOT 467  
N/F  
MARIA & VICTOR  
VIDAL

MAP 130D  
LOT 469  
N/F  
SALLY TRIP &  
SANDRA ALMEIDA

EXISTING FOUNDATION  
1.0 F. = 101.75

R=75.00'  
L=43.90'

33.70'  
S05°06'18"E

— ZONING DATA —	
DISTRICT:	RA — RESIDENTIAL A
DESCRIPTION	REQUIRED
FRONT SETBACK	20 FT
SIDE SETBACK	10/12 FT
REAR SETBACK	30 FT

FARLAND ~50' WIDTH~ CIRCLE



**FLOOD NOTE:**

AS-BUILT SURVEY PERFORMED BY FARLAND CORP IN MAY OF 2021.

COPYRIGHT © 2021 FARLAND CORP. ALL RIGHTS RESERVED.  
NO PART OF THIS DOCUMENT MAY BE REPRODUCED, STORED IN A RETRIEVAL SYSTEM, OR TRANSMITTED IN ANY FORM, OR BY ANY MEANS, ELECTRONIC, MECHANICAL, PHOTOCOPYING, RECORDING OR OTHERWISE, WITHOUT THE EXPRESS WRITTEN CONSENT OF FARLAND CORP.  
ANY MODIFICATIONS MADE TO THIS DOCUMENT WITHOUT THE WRITTEN PERMISSION OF FARLAND CORP. SHALL RENDER IT INVALID AND UNUSABLE.

FOUNDATION AS-BUILT PLAN

— BUILDERS LOT 13 - FARLAND CIRCLE —  
ASSESSORS MAP 130D LOT 468  
NEW BEDFORD, MASSACHUSETTS

www.FarlandCorp.com

21 VENTURA DRIVE  
DARTMOUTH, MA 02747  
P.508.717.3479

- ENGINEERING
- SITEWORK
- LAND SURVEYING
- DEVELOPMENT

PREPARED FOR:  
VICTOR VIDAL  
1267 MAIN STREET  
ACUSHNET, MA  
02743

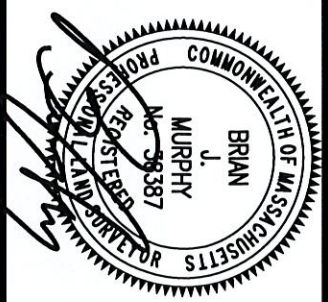

SCALE: 1"=20'

MAY 12, 2021

DRAWN BY: JT

JOB NO: 20-705

