



PERMIT NO.

24961 ~~24960~~ - 21-47

This certifies that permission is granted to

CITY OF NEW BEDFORD
SEWER AND/OR STORM DRAIN PERMIT

DATE 1-8-2021

Expire date: 7-8-2022

Property Owner Lopez Development Address 129 Huxton Ave Tel. 508.441.8606
Foxcross Rd 02719

To connect a sewer and/or storm drain located at Foxcross Ciele (MS) S x Phillips Rd
Assessor's Plot 1307 Lot 460 to the sewer and/or storm drain in existing 8" main SDR 35 Street
Buildex Lot #15

To be laid in accordance with the conditions in this application and the City of New Bedford ordinances.

TYPE OF USE RESIDENTIAL COMMERCIAL INDUSTRIAL FLOW G.P.D.

If applicant other than actual property owner, attach Letter of Authorization from Property Owner.

Name Regan Kelly Tel. 508-889-0550

Mailing Address 4. Dobson St Wareham

The Bonded Contractor/Drain Layer authorized to perform this work is:

Name _____ Address _____ Tel. _____
Type of Pipe Required: 6" SDR 35 Sewer

PERMIT EXPIRES ONE YEAR AFTER DATE OF ISSUE

- Requires separate connections for sewage and storm drain where applicable. Storm water cannot be discharged to a sanitary sewer.
 - All work must be inspected and approved by a D.P.I. inspector before backfilling.
 - If this connection is to be part of a private service shared jointly with other building owners, attach copy of Recorded Joint Maintenance Agreement.
 - Permits can be issued to Industrial and/or Commercial Applicants only upon receipt and approval by the Commissioner of Public Infrastructure of required plans and supplemental information.
 - In addition, a City-issued Industrial User Discharge Permit and/or a Sewer Extension/Connection Permit issued by the Commonwealth of Massachusetts D.E.P. shall be required by the City for Industrial Discharge into the sewer system.
- Industrial User Discharge Permit No. _____ Date _____

Comm. Mass. Sewer Conn./Ext. Permit No. _____ Date _____
A Filing and Inspection Fee of \$ 450., plus an Entrance Fee of \$ _____ where applicable, must accompany this application.

Bank# Bank Five Check# 1551 Date 7-8-2021 Receipt# 3412153

Other requirements: _____

Connection made to Sewer Part of jointly-shared private line YES NO
Storm Drain

Applicant agrees to abide by the above terms, as well as all pertinent ordinances of the City of New Bedford, and such other special rules as the Commissioner of Public Infrastructure and/or City Engineer may deem necessary

Satish Gupta Gupta
Asst. City Engineer Signature of Property Owner or Representative

INSPECTOR'S REPORT

INSPECTED BY: _____

DATE: _____

COMMENTS: _____

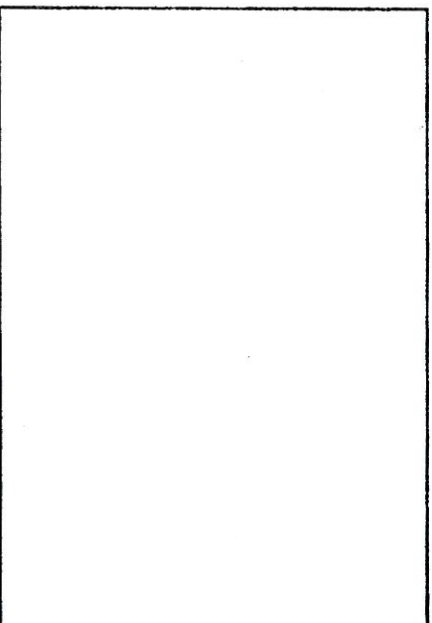

APPROVED _____ DISAPPROVED _____

SKETCH PLAN

SIGNATURE

MISCELLANEOUS PAYMENT RECPT#: 3412153
City of New Bedford
133 William St.
New Bedford MA 02740

DATE: 07/08/21 TIME: 14:34
CLERK: a450mmh DEPT:
CUSTOMER#: 0

COMMENT:

CHG: DPISEW DPI SEWER PERMI 450.00

REVENUE:
1 63906000 422185 450.00
Sewer Permit Fee
CASH:
TW05 101009 450.00
Cash Treasurer Dep W

AMOUNT PAID: 450.00

PAID BY: LOPEZ DEVELOPMENT LL
PAYMENT METH: CHECK
MR1551

REFERENCE:

AMT TENDERED: 450.00
AMT APPLIED: 450.00
CHANGE: .00



- ZONING DATA -		
DISTRICT: SINGLE RESIDENCE D		
DESCRIPTION	REQUIRED	
FRONT SETBACK	20 FT	
SIDE SETBACK	10/12 FT	
REAR SETBACK	30 FT	

MAP 130D
LOT 447

N13°03'07"W
75.73'

ASSESSORS
MAP 103D LOT 466
(AREA=14,930± S.F.)

MAP 130D
LOT 467
S84°53'47"W
193.84'

MAP 130D
LOT 465
N84°53'42"E
204.30'

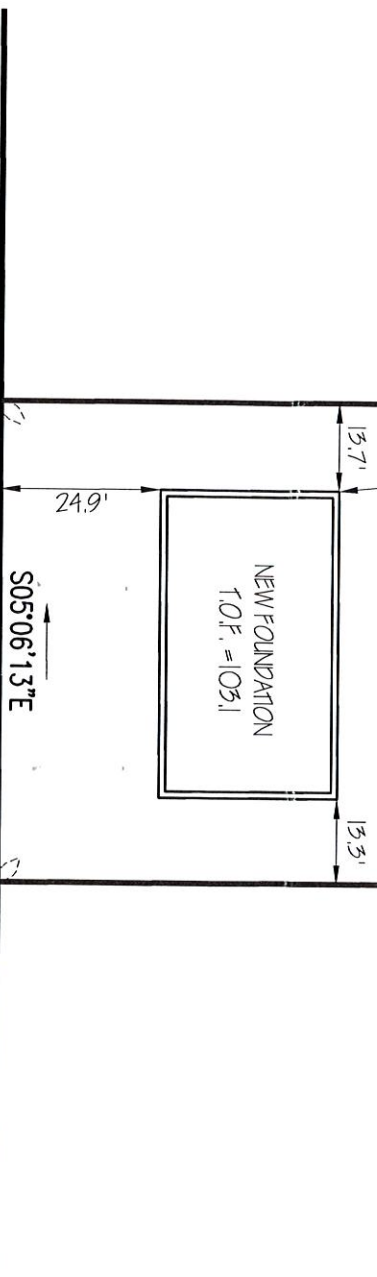

FARLAND ~50' WIDE~ CIRCLE

NOTE:
AS-BUILT SURVEY PERFORMED BY FARLAND CORP IN JUNE 2021
COPYRIGHT © 2020 FARLAND CORP. ALL RIGHTS RESERVED
NO PART OF THIS DOCUMENT MAY BE REPRODUCED, STORED IN A RETRIEVAL SYSTEM, OR TRANSMITTED IN ANY FORM OR BY ANY MEANS, ELECTRONIC, MECHANICAL, PHOTOCOPYING, RECORDING OR OTHERWISE, WITHOUT THE EXPRESS WRITTEN CONSENT OF FARLAND CORP.
ANY MODIFICATIONS MADE TO THIS DOCUMENT WITHOUT THE WRITTEN PERMISSION OF FARLAND CORP. SHALL RENDER IT INVALID AND UNUSABLE.



FOUNDATION AS-BUILT
LOT 15 FARLAND CIRCLE
ASSESSORS MAPD130D LOT 465
NEW BEDFORD, MASSACHUSETTS

4660



www.FarlandCorp.com
21 VENTURA DRIVE
DARTMOUTH, MA 02747
P.508.717.3479
• ENGINEERING
• SITEWORK
• LAND SURVEYING
• DEVELOPMENT

PREPARED FOR:
TD DESIGN AND DEVELOPMENT CORP.
403 ROCKDALE AVENUE
NEW BEDFORD, MA 02740

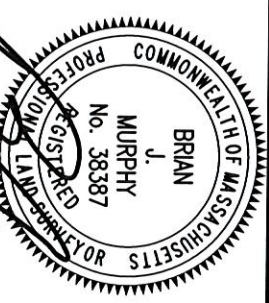

SCALE: 1"=30'
JUNE 24, 2021
DRAWN BY: AJT
JOB NO: 19-744