



CITY OF NEW BEDFORD
MASSACHUSETTS
ENGINEERING- 508-979-1550

CONSTRUCTION OF
PAVED
SIDEWALK/ DRIVEWAY

Expires: 8-9-2003

Application No. 11730

Date: 8-9-2001

Property Owner: Thomas Mello

Tel: 508-932-3289

Address: 81 Susan St City New Bedford State MA zip code _____

The above hereby request permission to construct a paved: 10 driveway / 204 sidewalk located at 81 Susan Street plot ✓, lot ✓ in accordance with the terms and conditions set forth herein, and the Ordinances of the City of New Bedford.

Sidewalk	Dimensions	Driveway	Width (ft)
<input type="checkbox"/> Residential	<input type="checkbox"/>	<input checked="" type="checkbox"/> Residential	<u>18' x 13'</u> hot mix asphalt
<input type="checkbox"/> Commercial	<input type="checkbox"/>	<input type="checkbox"/> Commercial	<input type="checkbox"/>
<input type="checkbox"/> Bituminous Concrete	<input type="checkbox"/>	<input type="checkbox"/> Relocation / Widening	<input type="checkbox"/>
<input type="checkbox"/> Concrete Full Width	<input type="checkbox"/>	<input type="checkbox"/> Curb Removal	<input type="checkbox"/>
<input type="checkbox"/> Concrete w/ Grass Ribbon	<input type="checkbox"/>	<input type="checkbox"/> Concrete	<input type="checkbox"/>
<input type="checkbox"/> Curb needed	<input type="checkbox"/>	<input checked="" type="checkbox"/> Bituminous Concrete	<u>18' x 13'</u> hot mix asphalt

Comments: Please follow the most current revision of DPE Specs

Bonded Contractor: Farland Corp Tel: _____

Traffic Commission: _____ Approved ☐ Rejected ☐ Date _____

Signature _____

Building Dept.

☒ Approved (New Building)
☐ Approved - Bldg Permit # B-21-2174
☐ Rejected

Signature Danny Novack 8-9-2001

Engineering Dept.

☒ Approved ☐ Rejected 8-3-2001 Date

Signature Dennis J. Gagnier

Permit / Inspection fee of \$150.00 must accompany this application.

Special Requirements:

Contractor to call 24 hrs. in advance for pre-inspection (prior to pouring). If curbing is removed, it must be returned in whole pieces within 24 hrs. to the D.P.I. City Yard on Liberty St. (btwn Parker St. & Durfee St.) accompanied with original curbing receipt.

PAID: \$150 Check # 91518

Supervising Civil Engineer: Stephen Crockett

Print name: (property owner/representative)
Rachel Parak

By: Chavel 10/05

Signature: (property owner/representative)
R. Parak

1105 Shawmut Avenue, New Bedford, MA 02746 Telephone 508-979-1550 Fax 1-508-961-3054

Driveway Review Form

Submitted By: nb.dennis.souza

Submitted Time: 08/02/2021 2:57 PM

WO #: 21-016002

Date & Time: August 2, 2021 2:55 PM

DPI Inspector: DS

Bldg. Inspector: Carl Bizarro

Contractor: Farland

Granite Curb: N/A

Address: 81 Swan St

Owner: Thomas & Wendy Mello

Permit #: TB-21-2174

Property

Plot #: 10 **Lot #:** 264

Permit Notes (Prop. Work): Driveway.

City Layout: 13-ft

Additional Inspection Notes: 1. Remove existing ~~18~~¹⁸-ft x 13-ft hot mix asphalt driveway apron. 2. Install new ~~18~~¹⁸-ft x 13-ft x 4-inch hot mix asphalt driveway apron in accordance with the most current revision of DPI Specs.

DS 8/3/21

APPROVED

D.S.

8/3/2021

81 Swan St

Driveway Review

Address: 81 Swan St
Permit: TB-21-2174

DPI Inspector: [Signature]
City Layout: 13-ft

Sketch

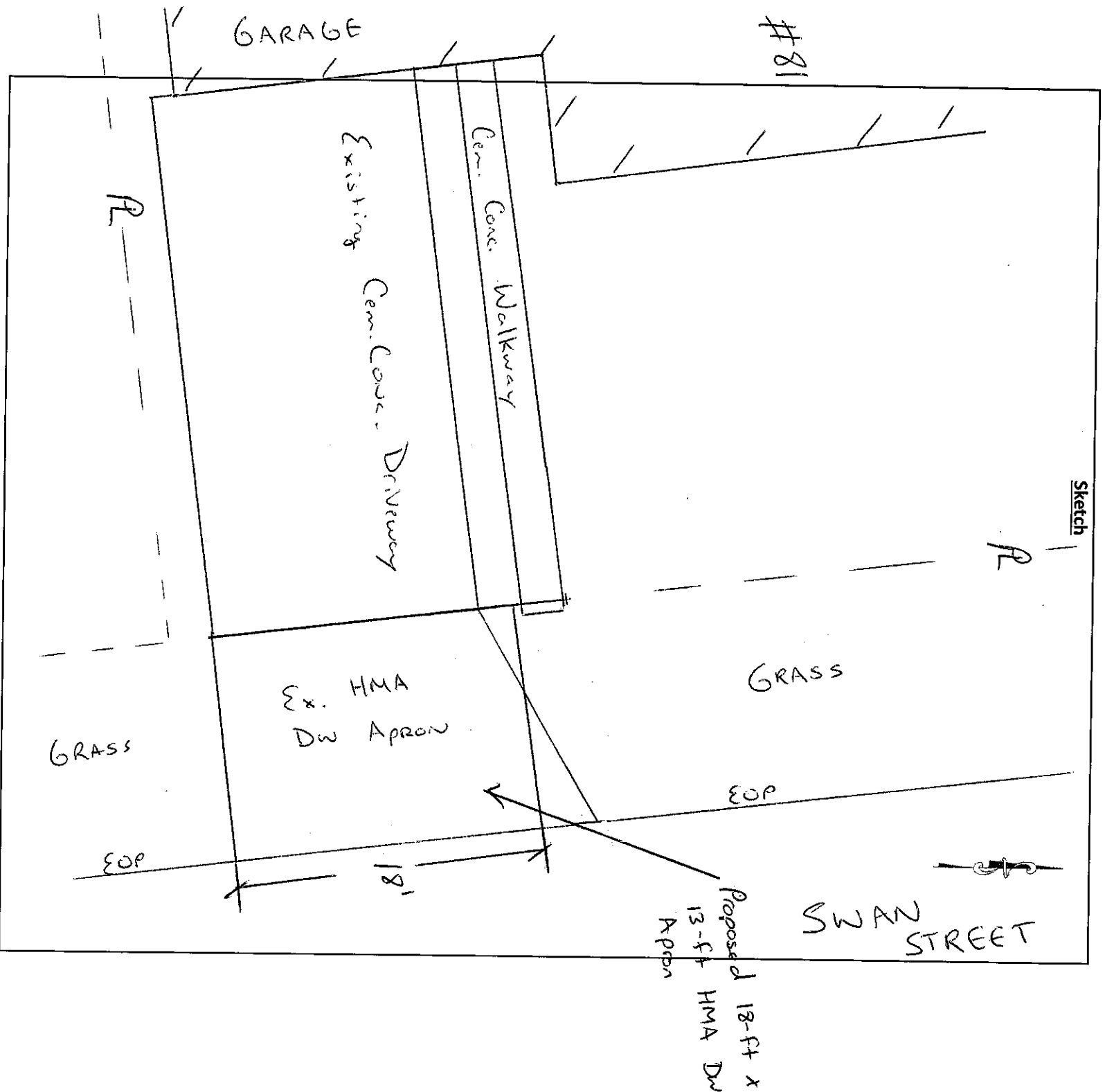



C

RD

B

DING PER

8/6/2021

No. B-21-2174

MSBC Sec
have been

ued shall be deemed abandoned and invalid u
months after its issuance.

d by it shall

FEE PAID: \$30.00

This certifies that FARLAND CORPO
owner/contractor has permission to

Contractor

ParcelID 10-264

on: 81 SWAN ST

0.00

Providing that the person accepting this per
of the statute of the Comonwealth adn to the
reparing, or tearing down of a building.

therefore on file in this office; to the provisions
section, enlarging, altering, raising, moving,

Permit is issued

ving special requirements: (Restricti

CITY DEPARTMENT/COMMISSION COMMENT

BUILDING DEPAR

S

The following department/commission has expr
permit. You are advised to contact that agency

ut the issuance of this
atter.

: Resurface existing to approved plan

Department.Commission: _____

YOUR AREA INSPE

(8) 979-1540 Between 8:00am - 9:00am

NOTICE: NOTIFY INSPECTOR 48
ADVANCE OF APPLYING SHEATHING OR LATHING

SUBJECT TO MASSACHUSETTS
STATE BUILDING CODE

Danny D. Roman

Building Commissioner

Plan Review Comments: : 1. Remove existing 13-ft x 13-ft hot mix asphalt driveway apron.
2. Install new 13-ft x 13-ft x 4-inch hot mix asphalt driveway apron in accordance with the most current revision of the City of New Bedford DPI Construction Standards and Specifications.

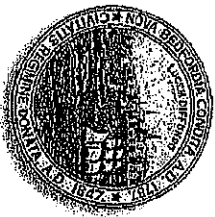

Department of Public Infrastructure

Enzebio Arruda
Commissioner

CITY OF NEW BEDFORD
Jonathan F. Mitchell, Mayor

Water
Wastewater
Highways
Engineering
Cemeteries
Park Maintenance
Forestry
Energy

To Whom It May Concern:

1 THOMAS E. MELL 81 SUMMIT ST. NEW BEDFORD MA, being
(Name) (Mailing Address)

81 SUMMIT ST. NEW BEDFORD MA 02744
Owner of property located at

Plot _____, Lot _____, hereby agree to allow FARHAD DWP
(Name)

21 VENTURA DRIVE, BEDFORD MA, to act on my behalf including affixing my
(Mailing Address) Me

signature in securing permit for:

☐ Sewer/Drain Service Permits
☐ Water Service Permits
☒ Driveway Installation Permits
☐ Sidewalk Installation Permits

I further agree to conform to, and abide by, All City rules and ask regulations applicable to the permit (s) being applied for:

[Signature]
Name
81 SUMMIT ST.
Address
7-18-21
Date
508 932-2289
Telephone Number