



CITY OF NEW BEDFORD
MASSACHUSETTS
ENGINEERING- 508-979-1550

APPLICATION FOR
CONSTRUCTION OF
PAVED
SIDEWALK/ DRIVEWAY

Expires: 4-27-2002

Application No. 11685

Date: 4-27-2001

Property Owner: Rui Baptista Tel: _____

Address: 168 Poncet St NB City MA State 02745 zip code

The above hereby request permission to construct a paved: ☒ driveway / ☒ sidewalk located at 168 Poncet St, plot 110, lot 447 in accordance with the terms and conditions set forth herein, and the Ordinances of the City of New Bedford.

Dimensions		Driveway		Width (ft)	
<input type="checkbox"/> Residential	_____	<input checked="" type="checkbox"/> Residential	_____	<u>10.5</u>	_____
<input type="checkbox"/> Commercial	_____	<input type="checkbox"/> Commercial	_____	_____	_____
<input type="checkbox"/> Bituminous Concrete	_____	<input type="checkbox"/> Relocation / Widening	_____	_____	_____
<input type="checkbox"/> Concrete Full Width	_____	<input checked="" type="checkbox"/> Curb Removal	_____	<u>10.5</u>	<u>granite</u>
<input type="checkbox"/> Concrete w/ Grass Ribbon	_____	<input type="checkbox"/> Concrete	_____	_____	_____
<input type="checkbox"/> Curb needed	_____	<input type="checkbox"/> Bituminous Concrete	_____	_____	_____

Comments: Remove? Return 10.5 gran curb. Remove 10.5 x 10' curbs w/ 5' grass ribbons in accordance with must curbed 10' grass spec.

Bonded Contractor: Margado INC Tel: 508-34510357

Traffic Commission: _____ Approved _____ Rejected _____ Date _____

Signature _____

Building Dept.

☒ Approved (New Building)
☒ Approved - Bldg. Permit # B-90-2532
☐ Rejected

Danny Ramonovicz
Signature

Engineering Dept.

☒ Approved _____ Rejected 9/11/2000 Date
Dennis Dunge
Signature AB

Permit / Inspection fee of \$150.00 must accompany this application.

Special Requirements:

Contractor to call 24 hrs. in advance for pre-inspection (prior to pouring). If curbing is removed, it must be returned in whole pieces within 24 hrs. to the D.P.I. City Yard on Liberty St. (btwn Parker St. & Durfee St.) accompanied with original curbing receipt.

\$ 00
PAID: 150 Check # 29602

See attached for all signatures

Supervising Civil Engineer

☒ Print name: (property owner/representative)

By: _____ Signature: (property owner/representative)

1105 Shawmut Avenue, New Bedford, MA 02746 Telephone 508-979-1550 Fax 1-508-961-3054



CITY OF NEW BEDFORD
MASSACHUSETTS
ENGINEERING- 508-979-1550

CONSTRUCTION OF
PAVED
SIDEWALK/ DRIVEWAY

Expires: 4-27-2002

Application No. 11685

Date: 4-27-2001

Property Owner: Rui Baptista

Tel: _____

Address: 108 PINE ST NB. 112 02745
Street City State zip code

The above hereby request permission to construct a paved: ☒ driveway / ☒ sidewalk
located at 108 PINE ST, plot 112, lot 434 in accordance
with the terms and conditions set forth herein, and the Ordinances of the City of New Bedford.

Sidewalk	Dimensions	Driveway	Width (ft)
<input type="checkbox"/> Residential	<input checked="" type="checkbox"/> Residential	<input type="checkbox"/> Residential	<u>10.5</u>
<input type="checkbox"/> Commercial	<input type="checkbox"/> Commercial	<input type="checkbox"/> Commercial	<input type="checkbox"/>
<input type="checkbox"/> Bituminous Concrete	<input type="checkbox"/> Relocation / Widening	<input checked="" type="checkbox"/> Curb Removal	<u>10.5</u> granite
<input type="checkbox"/> Concrete Full Width	<input type="checkbox"/> Concrete	<input type="checkbox"/> Bituminous Concrete	<input type="checkbox"/>
<input type="checkbox"/> Concrete w/ Grass Ribbon	<input type="checkbox"/>	<input type="checkbox"/>	<input type="checkbox"/>
<input type="checkbox"/> Curb needed	<input type="checkbox"/>	<input type="checkbox"/>	<input type="checkbox"/>

Comments: Remove? Return 10.5 gran curb Remove 10.5
10' cur curb 10.5 grass ribbons in accordance with
MUST CURB PROGRADE INC Tel: 508-34510357

Bonded Contractor: _____
Traffic Commission: _____ Approved _____ Rejected _____ Date _____

Signature _____

Building Dept.

☒ Approved (New Building)
☒ Approved - Bldg Permit # 13-20-2532
Rejected

Danny Ramonovicz
Signature

Engineering Dept.

☒ Approved _____ Rejected 9/11/2000 Date

Dennis Souza
Signature

Permit / Inspection fee of \$150.00 must accompany this application.

Special Requirements:

Contractor to call 24 hrs. in advance for pre-inspection (prior to pouring). If curbing is removed, it must be returned in whole pieces within 24 hrs. to the D.P.I. City Yard on Liberty St. (btwn Parker St. & Durfee St.) accompanied with original curbing receipt.

\$ 150.00
PAID: 150 Check # 2962

Stephanie Langsten
Supervising Civil Engineer

Sarah Mercado
Print name: (property owner/representative)

By: Dennis Souza

Dennis Souza
Signature: (property owner/representative)

1105 Shawmut Avenue, New Bedford, MA 02746 Telephone 508-979-1550 Fax 1-508-961-3054

MORGADO COMPANY INC.

5-7515/110

2962

DATE

April 26, 2021

PAY TO THE
ORDER OF

City of New Bedford \$ 150.00
one hundred & fifty — 00/100 DOLLARS

Santander

Santander Bank N.A.

MEMO

168 Princeton St.

Sarah Cor

⑆0⑆1⑆075⑆50⑆ ⑆3300⑆38057⑆ 2962

© Disney

Mickey and Pal

MISCELLANEOUS PAYMENT RECPT#: 3317106
City of New Bedford
133 William St.
New Bedford MA 02740

DATE: 04/27/21 TIME: 14:18
CLERK: a450mb DEPT:
CUSTOMER#: 0

COMMENT:

CHG: DPIDRY DPI DRIVEWAY PE 150.00

REVENUE:
1 03406000 454010 150.00
DPI - Driveway-Sidewalk Permit

CASH:
TW05 101009 150.00
Cash Treasurer Dep W

AMOUNT PAID: 150.00

PAID BY: MORGADO
PAYMENT METH: CHECK
MR2962

REFERENCE:

AMT TENDERED: 150.00
AMT APPLIED: 150.00
CHANGE: .00

Driveway Review Form

Submitted By: nb.dennis.souza

Submitted Time: 09/10/2020 10:36 AM

WO #: 20-013671

Date & Time: 09/10/2020 10:34 AM

DPI Inspector: DS

Bldg. Inspector: Carl Bizarro

Contractor: Morgado

Granite Curb: Remove and return 10.5'

Address: 168 Princeton St

Owner: Rui & Laura Batista

Permit #: TB-20-2532

Property

Plot #: 110 Lot #: 424

Permit Notes (Prop. Work): Asphalt driveway and curb cut with concrete apron.

City Layout: 10-30-10

Additional Inspection Notes: 1.Remove&Return 10.5' gran.curb. 2.Remove 10.5'x10' cem.conc.SW & grass ribbons. 3.Install new 10.5'x10' cem.conc. DW apron in accordance with most current DPI Specs.

APPROVED

D.S.

9/11/2020

168 Princeton St

Driveway Review

Address: 168 Princeton St

DPI Inspector:

[Signature]

Permit: TB-20-2532

City Layout: 10-30-10

Sketch



Princeton St

Remove & Return 10.5'
GRAVITE CURB

Cem. CURB

GRASS

GRASS

10.5'

GRASS

GRASS

Cem. CURB

Cem. Conc. SW

GRASS

GRASS

GRASS R

Cem. Conc. SW

GRASS

Prop. 10.5' x 10'
Cem. Conc. DW
Apron

168

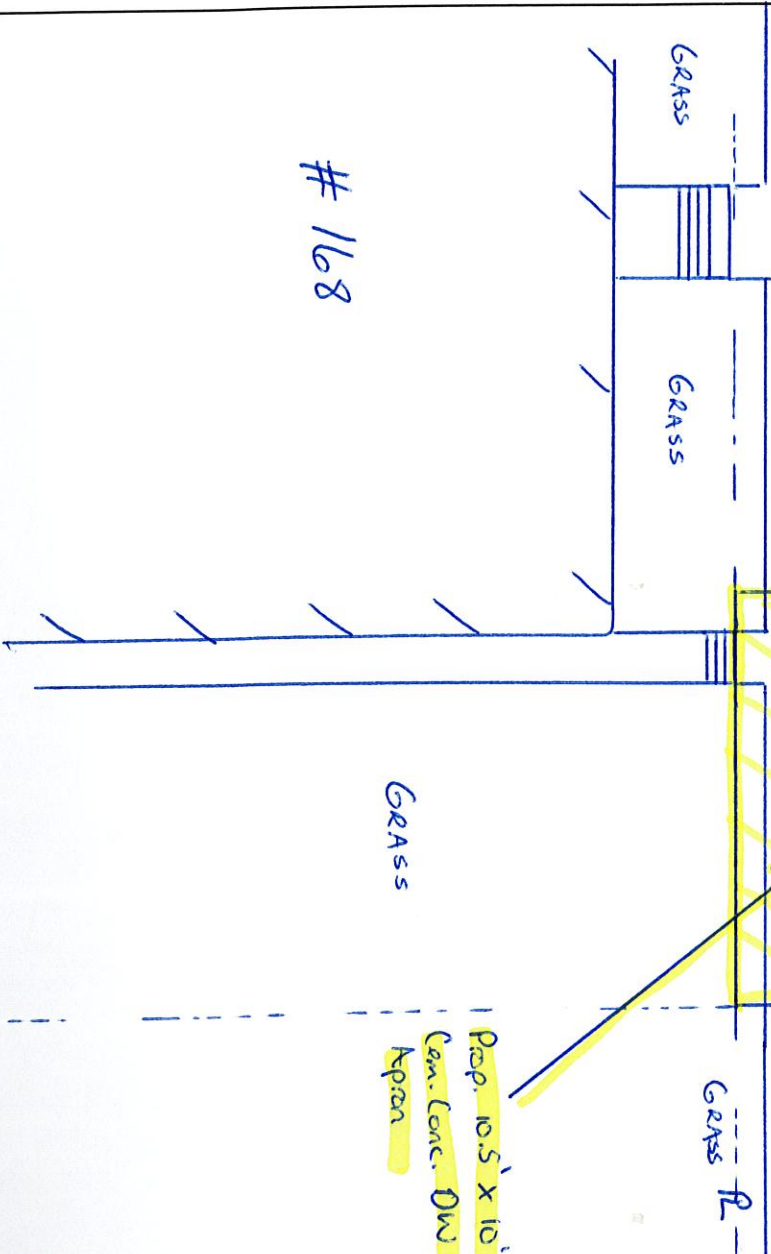



Department of Public Infrastructure

Jamie Ponte
Commissioner

Water
Wastewater
Highways
Engineering
Cemeteries
Park Maintenance
Forestry
Energy

CITY OF NEW BEDFORD

Jonathan F. Mitchell, Mayor

To Whom It May Concern:

I Rui Baptista 168 Princeton St., being
(Name) (Mailing Address)

Owner of property located at

168 Princeton St.

Plot 110, Lot 424, hereby agree to allow Morgado Company
(Name)

1 Anne's Path Lakeville to act on my behalf including affixing my
(Mailing Address)

signature in securing permit for:

☐ Sewer/Drain Service Permits
☐ Water Service Permits
☒ Driveway Installation Permits
☐ Sidewalk Installation Permits

I further agree to conform to, and abide by, All City rules and ask regulations applicable to the permit (s) being applied for:

Name Rui Baptista
Signature
Address 168 Princeton St. New Bedford
Date April 20, 2021 Telephone Number 508-345-6357



Commonwealth of Massachusetts

CITY OF NEW BEDFORD

City Hall, Room 308, 133 William Street New Bedford, MA 02740 (508) 979-1540



BUILDING PERMIT

4/9/2021

No. **B-20-2532**

MSBC Sect. 110.14 - Any permit issued shall be deemed abandoned and invalid unless the work authorized by it shall have been commenced within six (6) months after its issuance.

FEE PAID: **\$30.00**

This certifies that **Adrian Morgado**

Contractor Lic. # _____

ParcelID **110-424**

owner/contractor has permission to: **Driveways - 30.00**

on: **168 PRINCETON ST**

Providing that the person accepting this permit shall in every respect conform to the terms of application therefore on file in this office; to the provisions of the statute of the Commonwealth and to the by-laws of the City of New Bedford relating to the inspection, erection, enlarging, altering, raising, moving, repairing, or tearing down of a building.

Permit is issued subject to the following special requirements: (Restrictions)

CITY DEPARTMENT/COMMISSION COMMENTS

The following department/commission has expressed concern about the issuance of this permit. You are advised to contact that agency and resolve this matter.

Department.Commission: _____

BUILDING DEPARTMENT COMMENTS

: Asphalt driveway and curb cut with concrete apron and building a retaining wall as per plan and approval by the Zoning Board of Appeals #4433

: Engineering comments

1.Remove & return 10.5' of granite curb.

2.Remove 10.5' x 10' cement concrete sidewalk & grass ribbons.

3.Install new 10.5' x 10' cement concrete driveway apron in accordance with most current City of New Bedford DPI Construction Standards and Specifications.

YOUR AREA INSPECTOR IS: **Carl Bizarro**

Tel. (508) 979-1540 Between 8:00am - 9:00am

**NOTICE: NOTIFY INSPECTOR 48 HOURS IN
ADVANCE OF APPLYING SHEATHING OR LATHING**

OCCUPANCY PERMIT REQUIRED BEFORE OCCUPANCY

No Building or Structure shall be used or occupied until the Certificate of Use and Occupancy shall have been issued by the Building Commissioner - MSBC, Sect. 120.1

This Card Must Be Displayed in a Conspicuous Place on the Premises and Not Torn Down or Removed Until Completion of Work

SUBJECT TO MASSACHUSETTS
STATE BUILDING CODE

Danny D. Romanowicz

Building Commissioner