

APPLICATION/AGREEMENT

Permit # 44602021

For Trench/Disturbance Permit within the City of New Bedford

Dig Safe: 20213709399Date: 9/16/2021

TO THE MAYOR AND CITY COUNCIL:

DISTURBANCE PERMIT/TRENCH SAFETY PERMIT

Permission is hereby requested to excavate the surface of: ☒ City Property and/or ☐ Private Property
Provide SketchLocation of Work: 285 Clifford St. - class blackBrook St. - Church St.Gas Line MaintenanceWork will begin (weather permitting) on: September 30, 2021Applicant Name: Kevin O'Sullivan (ra)

Excavator(s) Name: _____

Company Name: Eversource

Hoisting Equipment License Number: _____

Grade: _____ Expiration Date: _____

Contact Number: 508-441-5817

Name & Contact Number of Insurer: _____

Competent Person on Work Site: ON FILEAPPROVED BY: Stephen Cupta DATE: 10-19-2021TITLE: Asst. City Engineer

This permit shall be posted at the work site, and shall remain until the work is completed. It is subject to inspection at all times.

Permit only valid for three months
from date of approvalTrenches must be maintained
weekly until final paving is
completedROADWAY CLOSURES WILL REQUIRE
AUTHORIZATION FROM THE
COMMISSIONER OF PUBLIC
INFRASTRUCTURE. TRAFFIC MANAGEMENT
PLANS MAY BE REQUIRED.

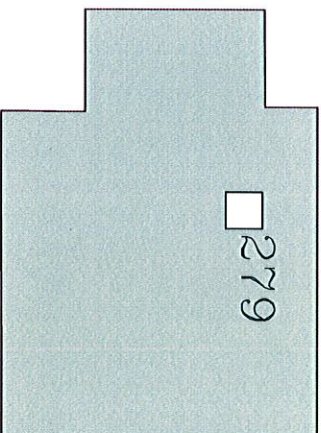
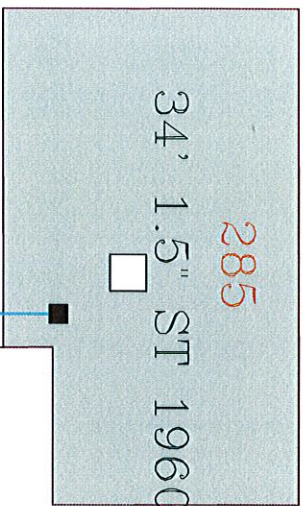
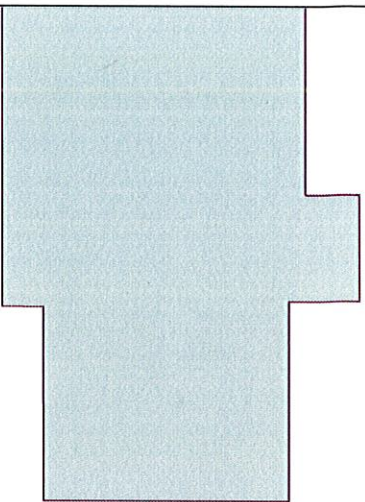

346' 4" CS LP 1960

14' 0.00" CI LP 1960

3'
34'

PROPOSED WORK AREA



EVERSOURCE

EVERSOURCE MA GAS
One NSTAR Way
Bedford, MA 02090
Phone 1-800-532-2000



MASS LAW
Requires 72 hour advance
notice to utility companies
before digging by anyone
Call Dig-Safe: 811

IMPORTANT - DO NOT SCALE
This drawing provided approximate locations only and all facility information
must be verified by the customer. EVERSOURCE MA GAS is not responsible for
information identified. EVERSOURCE MA GAS disclaims any liability resulting from
the reliance by any person on the location shown on this map. Massachusetts
law requires that any person performing excavation work contact Dig-Safe so
that the location of any underground may be marked.

Address: 285 Clifford St

City/Town: New Bedford