

## APPLICATION/AGREEMENT

For Trench/Disturbance Permit within the City of New Bedford

Permit # 4104-2021

Dig Safe: 20213410666

Date: 8/26/2021

TO THE MAYOR AND CITY COUNCIL:

DISTURBANCE PERMIT/TRENCH SAFETY PERMIT

Permission is hereby requested to excavate the surface of: X City Property and/or X Private Property  
Provide SketchLocation of Work: 626 Church St. - CorrosionTarklin Hill Rd. - Brockton St.Relay Gas ServiceWork will begin (weather permitting) on: September 9, 2021Applicant Name: Kevin O'Sullivan (ra)

Excavator(s) Name: \_\_\_\_\_

Company Name: Eversource

Hoisting Equipment License Number: \_\_\_\_\_

Grade: \_\_\_\_\_ Expiration Date: \_\_\_\_\_

Contact Number: 508-441-5817

Name &amp; Contact Number of Insurer: \_\_\_\_\_

Competent Person on Work Site: ON FILEAPPROVED BY: Stephen Costa DATE: 10-19-2021TITLE: Asst. City Engineer

This permit shall be posted at the work site, and shall remain until the work is completed. It is subject to inspection at all times.

Permit only valid for three months  
from date of approvalTrenches must be maintained  
weekly until final paving is  
completedROADWAY CLOSURES WILL REQUIRE  
AUTHORIZATION FROM THE  
COMMISSIONER OF PUBLIC  
INFRASTRUCTURE. TRAFFIC MANAGEMENT  
PLANS MAY BE REQUIRED.

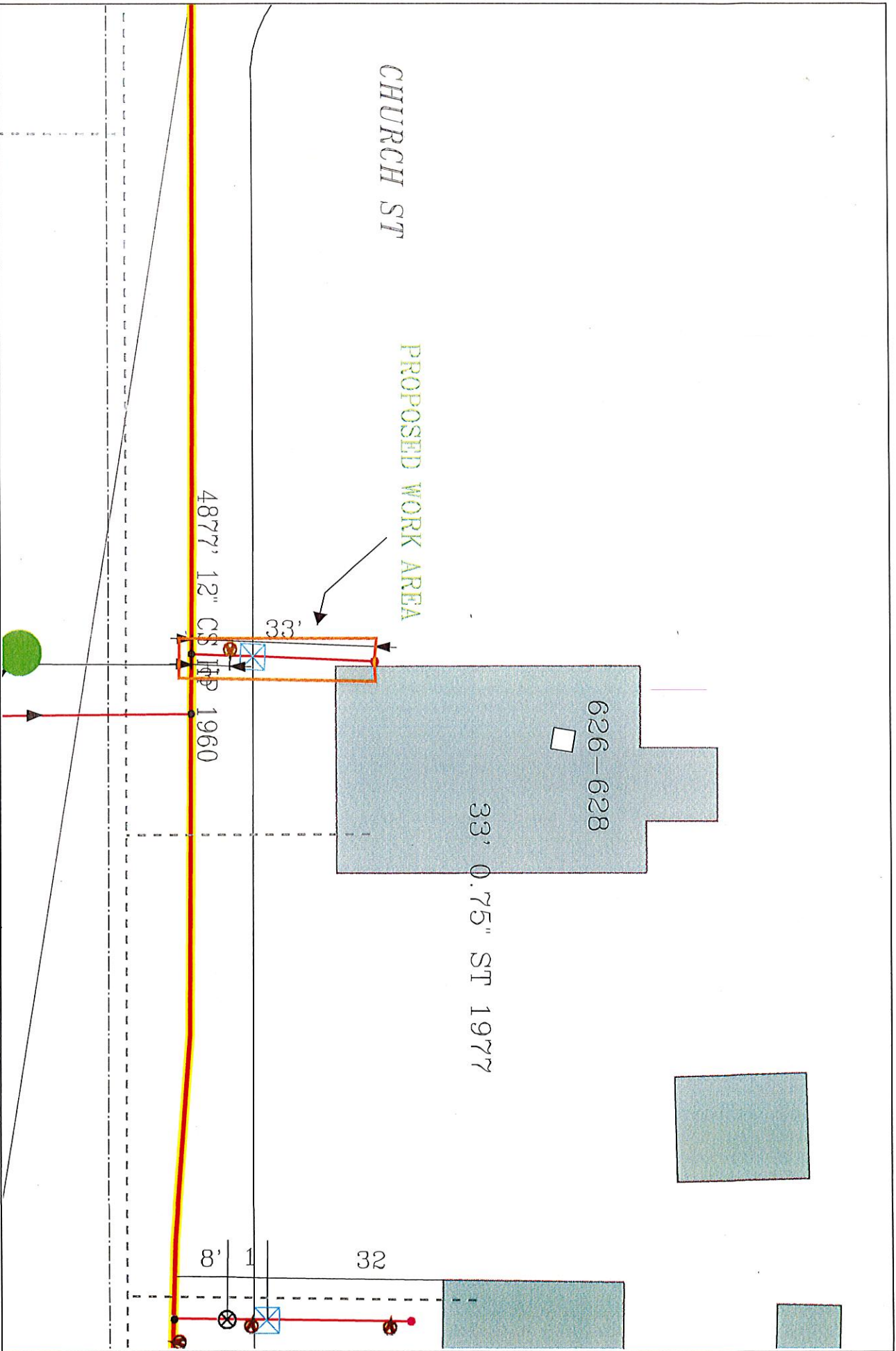

CHURCH ST

PROPOSED WORK AREA

626-628

33' 0.75" ST 1977

4877' 12" CS HP 1960

33'

32

8' 1'

**EVERSOURCE**

EVERSOURCE MA GAS  
One State St  
Boston, MA 02090  
Phone 1-800-592-2000

**MASS LAW**

Requires 72 hour advance notice of any excavation before digging by anyone

Call Dig-Safe: 811

**IMPORTANT - DO NOT SCALE**

This drawing provides approximate locations only and all facility information may not be shown. Contact EVERSOURCE MA GAS to have specific field information identified. EVERSOURCE MA GAS disclaims any liability resulting from the reliance by any person on the location shown on this map. Massachusetts law requires that any person performing excavation work contact Dig-Safe so that the location of any underground may be marked.

Address: 626-628 Church St WL

City/Town: New Bedford 3/10/2021