

APPLICATION/AGREEMENT

Permit # 406-2021

For Trench/Disturbance Permit within the City of New Bedford

Dig Safe: _____

Date: 9/13/2021

TO THE MAYOR AND CITY COUNCIL:

DISTURBANCE PERMIT/TRENCH SAFETY PERMIT

Permission is hereby requested to excavate the surface of: X City Property and/or X Private Property

Provide Sketch

Location of Work: 1025 Chaffee St. - Compliance Conversion

Ashley Blvd. - Acushnet Ave.

Relay Gas Service

Work will begin (weather permitting) on: September 27, 2021

Applicant Name: Kevin O'Sullivan (ra) Excavator(s) Name: _____

Company Name: Eversource Hoisting Equipment License Number: _____

Grade: _____ Expiration Date: _____

Contact Number: 508-441-5817 Name & Contact Number of Insurer: _____

Competent Person on Work Site: ON FILE APPROVED BY: Stephen Caputo DATE: 9-21-2021

TITLE: Asst. City Engineer

This permit shall be posted at the work site, and shall remain until the work is completed. It is subject to inspection at all times.

Permit only valid for three months
from date of approval

ROADWAY CLOSURES WILL REQUIRE
AUTHORIZATION FROM THE
COMMISSIONER OF PUBLIC
INFRASTRUCTURE. TRAFFIC MANAGEMENT
PLANS MAY BE REQUIRED.

Trenches must be maintained
weekly until final paving is
completed

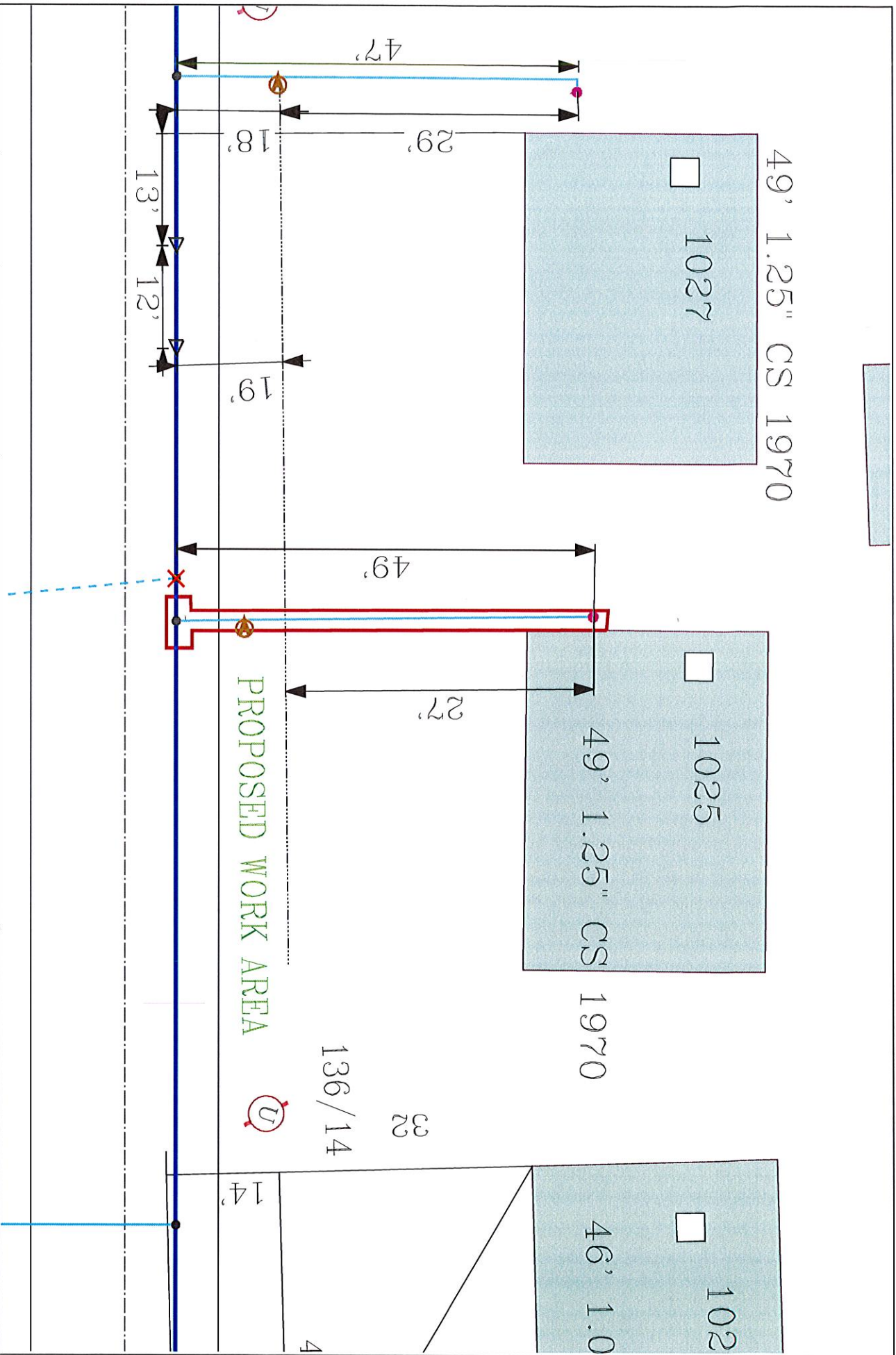

EVERSOURCE

EVERSOURCE MA GAS
One NSTAR Way
Bedford, MA 02090
Phone 1-800-592-5000



MASS LAW

Regulates 72 hour advance
notice to utility companies
before digging by anyone

Call Dig-Safe: 811

IMPORTANT - DO NOT SCALE

This drawing provides approximate locations only and all facility information may not be shown. Contact EVERSOURCE MA GAS to have specific field information identified. EVERSOURCE MA GAS disclaims any liability resulting from the reliance by any person on the location shown on this map. Massachusetts law requires that any person performing excavation work contact Dig-Safe so that the location of any underground may be marked.

Address: 1025 Chaffee St

City/Town: New Bedford